

Double Panel Bathscreen

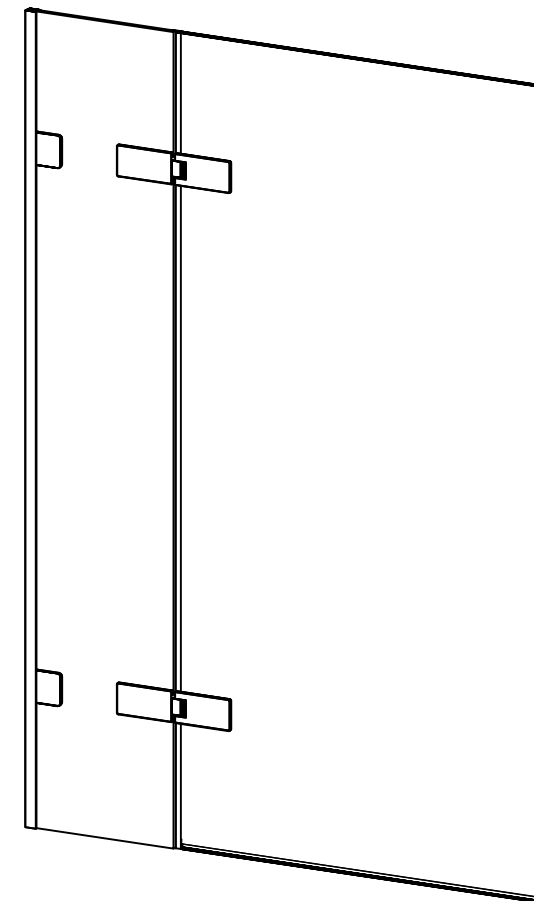

INSTALLATION GUIDE

www.merlynshowering.com

CE	
Merlyn Industries Ltd (MER01)	
20	
EN 14428	
Declaration of performance number CEARH1.2	
Shower enclosures with aluminium profiles and safety glass	
Cleanability	: Pass
Impact resistance/ shatter properties	: Pass
Durability	: Pass

MERLYN

Merlyn Showering
Unit 8, Purcellsinch Industrial Park,
Dublin Road, Kilkenny, Ireland.
Tel: 00353 56 779 1555
Fax: 00353 56 779 1576
www.merlynshowering.com

To download the Declaration of Performance (DOP) for
this product please use the link below.
<https://merlynshowering.com/aftersales-support/dop-certs/>

IMPORTANT: Please read the complete instructions before commencing fitting.

Make sure the tray is 100% level in all directions.
Check that you have the tools required.□
Check the installation site is compatible with the sizes of door supplied.□
Check all the enclosure components are present.□
Check the installation kit is complete.□
Do Not attempt to install the product unless you can tick all 4 boxes satisfactory.
The wall plugs supplied with the Installation kit are for use in solid walls. Hollow or 'stud partition' walls will require alternative fixings. Please consult a hardware supplier for the correct type.

ATTENTION: TAKE EXTREME CARE WHEN HANDLING GLASS, WEAR PROTECTIVE EYEWEAR AND CLOTHING. DO NOT LEAVE THE GLASS ON HARD SURFACES AND AVOID CONTACT BETWEEN THE GLASS EDGES AND HARD SURFACES OR IMPACTS DURING THE INSTALLATION.

Fixing kit components

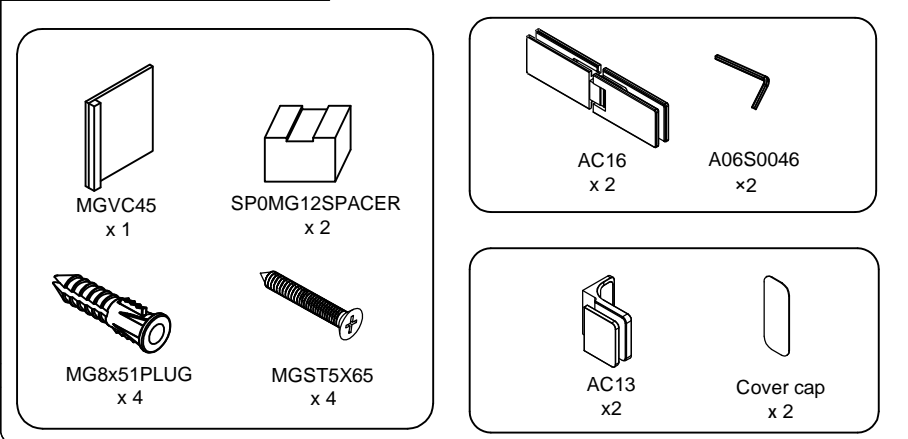

Tools required

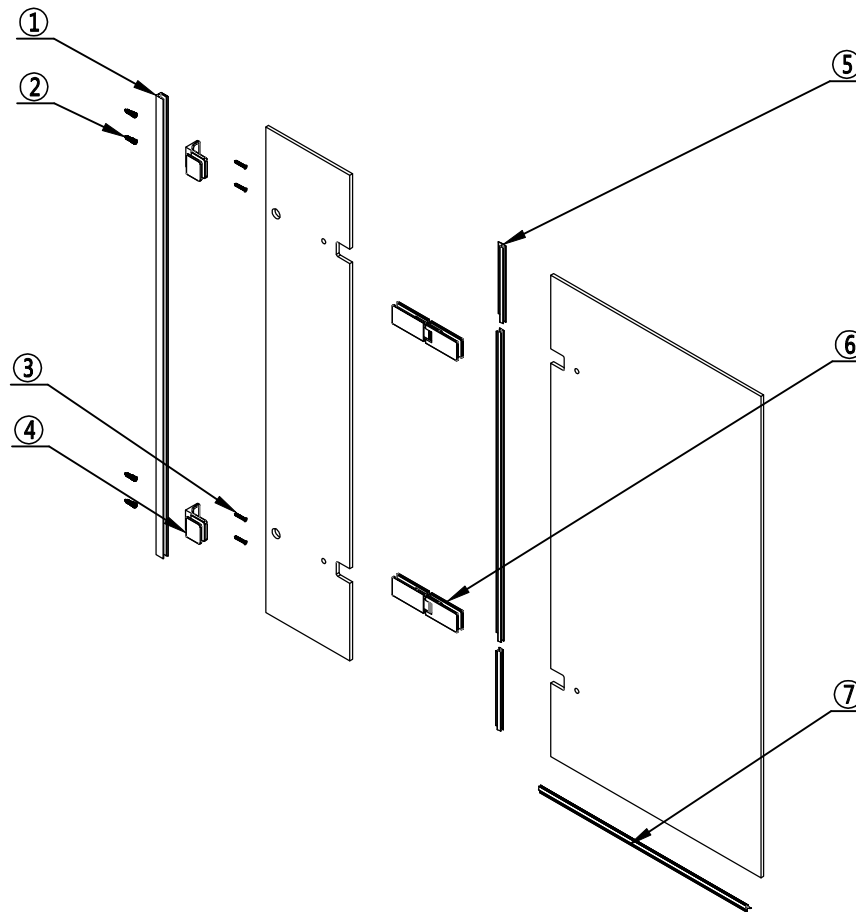
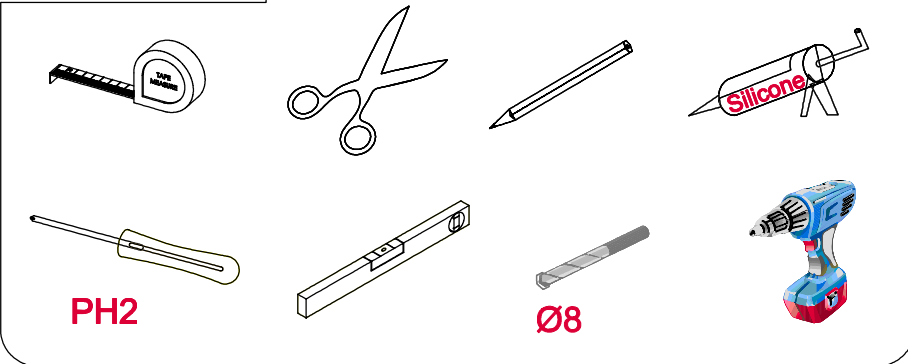

No.	QTY	Descriptions	Part No.	No.	QTY	Descriptions	Part No.
①	1	Wall profile	AC01	⑤	1	upright water seal for the hinge	MGDBSU
②	4	Wall plug 8x51	MG8x51PLUG	⑥	2	Hinge	AC16
③	4	Screw 5x65	MGST5X65	⑦	1	Bathscreen bottom seal	MGLC8367
④	2	Wall bracket	AC13				

Step 1

IMPORTANT!

To create a good seal make sure the bath is 100% level before fitting.

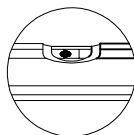
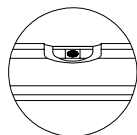
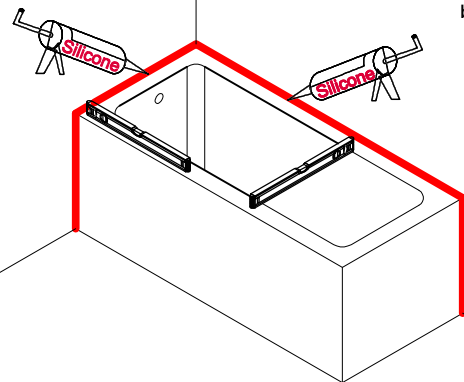

Step 2

The side of the panel with the holes is the side fitted against the wall.

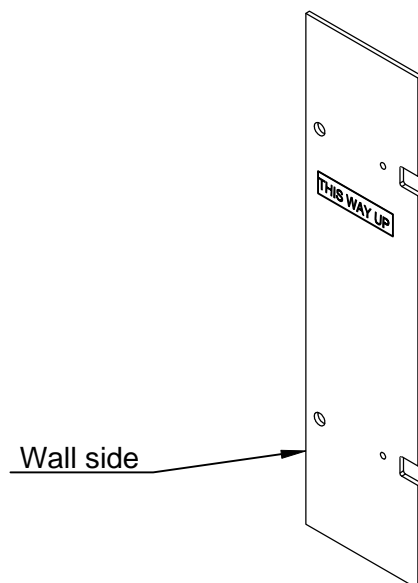

3

Step 3

Push on wall profile completely ensuring end is flush with the top of the glass panel.

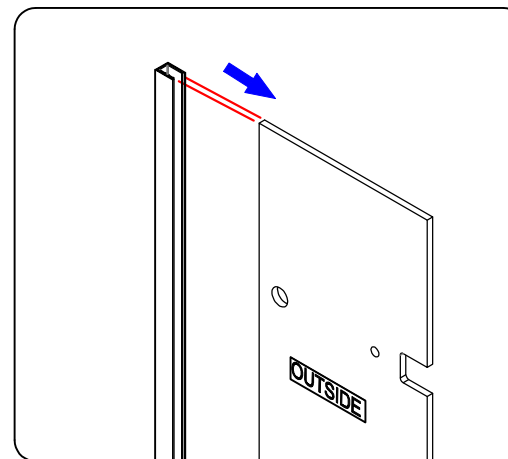

Step 4

Fix wall brackets loosely ensuring fixing holes are to the inside of glass panel.

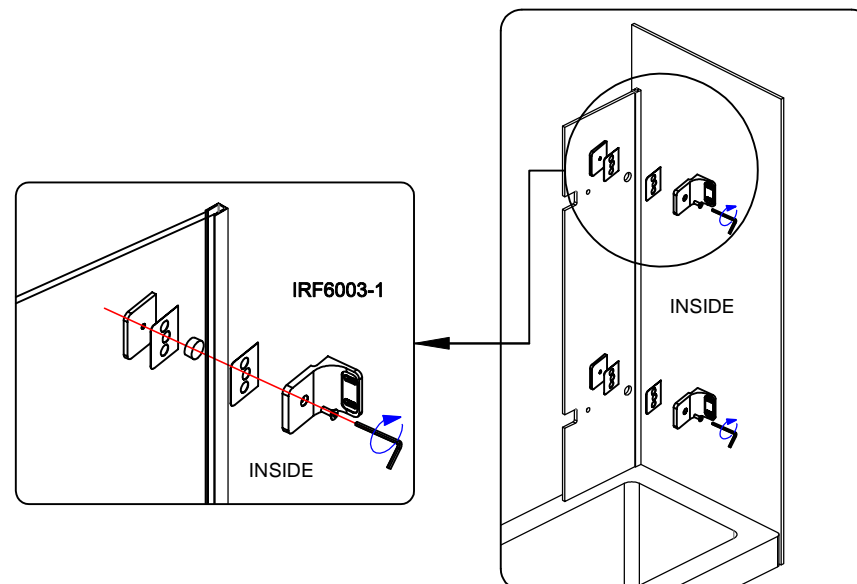

4

Step 5

Position the fixed panel so that the inside edge sits on the bath as shown below. Make sure the panel is plumb then mark wall through slots.

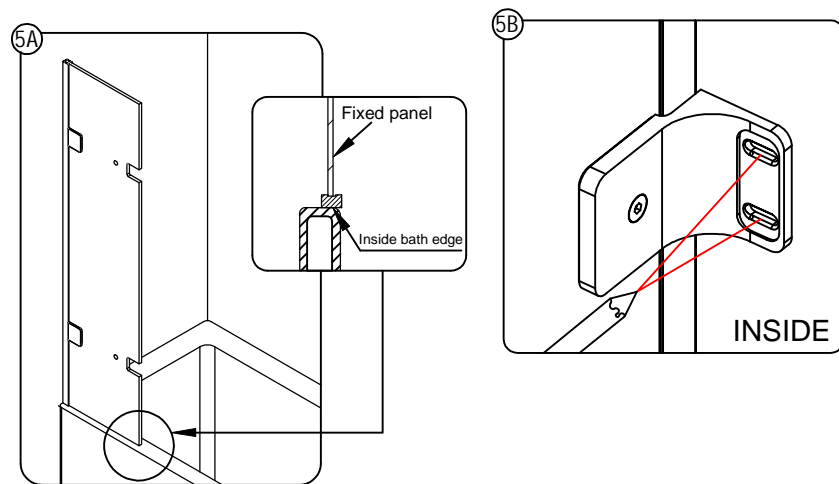

Step 6

Remove the bath panel and drill with 8mm bit. Insert wall plugs.

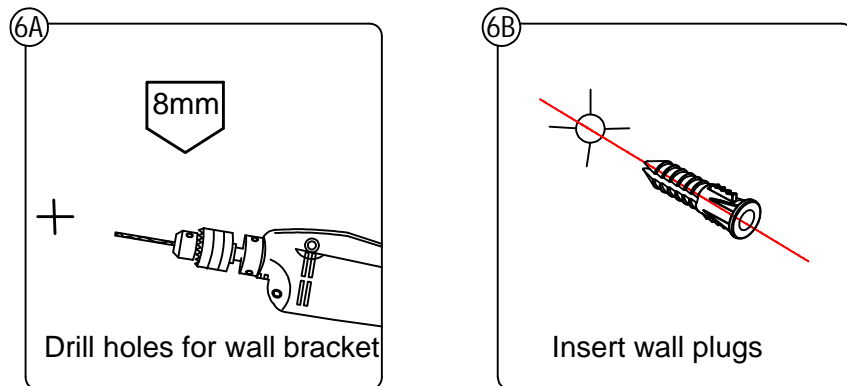

Step 7 Fix wall brackets to the wall.

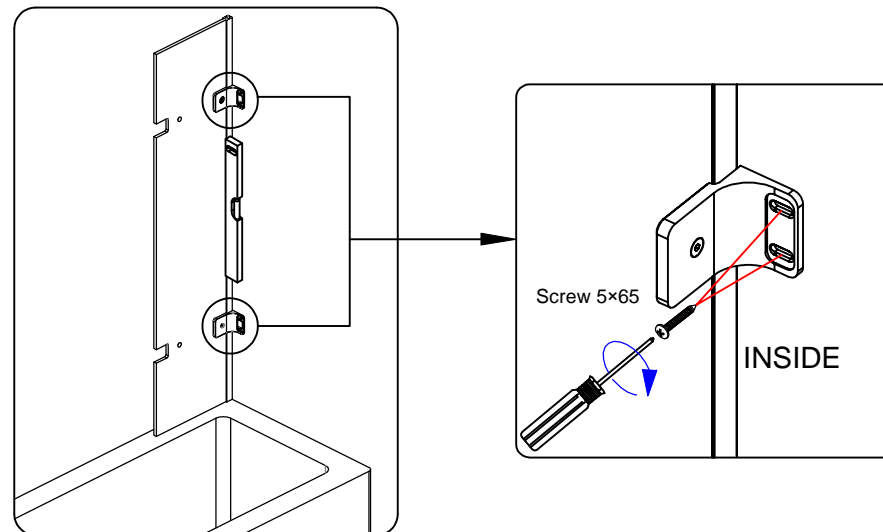

Step 8

Place spacers on the bath top.

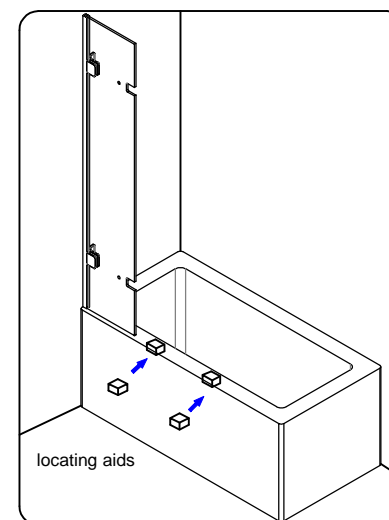

Step 9

Keep label 'OUTSIDE' to the outside.
Place panel on the spacers lining up the cutouts in the fixed and moving panels. Fit hinges ensuring that the part of the hinge which has a cut out is fitted to the moving panel.

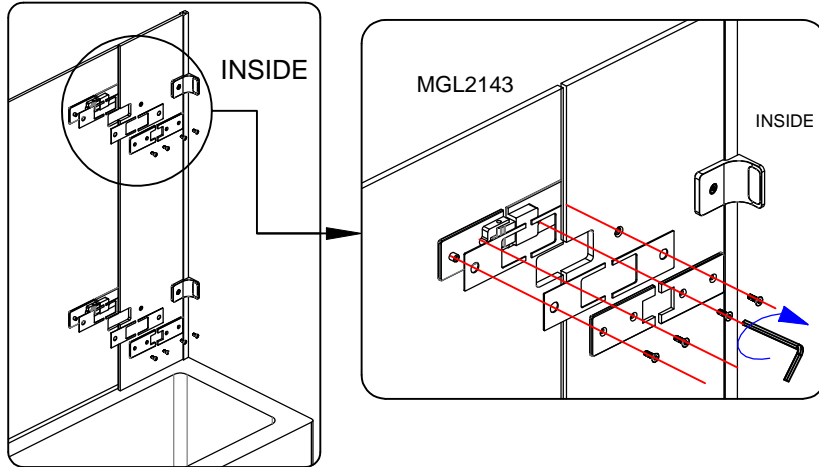

Step 10

The side of the hinge that has the fixing bolts must be to the inside of the moving panel. Hinge should be fitted in centre of cutout for maximum adjustment later. Fully tighten bolts.

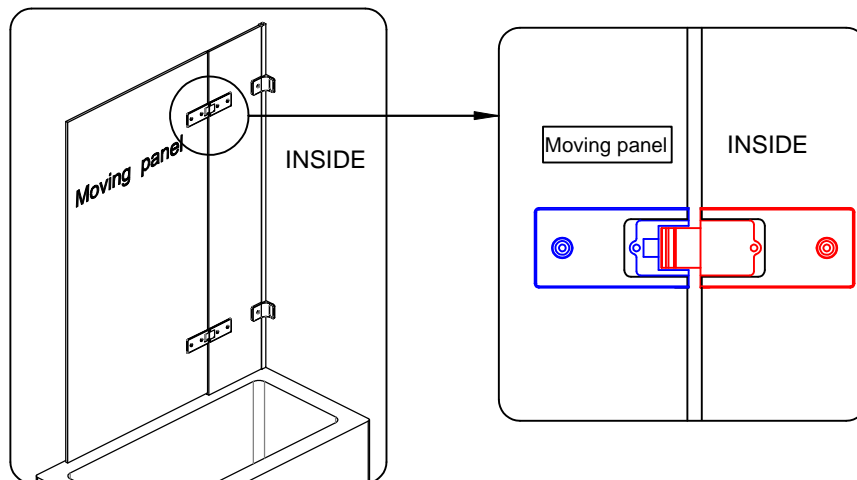

Step 11

Loosely fix back plates to hinges ensuring washers are in position and hinges are level.

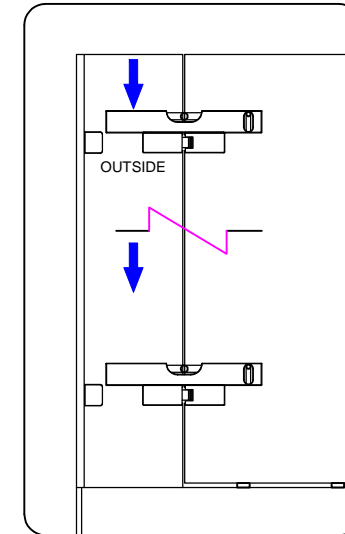

Step 12

Ensure gap is equal top and bottom, then fully tighten hinge bolts.

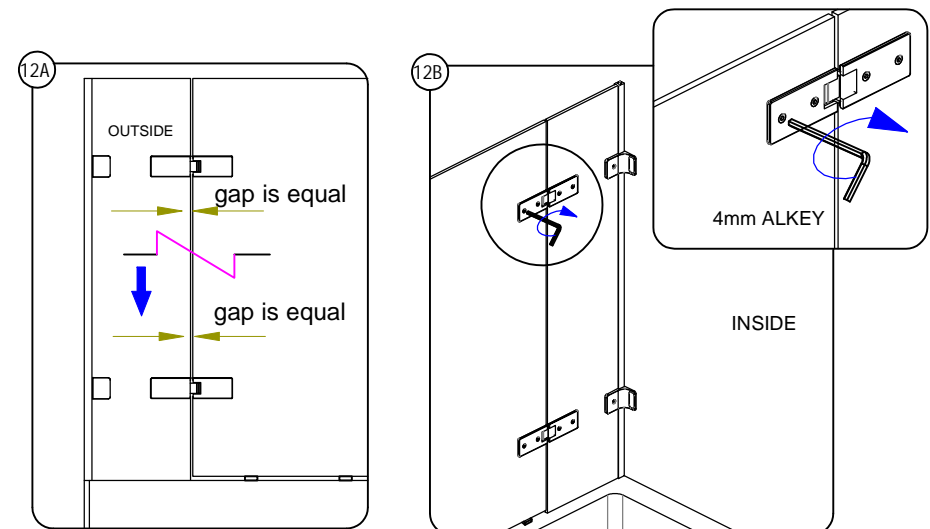

Step 13

Remove spacers and check gap under moving panel is equal. If gap is not equal loosen hinges slightly and adjust. Use packer to check gap is correct height and even.

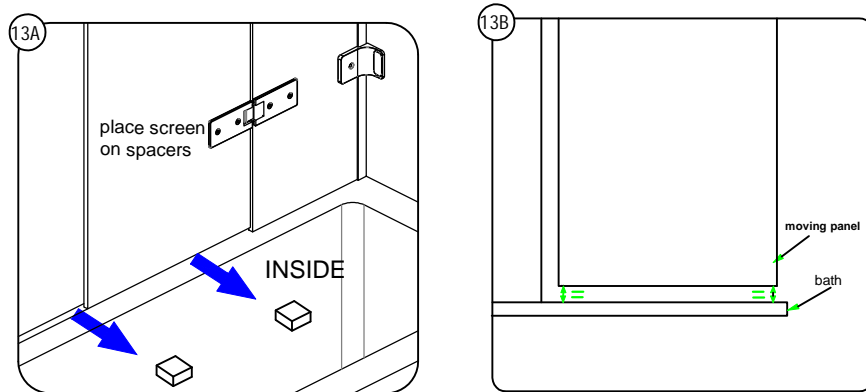

Step 14

Fit bottom seal keeping longest fin to inside.

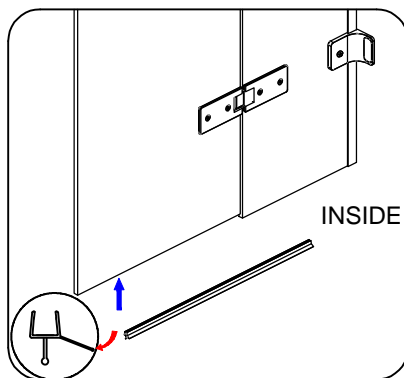

Step 15

Push on longest seal between hinges onto back edge of moving panel. Take longer seal and fit to top keeping notch to hinge. Repeat with shortest bottom seal.

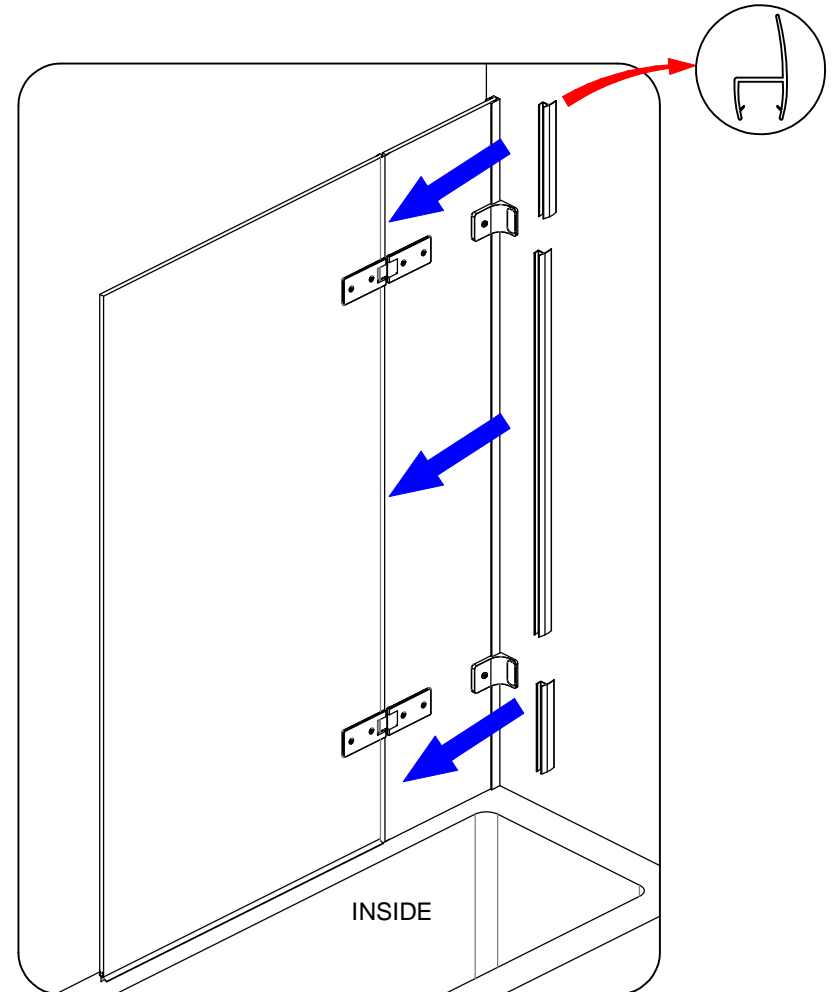

Step 16

Seal bath screen to outside along vertical edge where profile meets the wall.
Seal outside along bottom of fixed panel.

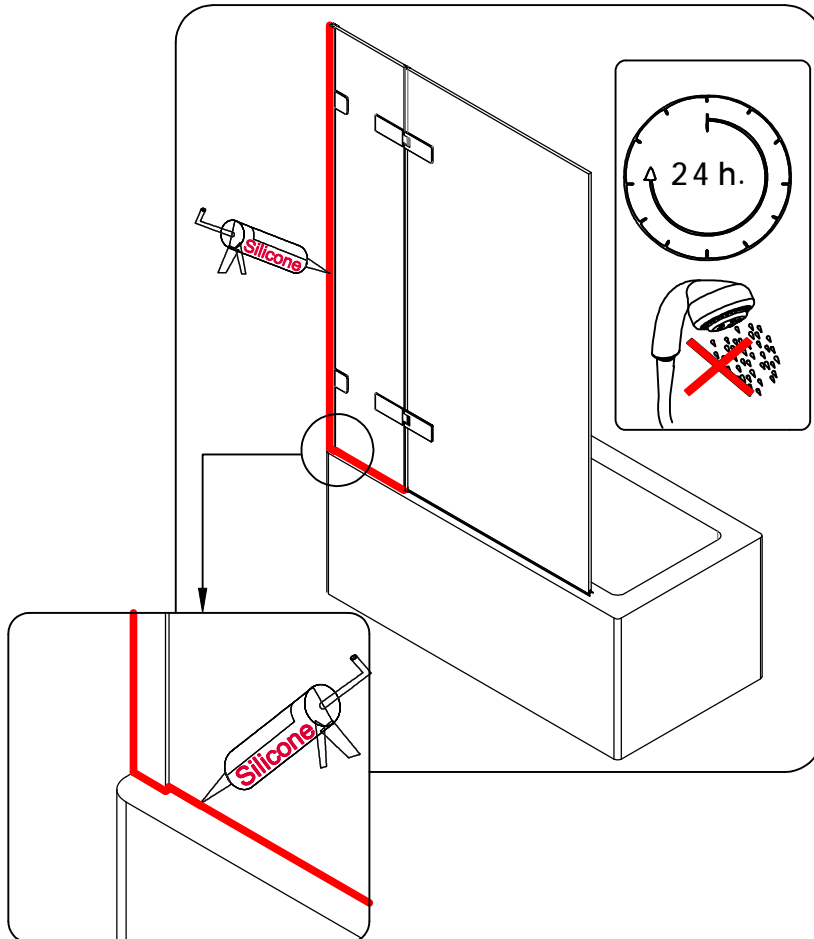

CE

Merlyn Industries Ltd (MER01)

20

EN 14428

Declaration of performance number
CEARH1.2

Shower enclosures with aluminium
profiles and safety glass

Cleanability : Pass

Impact resistance/
shatter properties : Pass

Durability : Pass