

Shower Panel & Hinged Swivel Panel

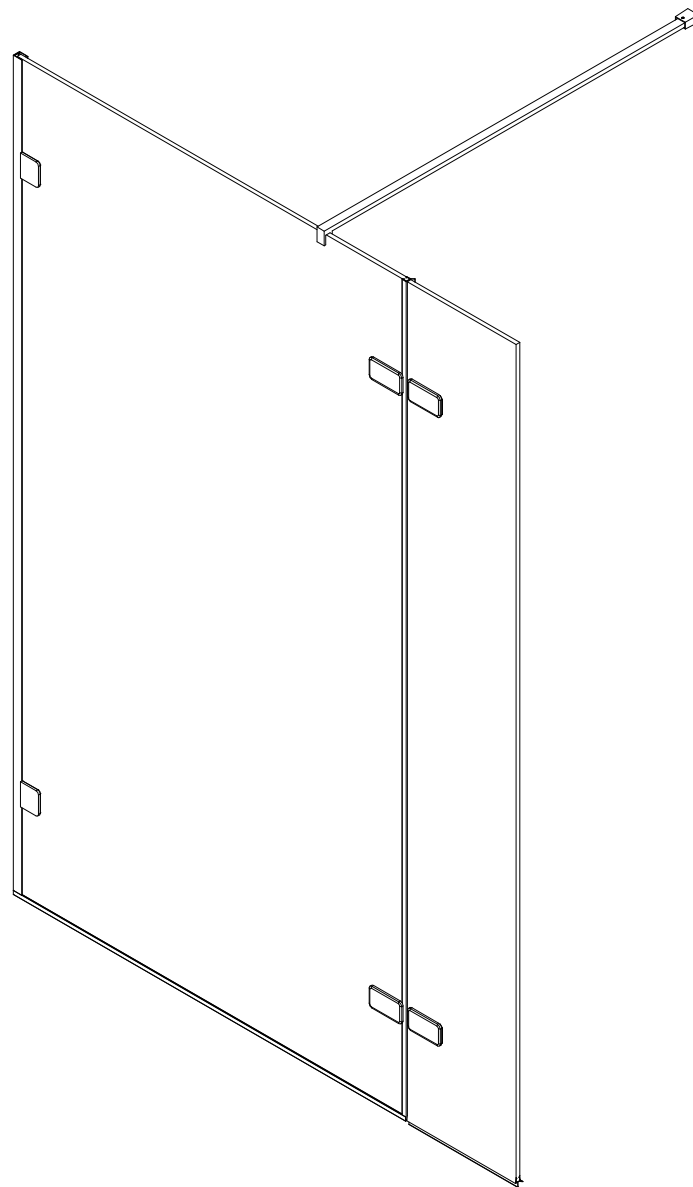

INSTALLATION GUIDE

IMPORTANT: Please read the complete instructions before commencing fitting.

Make sure the tray is 100% level in all directions.

Check that you have the tools required. ☐

Check the installation site is compatible with the sizes of door supplied. ☐

Check all the enclosure components are present. ☐

Check the installation kit is complete. ☐

Do Not attempt to install the product unless you can tick all 4 boxes satisfactory.

The wall plugs supplied with the installation kit are for use in solid walls. Hollow or 'stud partition' walls will require alternative fixings. Please consult a hardware supplier for the correct type.

ATTENTION: TAKE EXTREME CARE WHEN HANDLING GLASS, WEAR PROTECTIVE EYEWEAR AND CLOTHING. DO NOT LEAVE THE GLASS ON HARD SURFACES AND AVOID CONTACT BETWEEN THE GLASS EDGES AND HARD SURFACES OR IMPACTS DURING THE INSTALLATION.

Fixing kit components

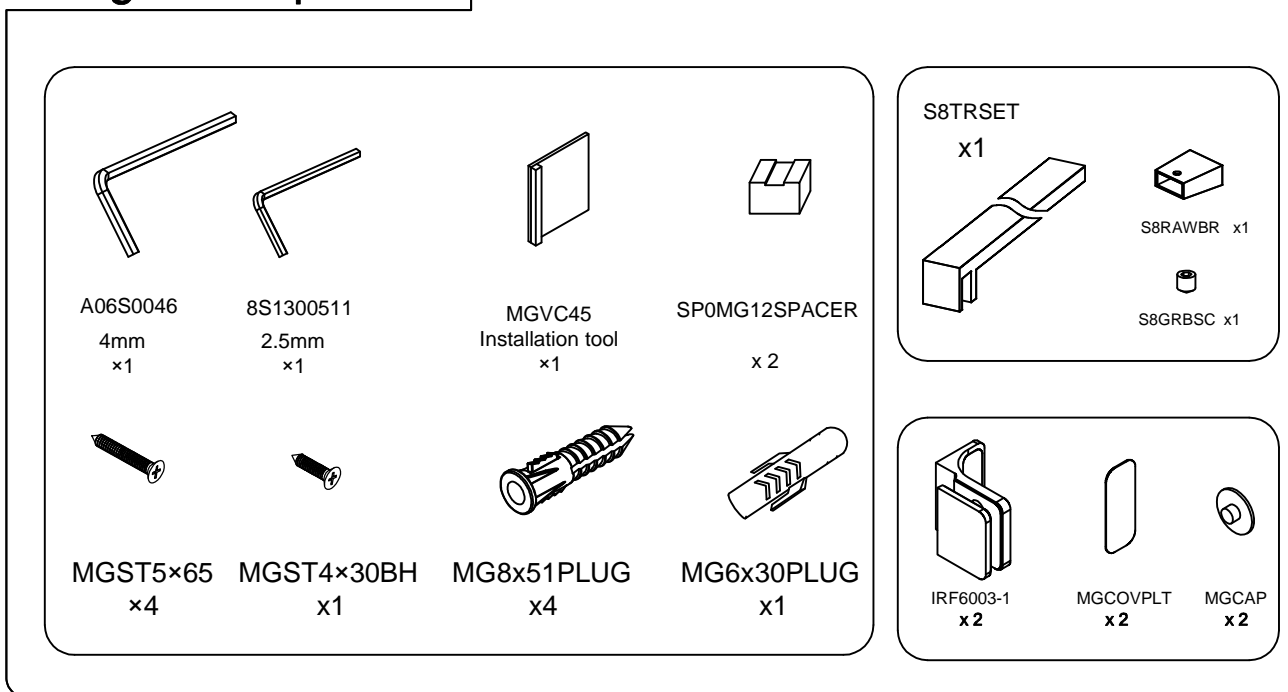

Tools required

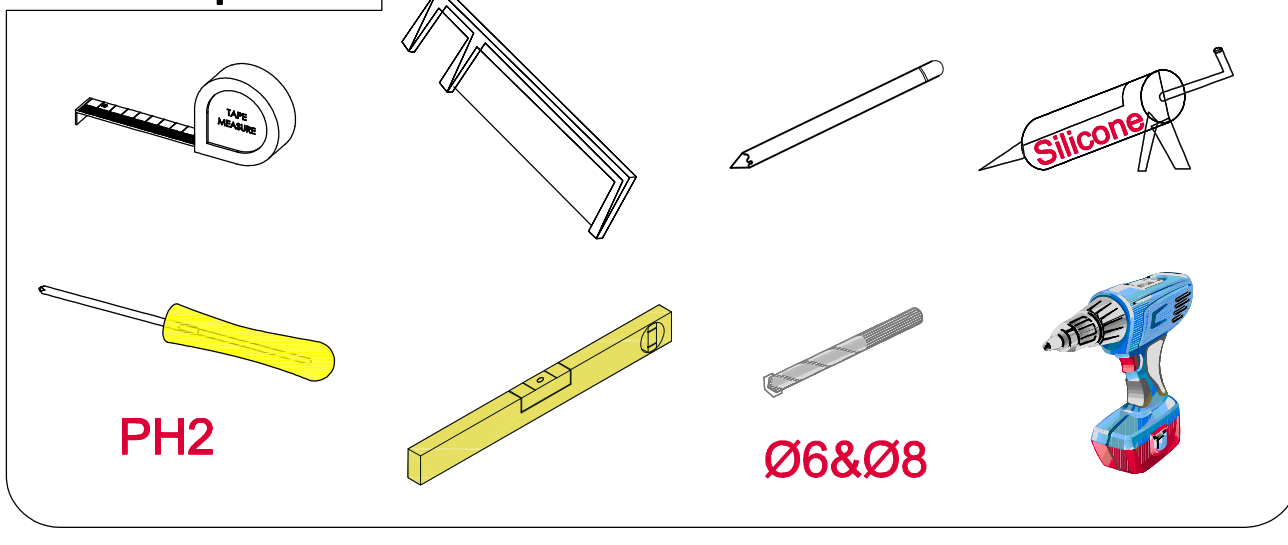

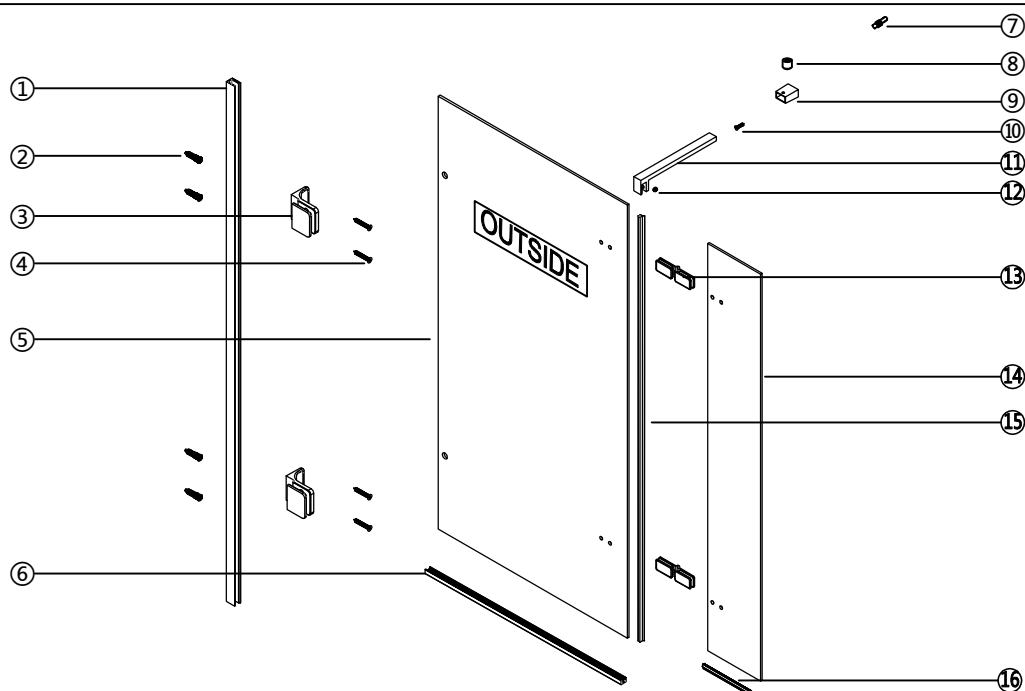

No.	QTY	Descriptions	Part No.	No.	QTY	Descriptions	Part No.
①	1	Wall profile	MGVCWPSET	⑨	1	Wall bracket	S8RAWBR
②	4	Wall plug 8x51	MG8x51PLUG	⑩	1	Screw 4x30	MGST4x30BH
③	2	Wall bracket	IRF6003-1	⑪	1	Support rail	S8TRSET
④	4	Screw 5x65	MGST5X65	⑫	1	Grubscrew	M8x6GNLT
⑤	1	Shower wall panel	GMGHSW	⑬	1	Hinge	S8TRSET
⑥	1	Bottom profile	MGVC35	⑭	1	Swivel Glass Panel	GWE300
⑦	1	Wall plug 6x30	MG6x30PLUG	⑮	1	Vertical seal	MGSEAL10
⑧	1	Grubscrew	S8GRBSC	⑯	1	Bottom seal	MGVC30A

Step 1

IMPORTANT!

Whether fitting on a tray or on a tiled Wetroom the tray or floor must be 100% level !

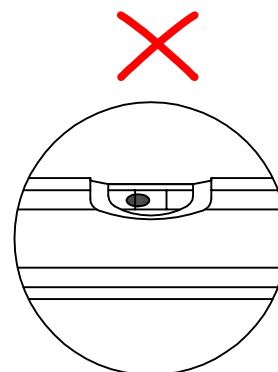
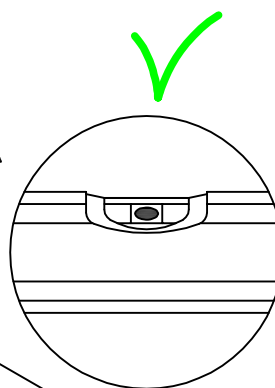
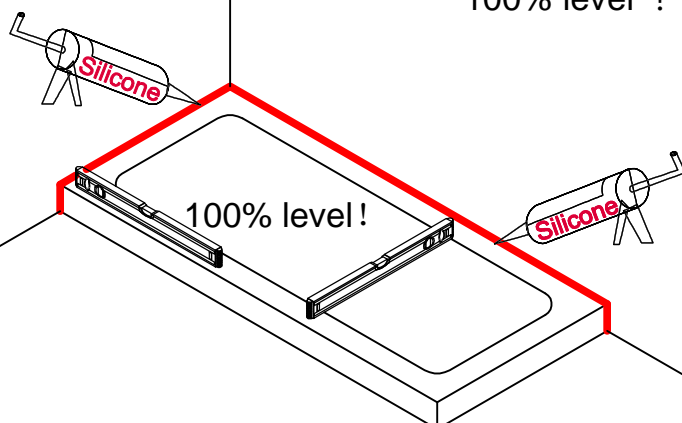

Step 2 Option A. Fitting in wet room

If fitting in a wet room determine the position of the outside edge of glass panel and measure in 40mm and mark.

Note the position of the labels on the wall profile. Make sure Label 'T' is to the top and 'B' is to the bottom. Line up the outside edge of the profile with the mark and plumb vertical. Mark the wall through the pre-drilled holes. Max distance from the wall to the outside of the glass is 1020mm.

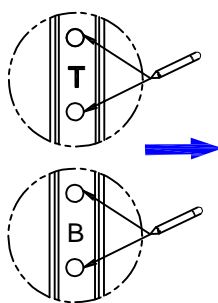
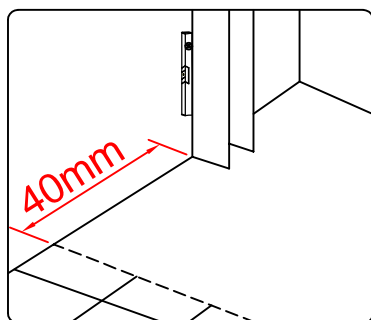
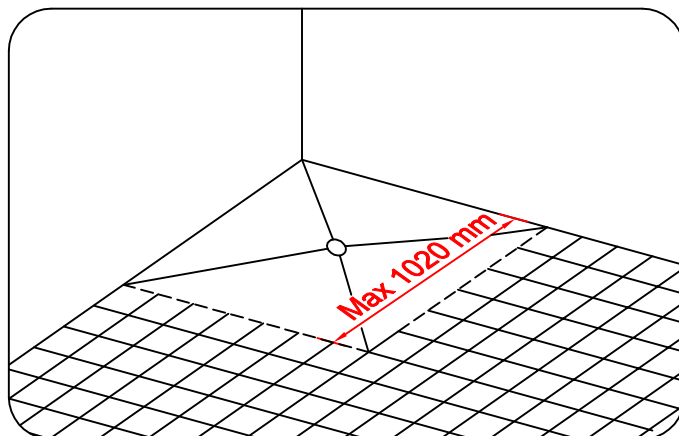

Do not fix the profile to the wall!

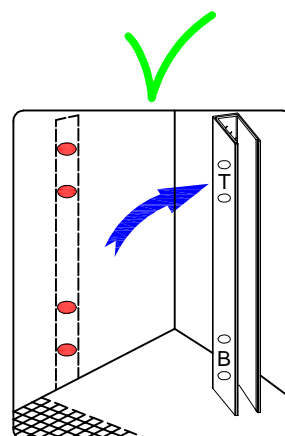
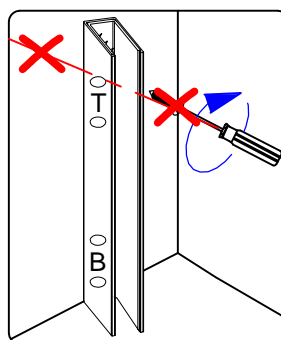

Important* The glass panel must be installed on a level surface. Be sure to position the panel beyond the gradient of your wet room.

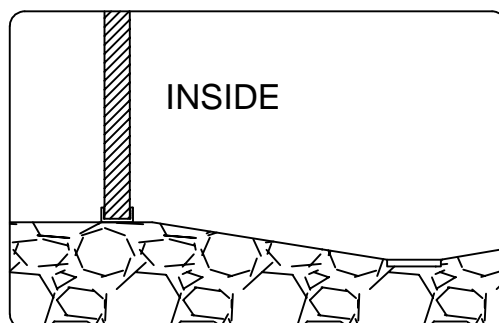

Step 2 Option B. Fitting on tray

Mark 60 mm in from the edge of the tray.

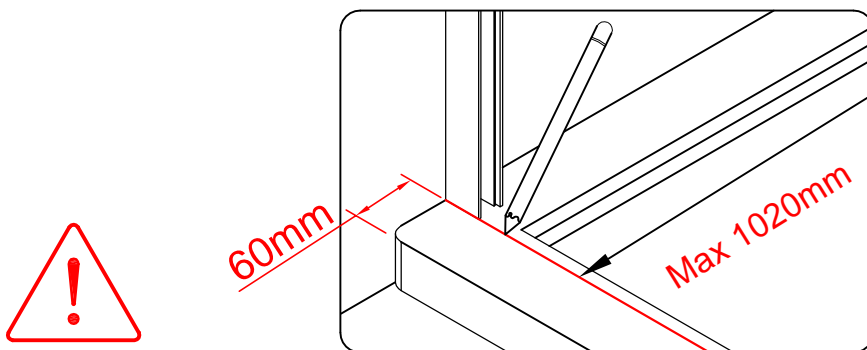

Note the position of the labels on the wall profile. Make sure Label 'T' is to the top and 'B' is to the bottom. Line up the outside edge of the profile with the mark and plumb vertical. Mark the wall through the pre-drilled holes. Max distance from the wall to the outside of the glass is 1020mm.

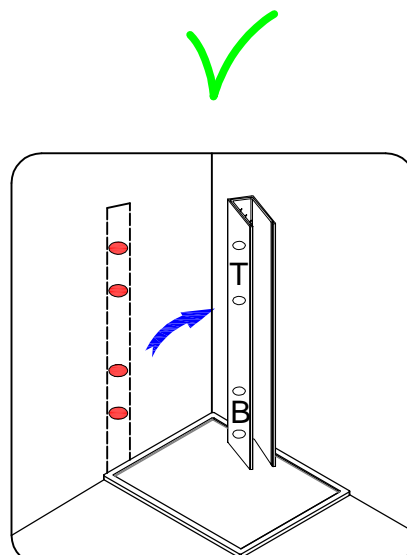
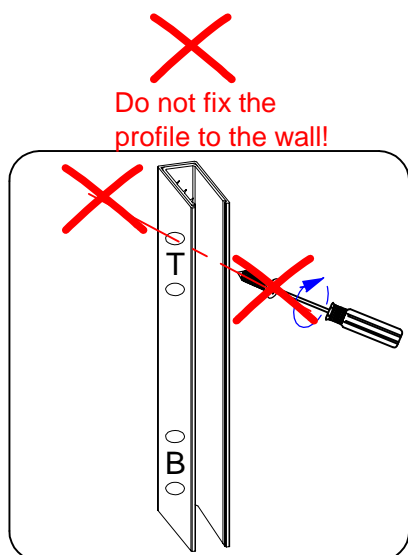
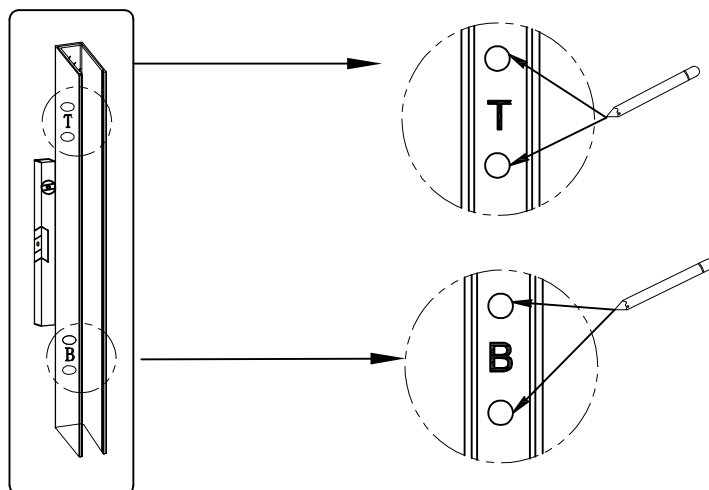

Step3

Remove profile and drill holes for wall brackets with diameter 8mm masonry bit and insert wall plugs. Ensure wall plugs are flush with tile.

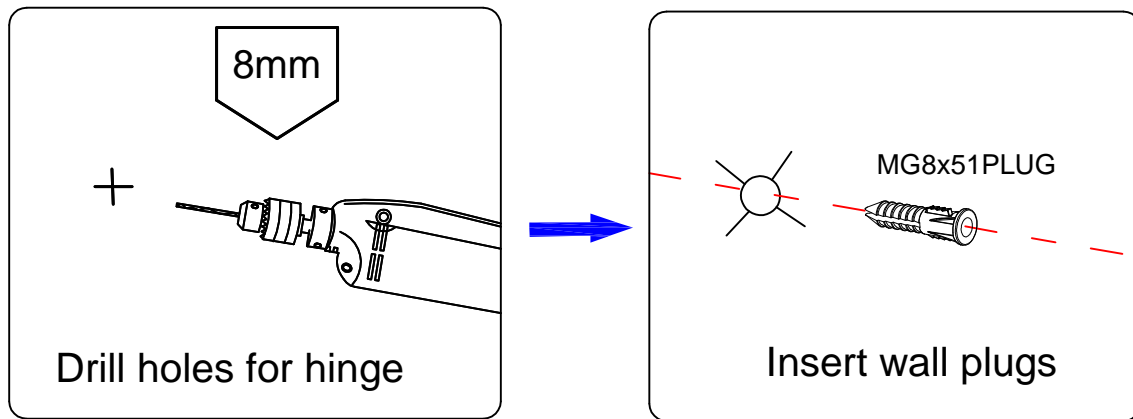

Step 4

Place bottom channel tight to wall offset in 15mm from front edge of the tray

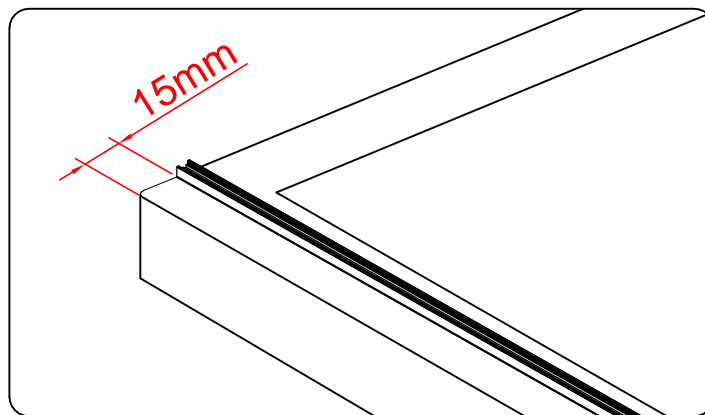

Place bottom track on tray

Step 5

Note which side is labeled OUTSIDE. The side of the panel with the holes is the side fitted against the wall.

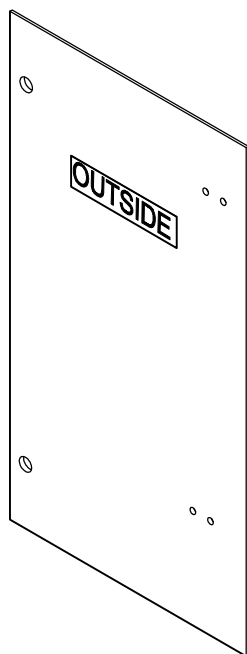

Step 6

Push on wall profile completely ensuring end is flush with the top of the glass panel

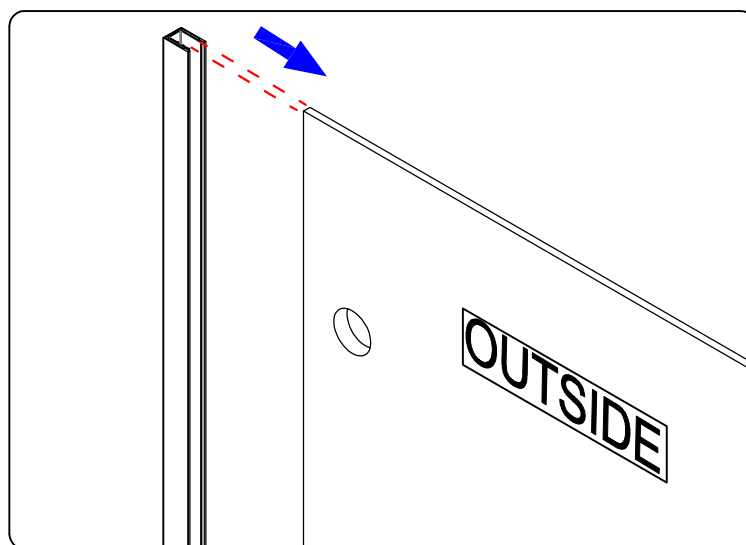

Step 7

Fix both wall brackets, do not over tighten.

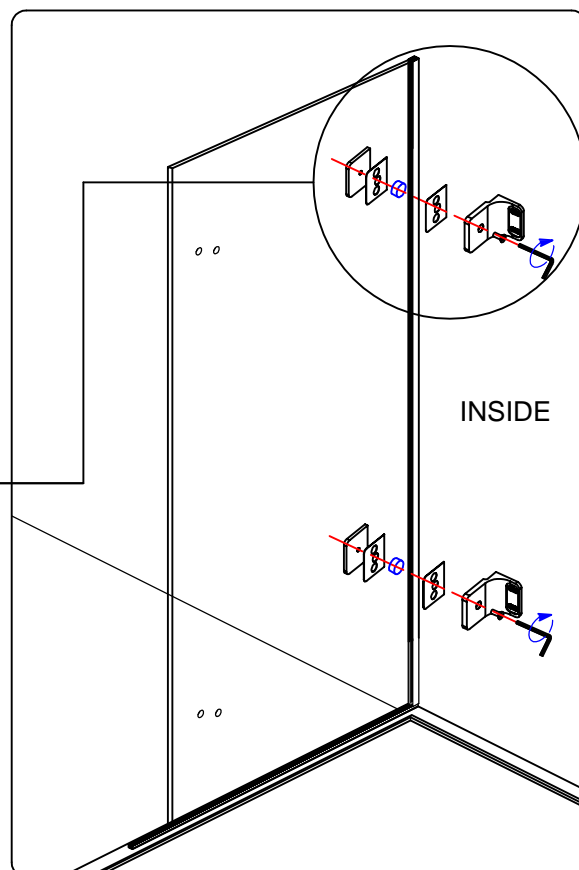
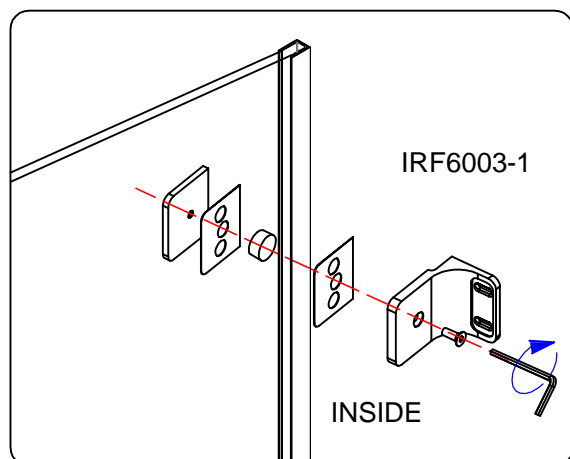

Step 8

Place assembled panel into bottom profile and place tight against wall

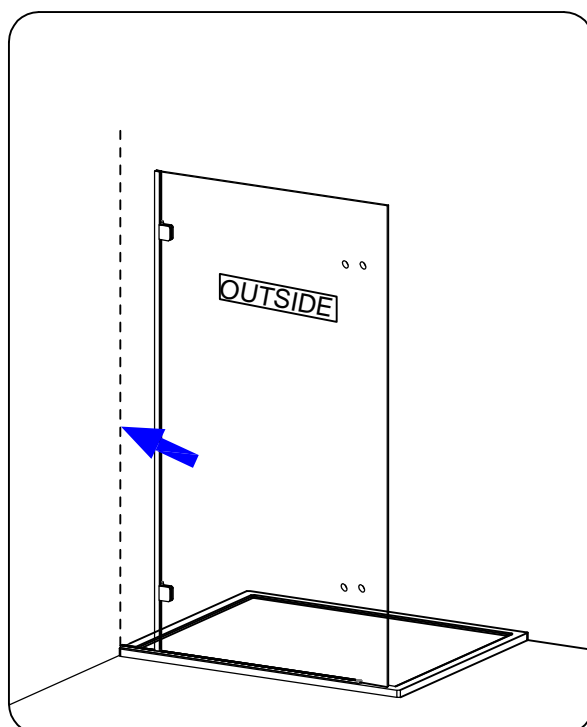

Step 9

Fix wall brackets to the wall.

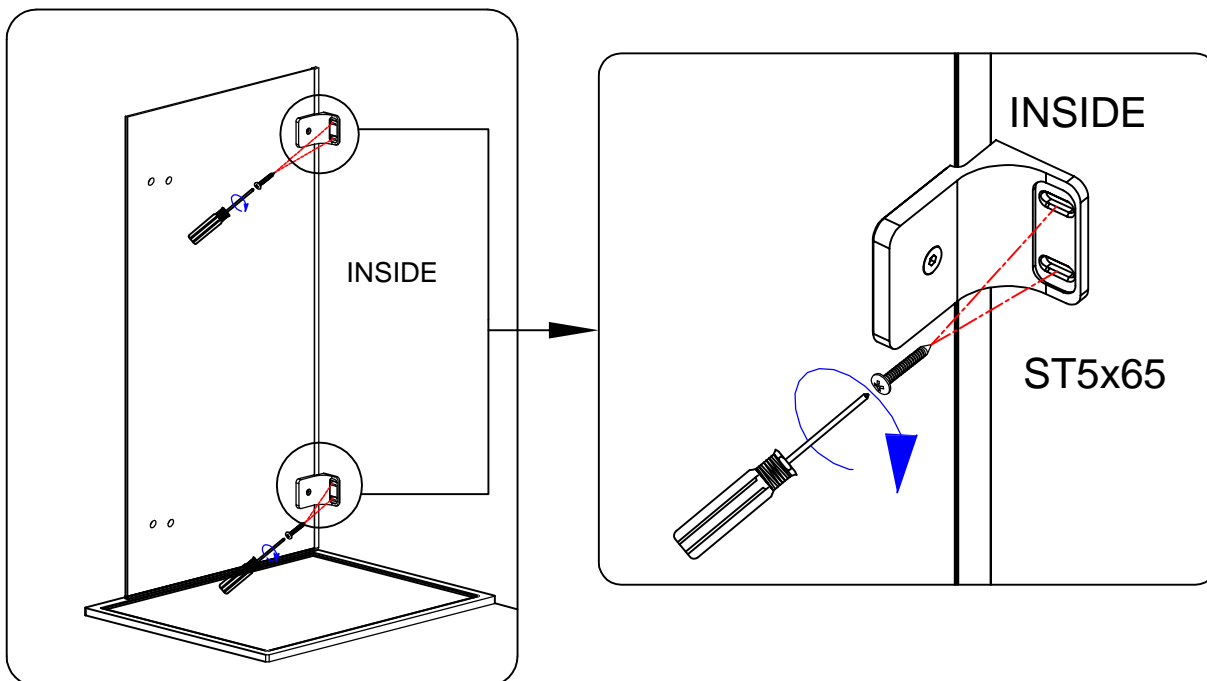

Step 10

Use timber tool provided and gently tap the wall profile tap the wall profile top to bottom on the inside and outside until it is tight to the wall.

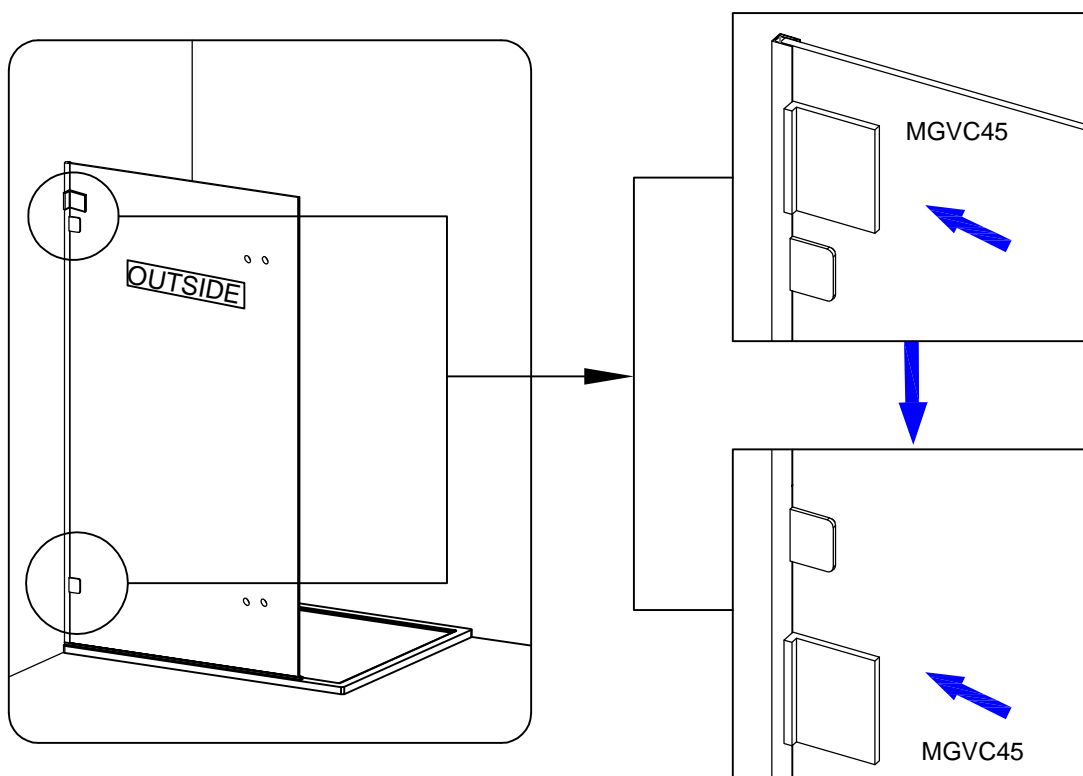

Step 11

11A. Measure distance A from wall to outside edge of glass panel. Subtract 11 mm from Distance A to give you distance B. The subtraction of 11mm is to allow for the depth of your vertical seal.

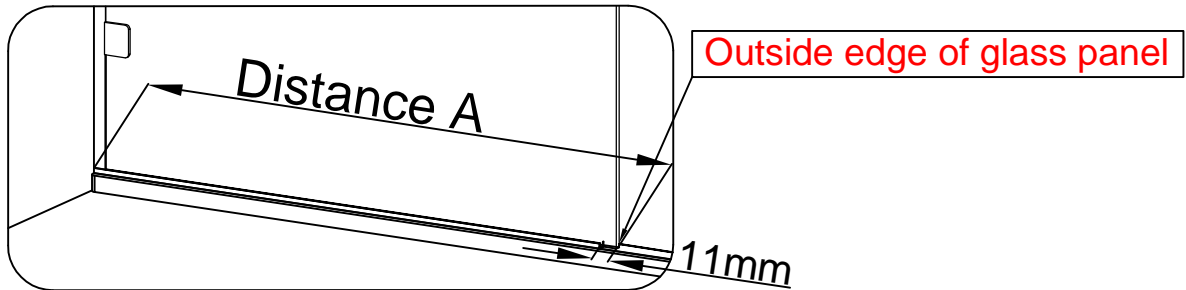

11B. Remove entire panel and bracket assembly and cut bottom profile to distance B.

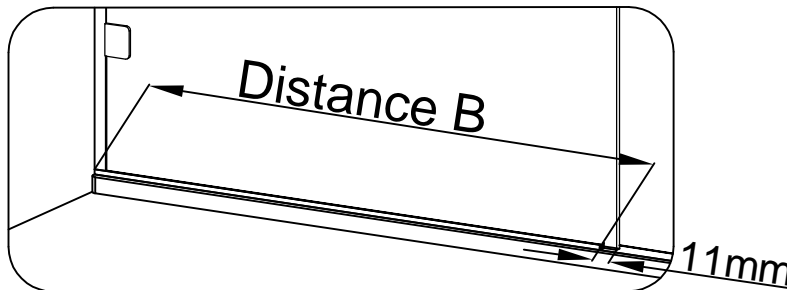

Step 12

Reposition bottom profile and fit fixed panel. Repeat 8-10 ensuring all fixings are securely tightened. Adjust fixings A&B to plumb panel.

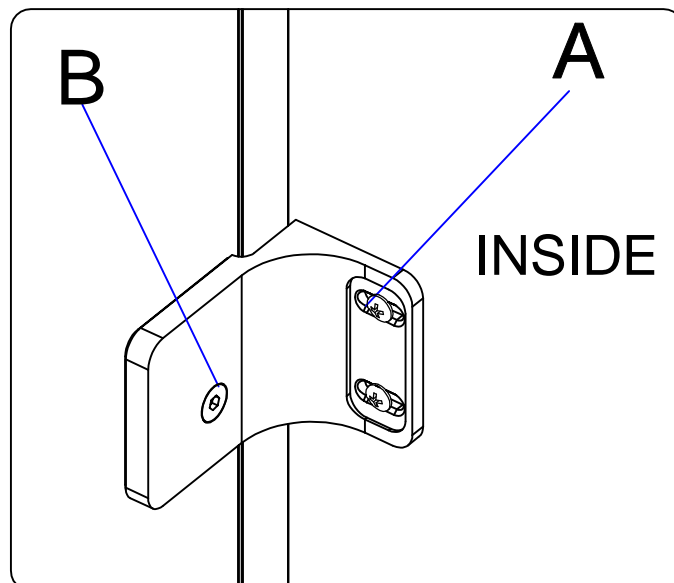

Step 13

Fitting cover caps. Peel off protective strip to adhesive tape to back of cap and firmly press in position .

Tip : We recommend that you place a dab of silicone to the back of the cover caps at each end of the tape.

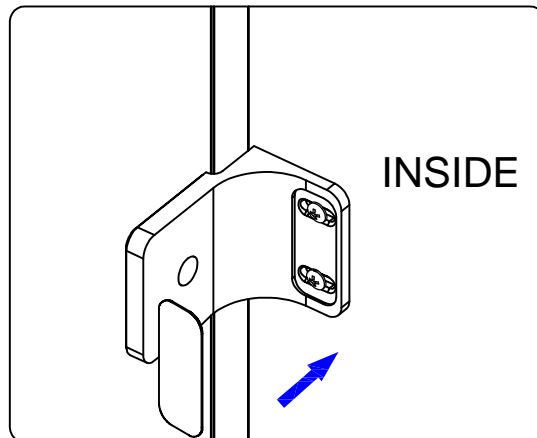

Step 14

14A. Fit upright seal making sure to keep angled fin to the inside.

14B. Fit the hinge and keep the washer with side labeled seal side is fitted to the fixed panel and closest to the upright seal.

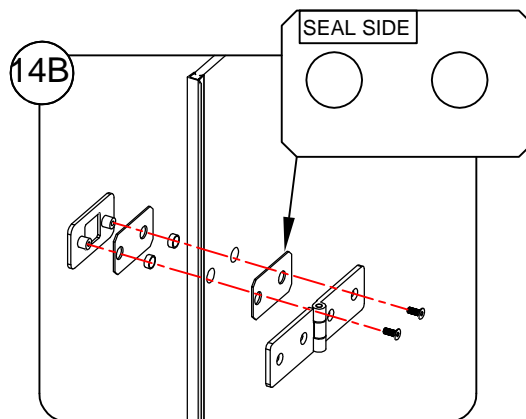
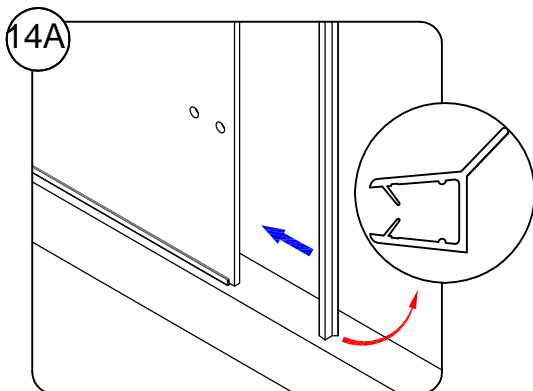

Make sure to use the correct washer with holes offset to the one side.

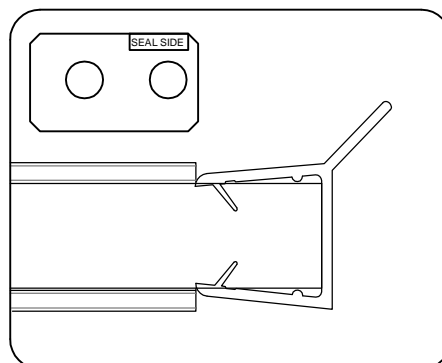
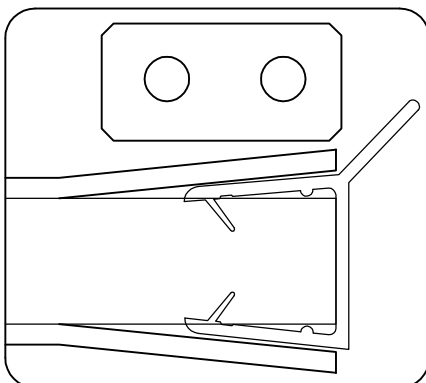

Step 15

15A: Use the 13mm spacers provided with the fixing kit to align your moving panel with the hinge position on the fixed panel as shown below.

15B: Loosely fix your back plates to hinges ensuring washers are in position and hinges are level.

15C: Ensure that there is an equal 3mm gap between top and bottom panels.

15D: Fully tighten screws.

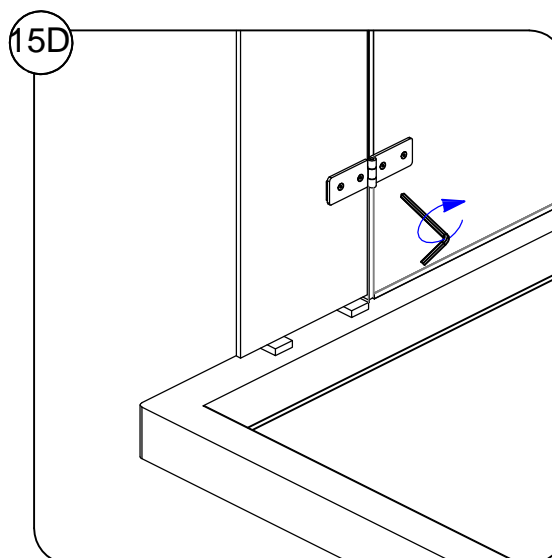
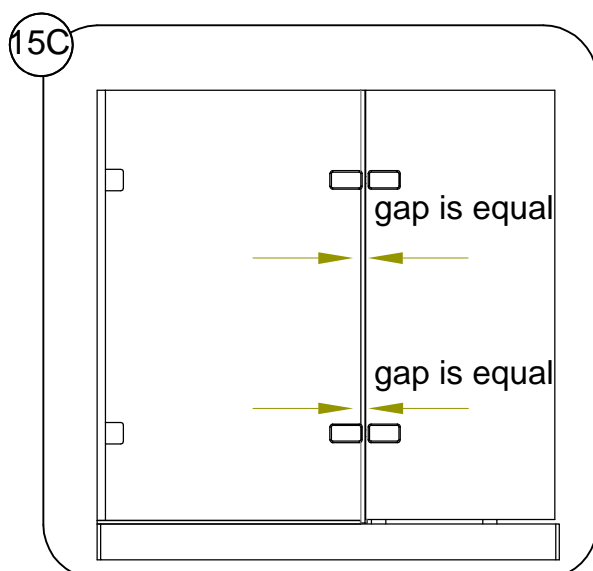
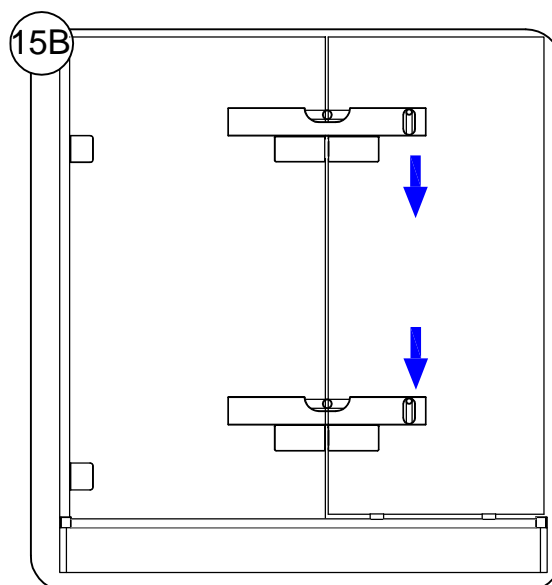
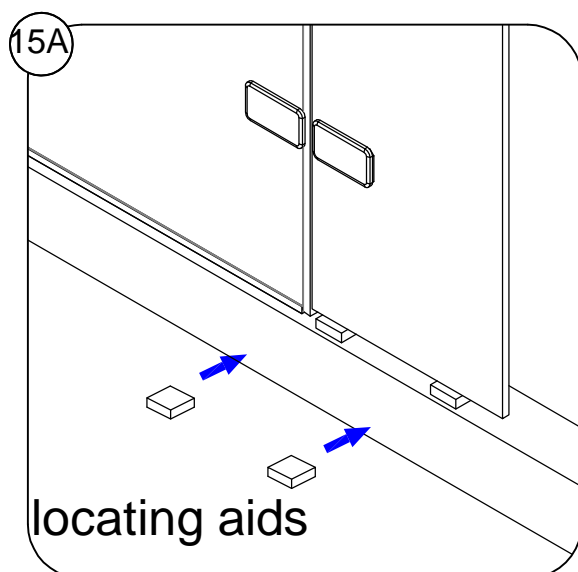

Step 16

16A: Remove the spacer from below the moving panel

16B: Make sure the you have a gap of 13mm below the moving panel to accept the bottom seal

16C: Fit the bottom seal.

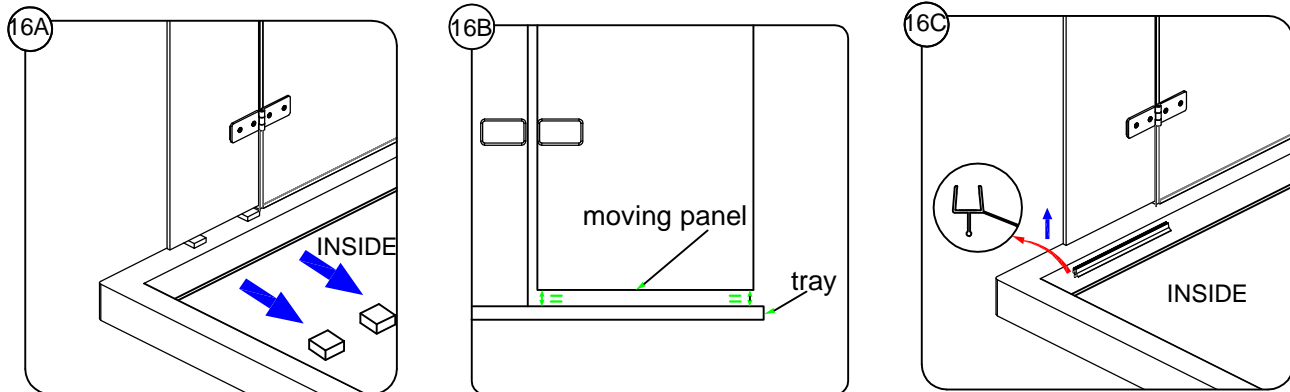

Step 17

17A: Measure distance B from inside face of the glass to the back wall.

17B: From the inside edge of the clamp measure distance B and cut rail to length.

17C: Fit the rail to the glass approx 50mm from the side of the glass.

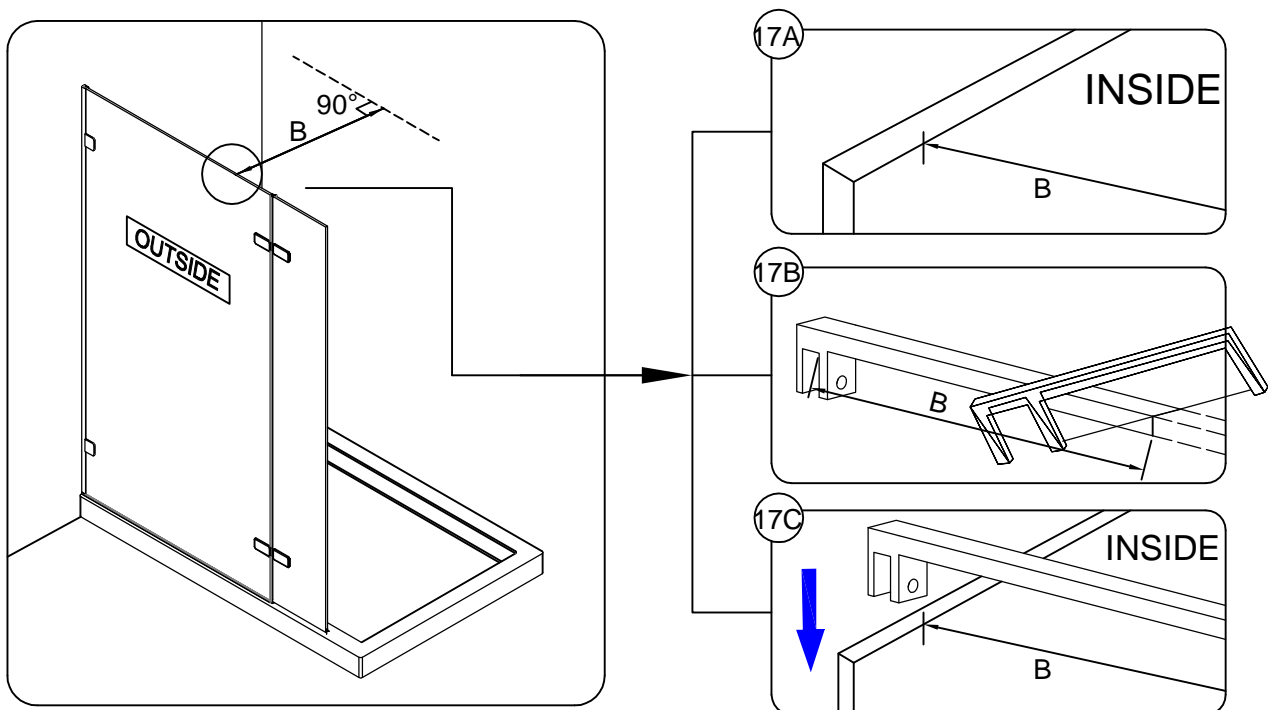

Step 18

Level the rail and mark the position of the bracket on the wall, then mark the fixing point.

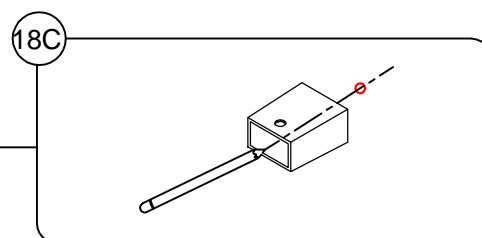
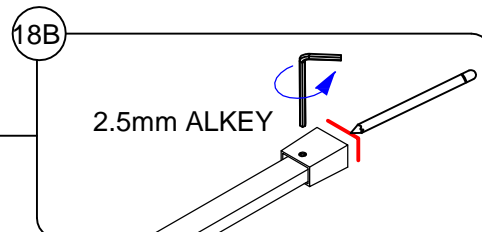
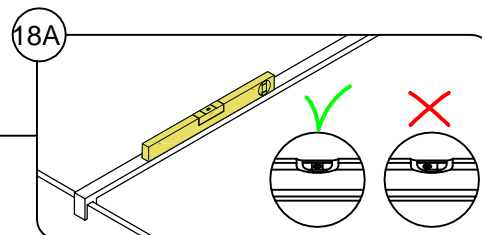
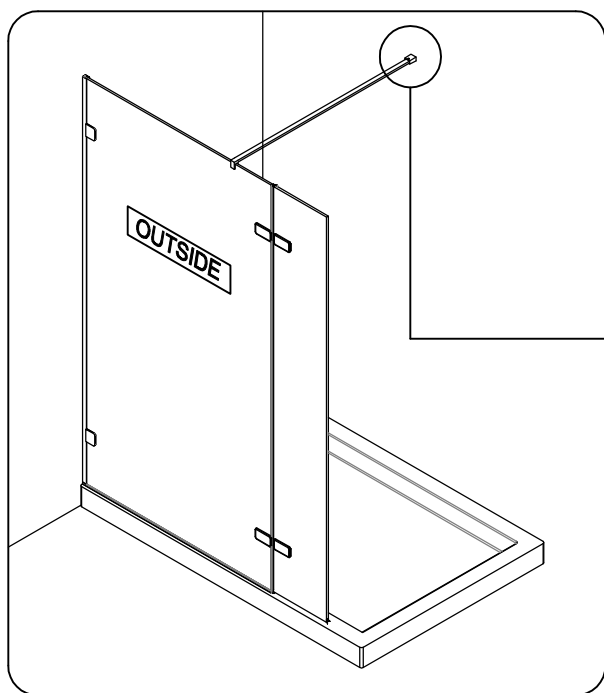

Step 19

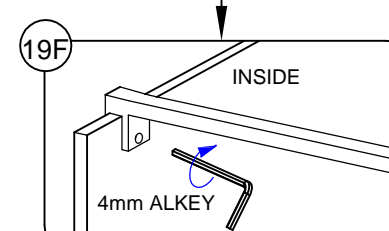
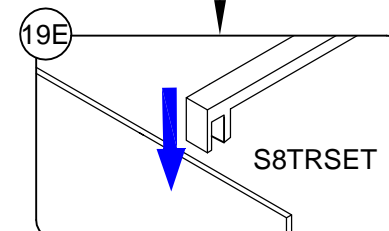
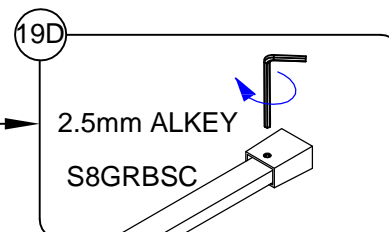
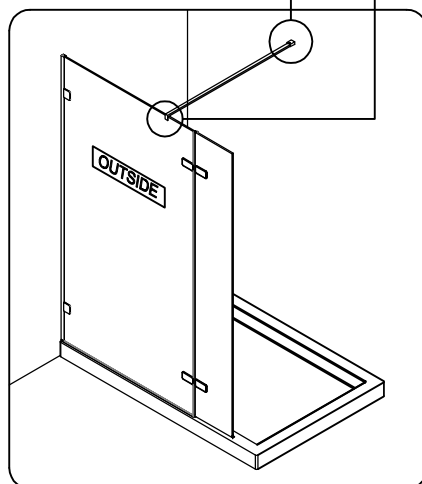
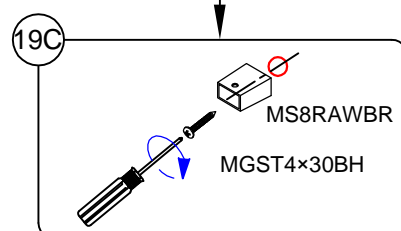
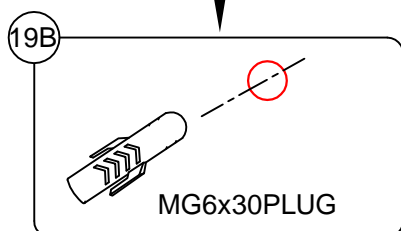
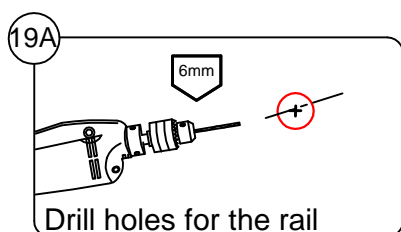

Step 20

Make sure all surfaces are thoroughly cleaned and dry before applying sealant.

Seal entire unit from the outside

Use quality silicone sealant and applicator gun to finish the door.

OUTSIDE

Seal top to bottom between the wall profile and the wall.

Seal along the bottom between the profile and the tray/tiled floor.

Seal the joint between the wall profile and the bottom profile and the bottom profile.

Do not use the enclosure for 24 hours.

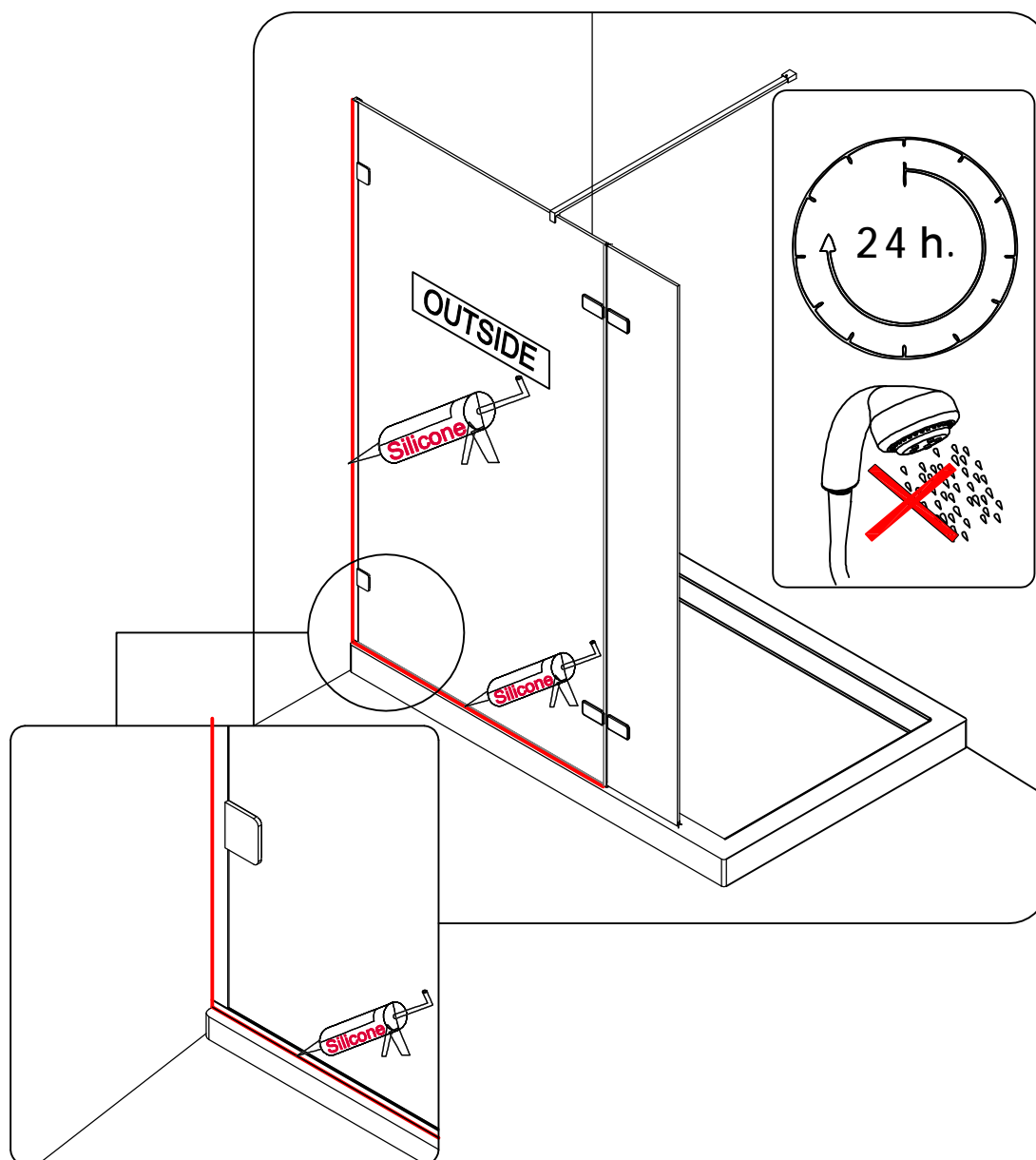

www.merlynshowering.com

MERLYN

Merlyn Showering
Unit 8, Purcellsinch Industrial Park,
Dublin Road, Kilkenny, Ireland.
Tel: 00353 56 779 1555
Fax: 00353 56 779 1576
www.merlynshowering.com