

BLACK SQUARED HINGE & INLINE

IN RECESS & WITH SIDE PANEL

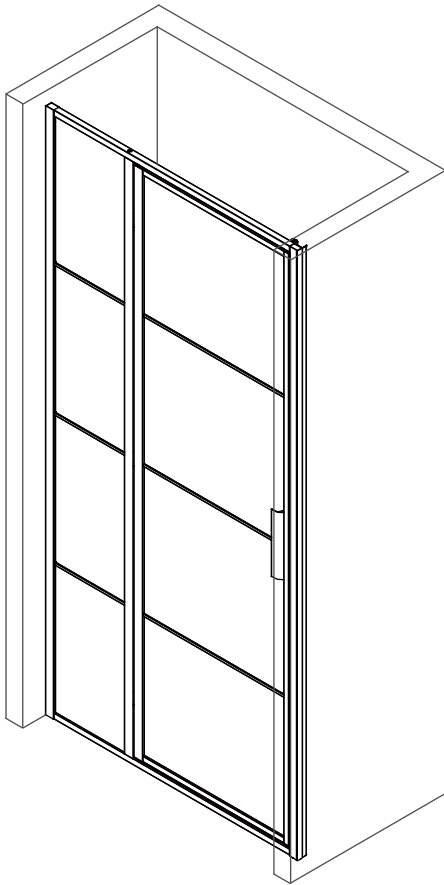

Left Hand

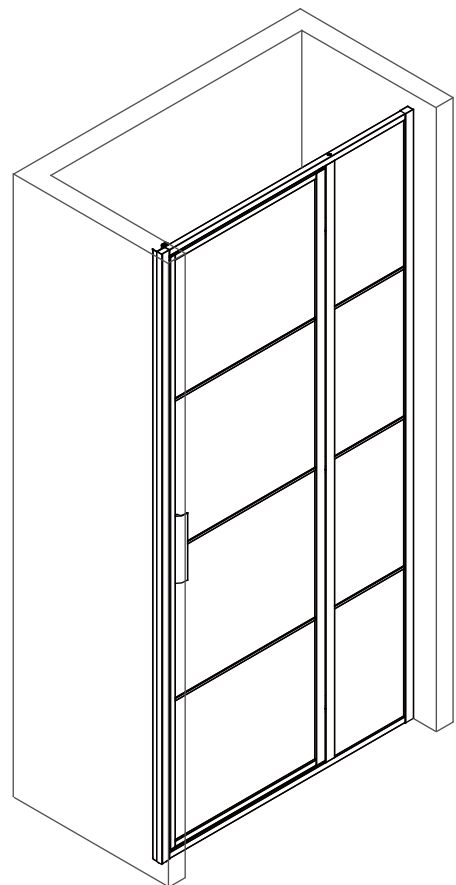

Right Hand

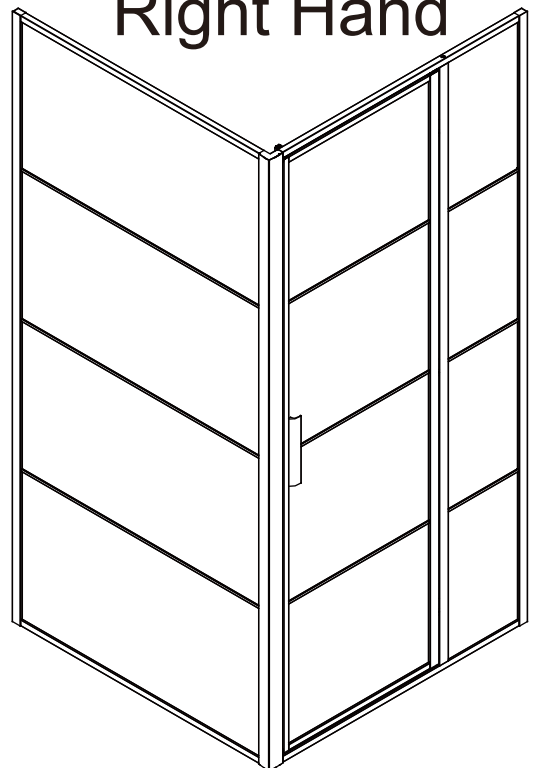
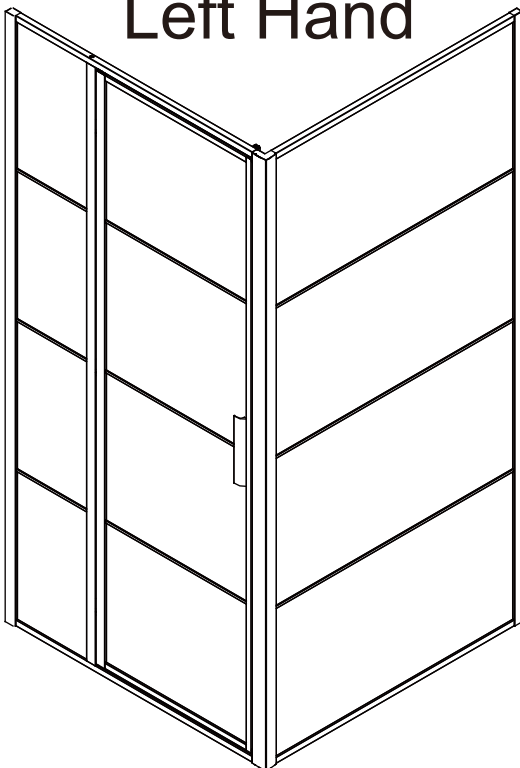

INSTALLATION GUIDE

IMPORTANT:

Please read the complete instructions before commencing fitting.

Make sure the tray is 100% level in all directions.

Do Not attempt to install the product unless you can tick all 4 boxes satisfactory.

- ☐ **Check that you have the tools required**
- ☐ **Check the installation site is compatible with the sizes of door supplied**
- ☐ **Check all the enclosure components are present**
- ☐ **Check the installation kit is complete**

The wall plugs supplied with the installation kit are for use in solid walls. Hollow or 'stud partition' walls will require alternative fixings. Please consult a hardware supplier for the correct type.

It may also be necessary to consult your tiling supplier about the correct method for drilling your tiles.

ATTENTION: TAKE EXTREME CARE WHEN HANDLING GLASS, WEAR PROTECTIVE EYEWEAR AND CLOTHING. DO NOT LEAVE THE GLASS ON HARD SURFACES AND AVOID CONTACT BETWEEN THE GLASS EDGES AND HARD SURFACES OR IMPACTS DURING THE INSTALLATION.

◆ Exploded Diagram

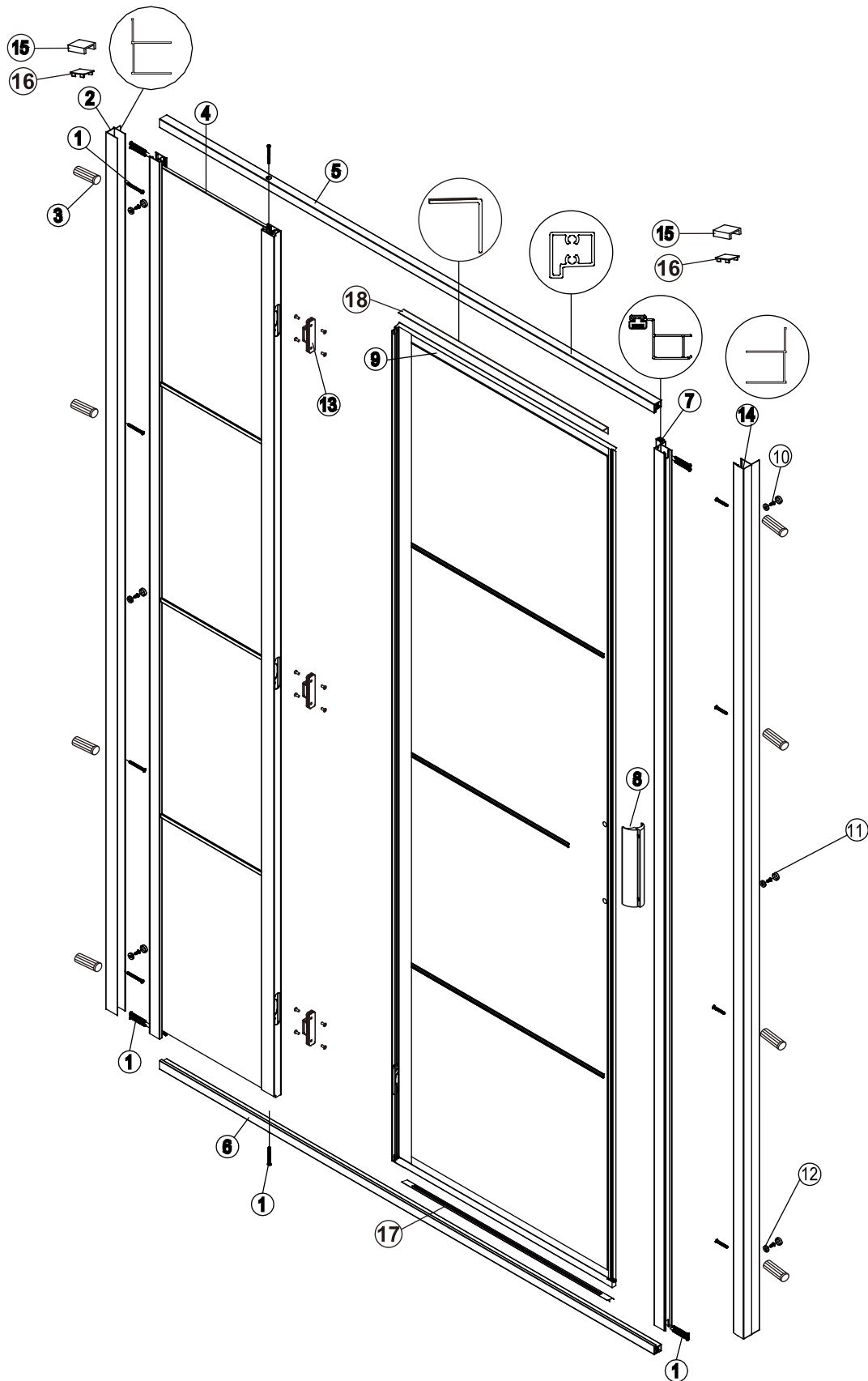

No.	Qty	Part No.	No.	Qty	Part No.	No.	Qty	Part No.
①	18	SP02SY51	⑧	1	B0014B	⑮	2	B0006B
②	1	B0001B	⑨	1	DOOR PANEL	⑯	2	B0007B
③	8	SP02SP12	⑩	6	SP02SY53	⑰	1	B0015B
④	1	FIXED PANEL	⑪	14	B0016B	⑱	1	B0008B
⑤	1	B0002B	⑫	14	B0017B			
⑥	1	B0003B	⑬	3	B0013B			
⑦	1	B0005B	⑭	1	B0001B			

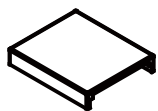
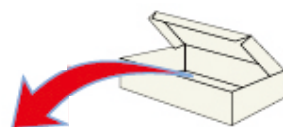
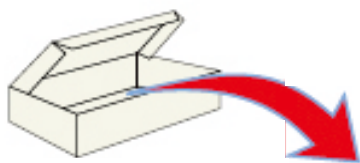

B0006B
x1

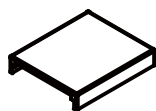

B0006B
x1



SP0C056
x1



B0013B
x3



B0016B
x14



B0017B
x14



SP02SY53
x6



B0014B
x1

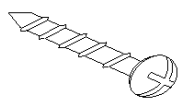

SP02SY51
x18



SP02SP12
x8



B0021
x1

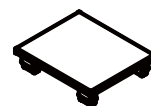

B0007B
x2

Tools required

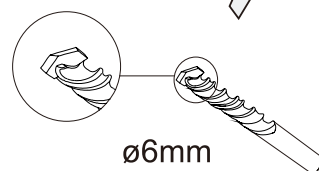
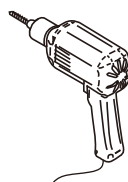
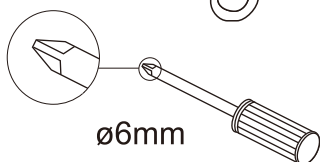
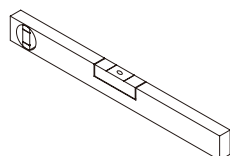
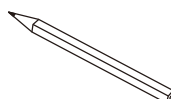
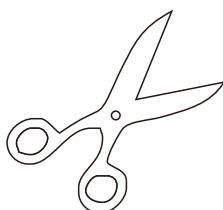
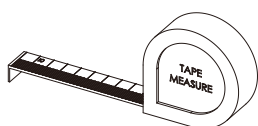

1

Ensure the shower tray is level in all directions and is properly sealed to the wall. The wall must be tiled down to the top edge of the tray. Do not angle out bottom tile.

TRAY MUST BE LEVEL IN ALL DIRECTIONS!

TRAY MUST BE SEALED FULLY AROUND WHERE THE TRAY MEETS THE WALL.

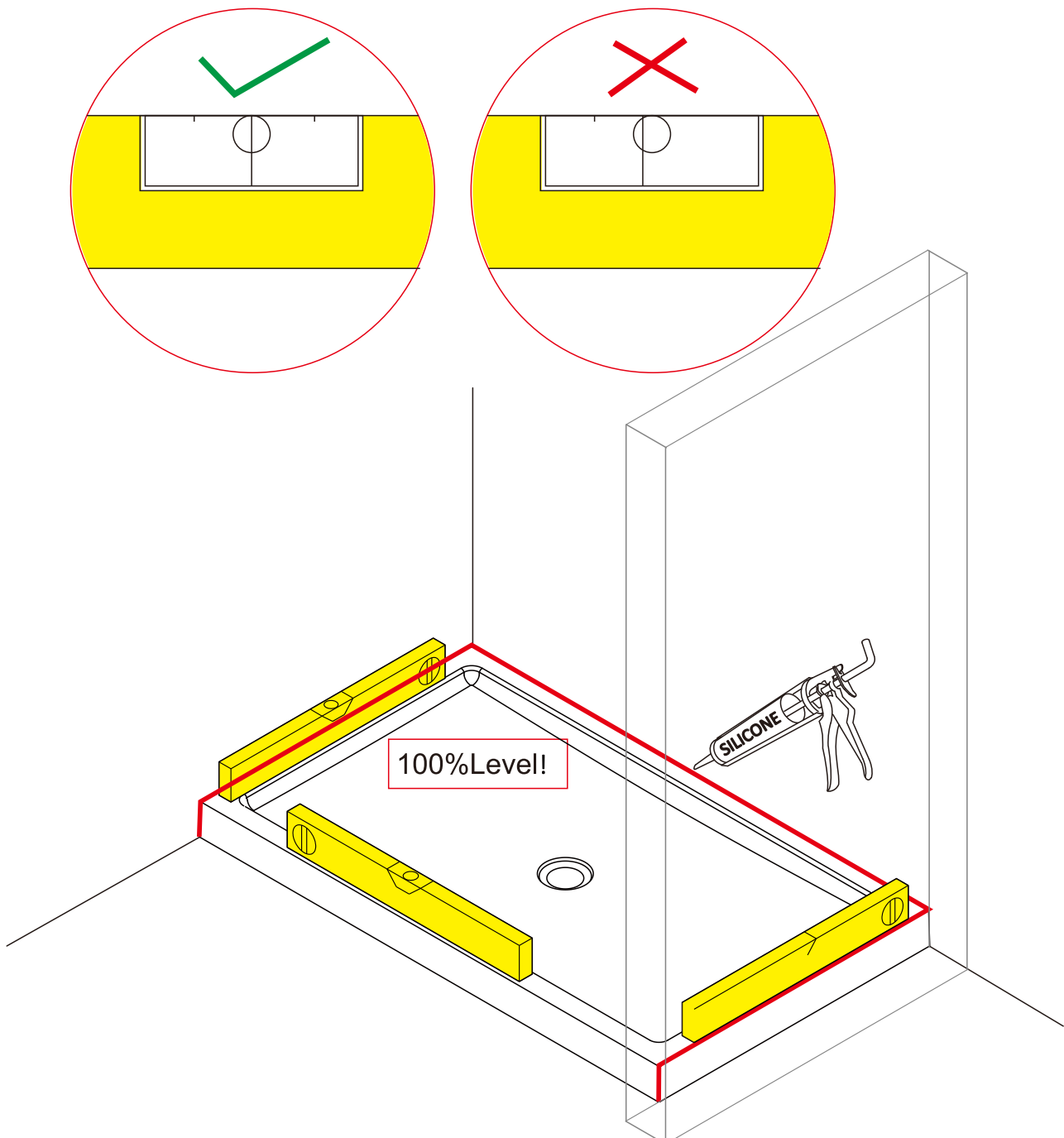

2A Measure the width of the recess top, middle and bottom and check Min-Max measurement is within the adjustment of the size chosen. Determine the positions of the wall profile within your adjustment.

2A

2B

Min 10mm

Size	x
900	850-890
1000	950-990
1200	1150-1190
1400	1350-1390

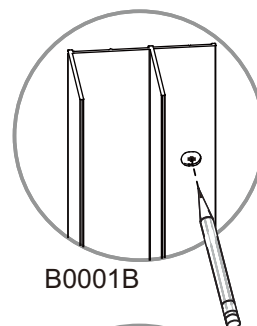

B0001B

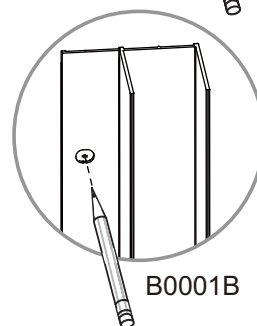

B0001B



Make sure your measurements are correct and that they match the enclosure adjustments before you drill the holes.

Install the top profile -
Note the protrusion of the profile should be on the outside of the enclosure.

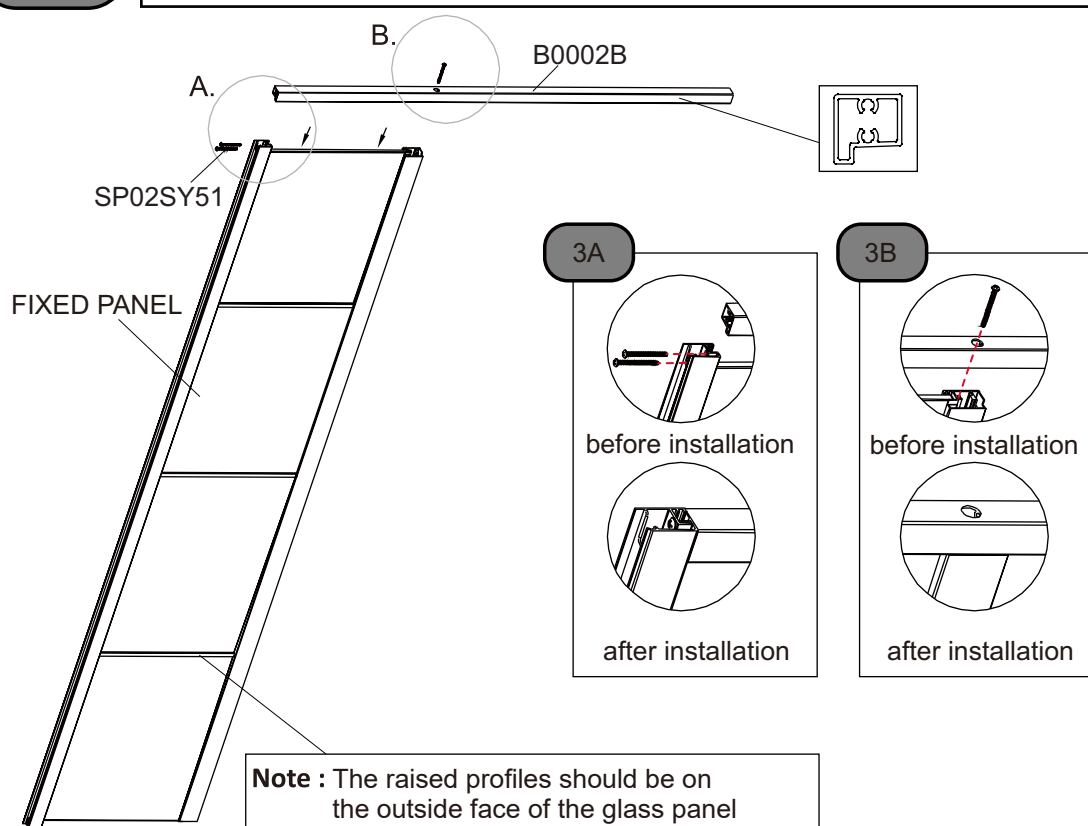

Note : The raised profiles should be on the outside face of the glass panel

4

Install the bottom profile -
Note the protrusion of the profile should be on the outside of the enclosure.

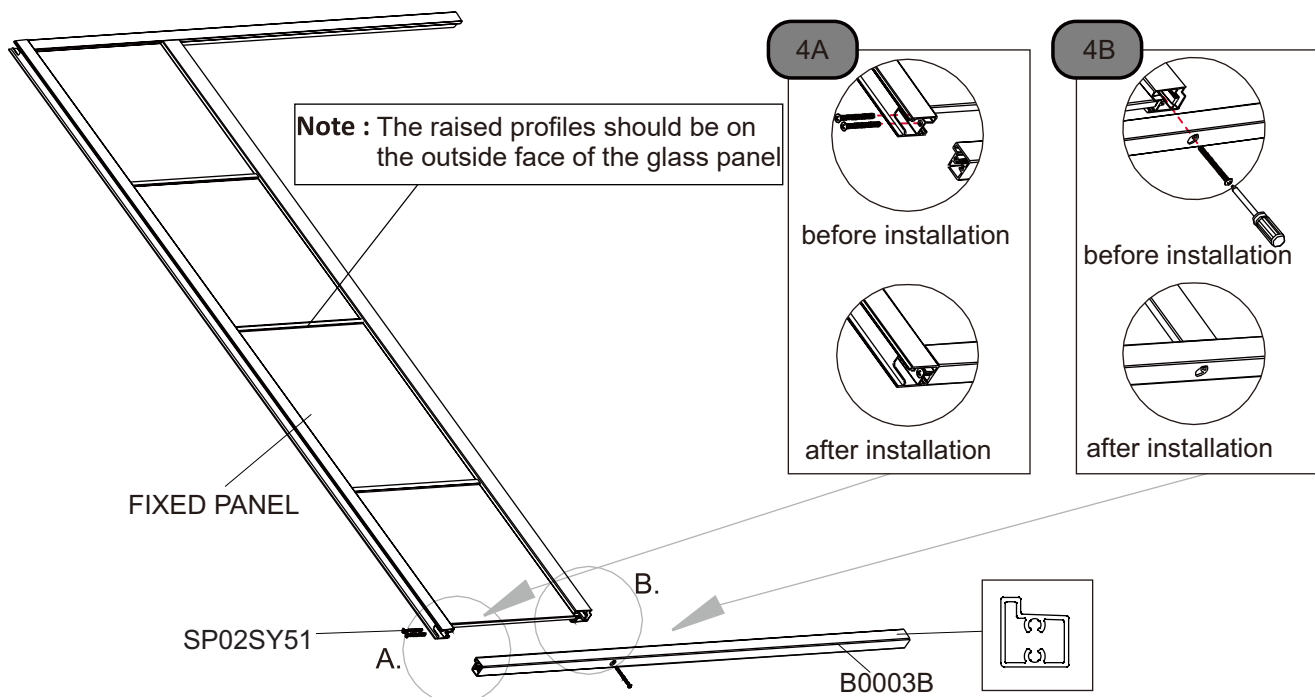

5

Install the closing post profile, ensuring the magnetic strip is to the inside of the enclosure.

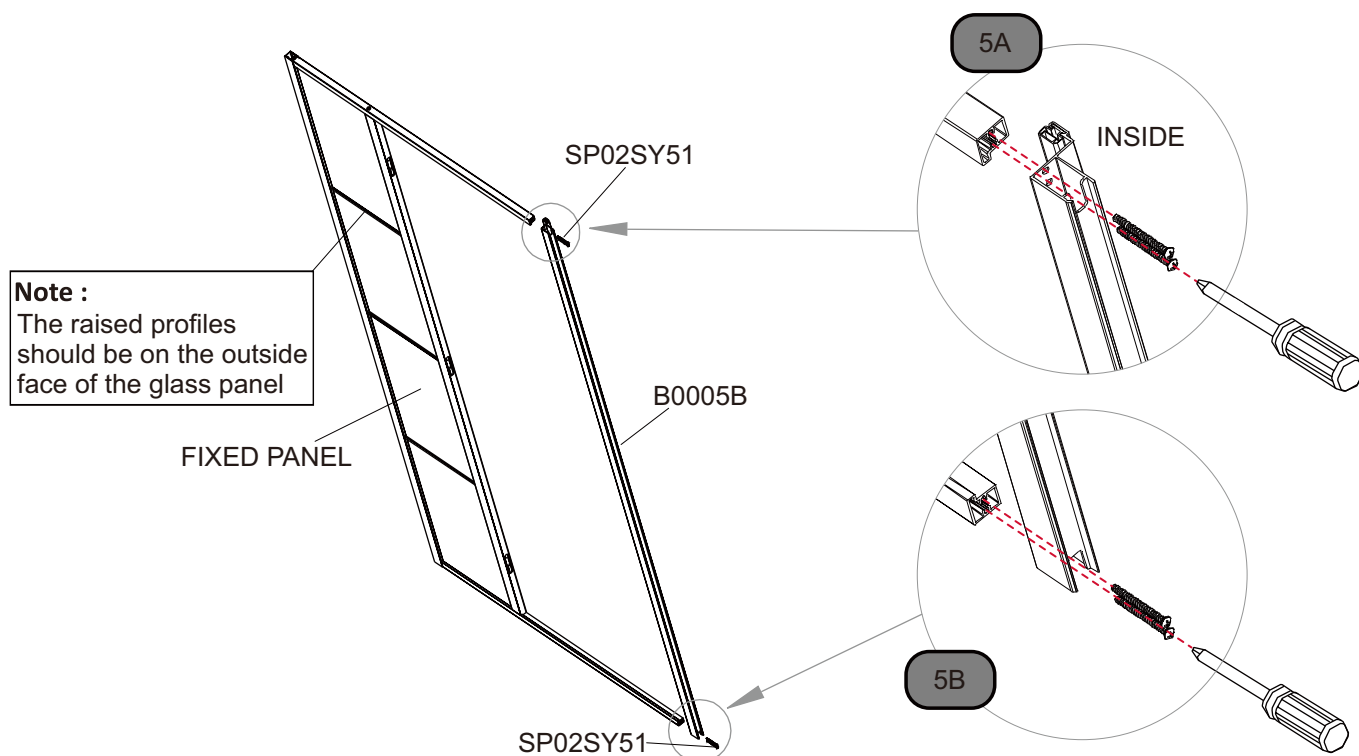

6

6A, 6B Slide the wall profiles onto either end of the framed enclosure ensuring that the flange is to the inside.
6C Lift the complete enclosure onto the tray and make sure you have a consistent step in along the front of your enclosure.
6D, 6E & 6F Fit the screw cover clip onto screw and fix the wall profiles to the wall with SP02SY51 as shown. Then fit the screw cover caps.

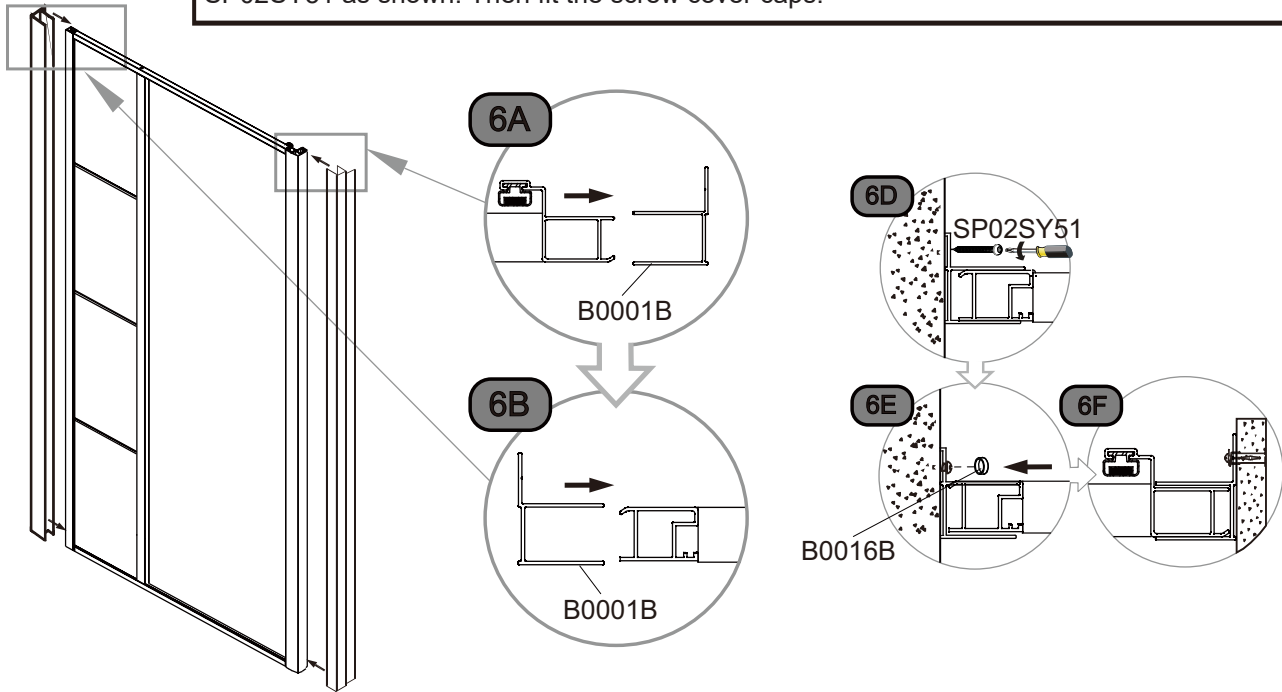

7

7A Install the hinges into the moving panel.
7B Add a dab of silicone to each end of the B0015 bottom seal and push vertically into the channel on the underside of the door profile.

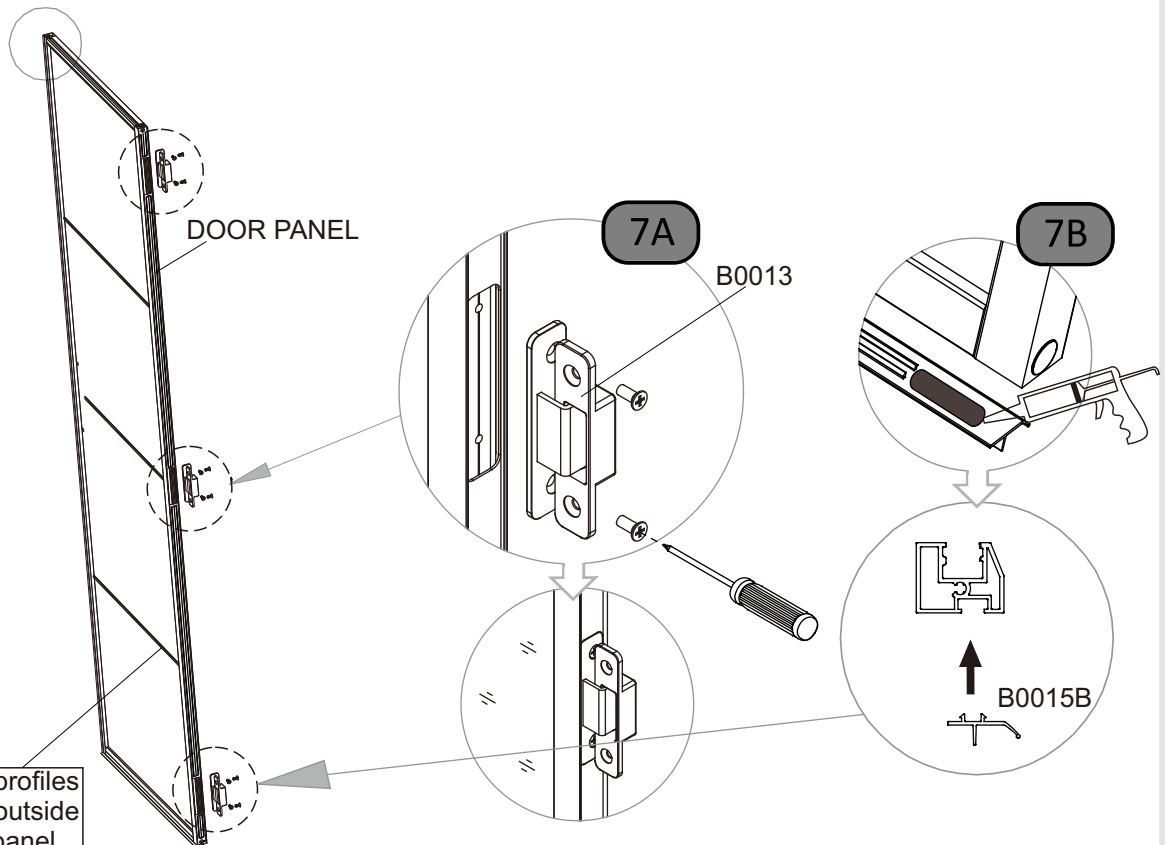

Note: The raised profiles should be on the outside face of the glass panel

8

8A Offer up the door to the fixed profile - beginning at the top install the hinges into each cavity of the fixed panel vertical profile and secure with hinge screws provided.

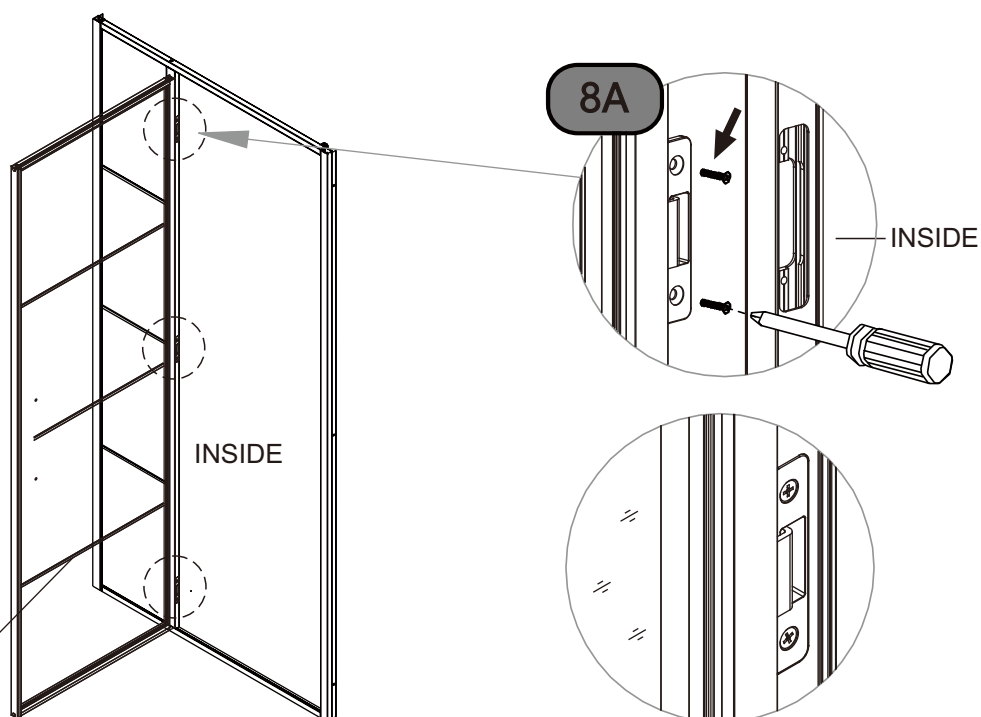

Note: The raised profiles should be on the outside face of the glass panel

9

Adjust the enclosure to the desired width and secure with the screw and cover cap combination as shown.

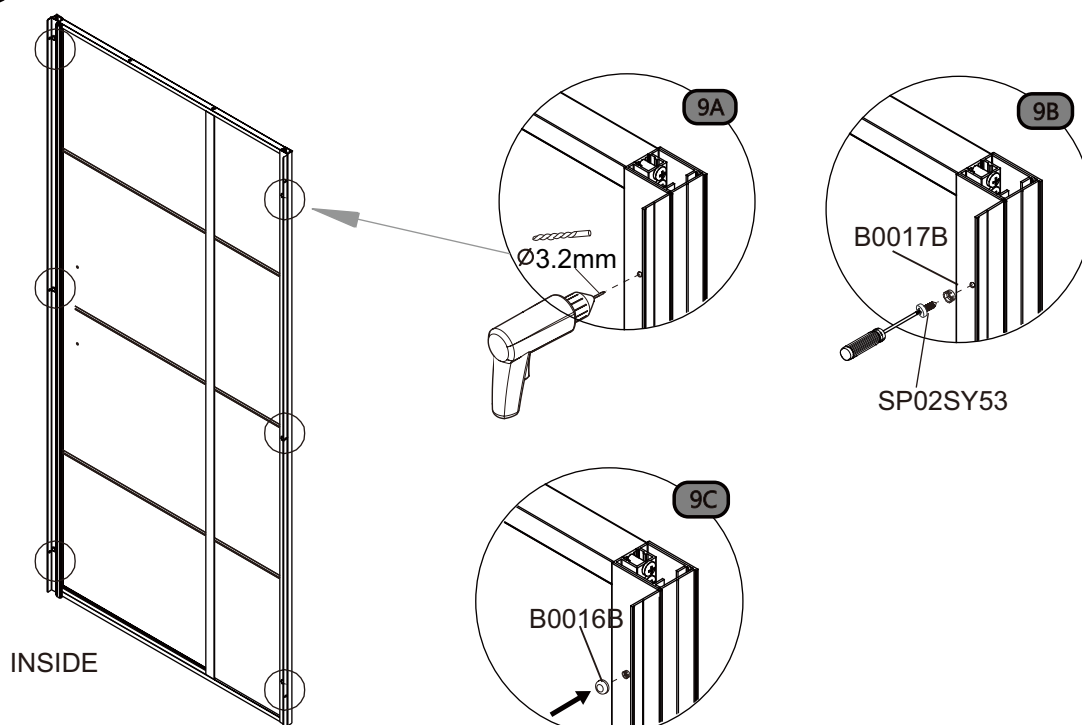

10

Install the L shape gasket to the underside of the top profile.
10A for W900mm size enclosure cut 100mm off the length of the L shape gasket to fit.

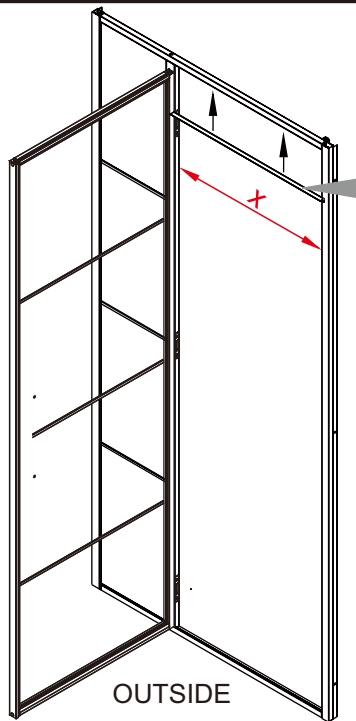

OUTSIDE

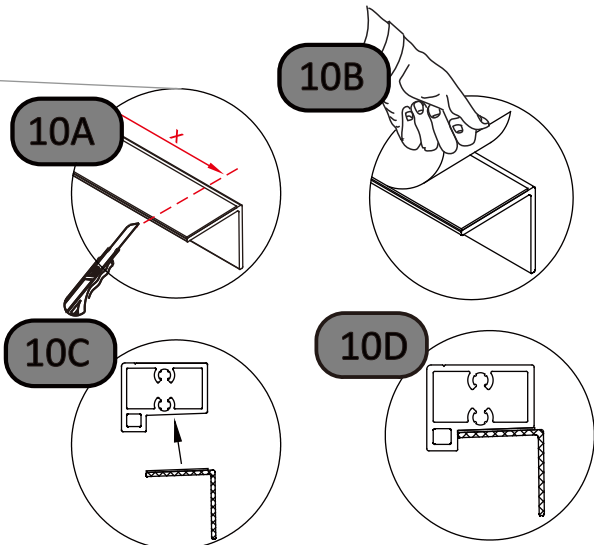

Note: Fix with the L shape to the inside

11

Install the handle onto the door using PVC washers provided.
11A From the inside of the enclosure screw into the front handle, slide on the inside handle and fix with grub screws with allen key provide.

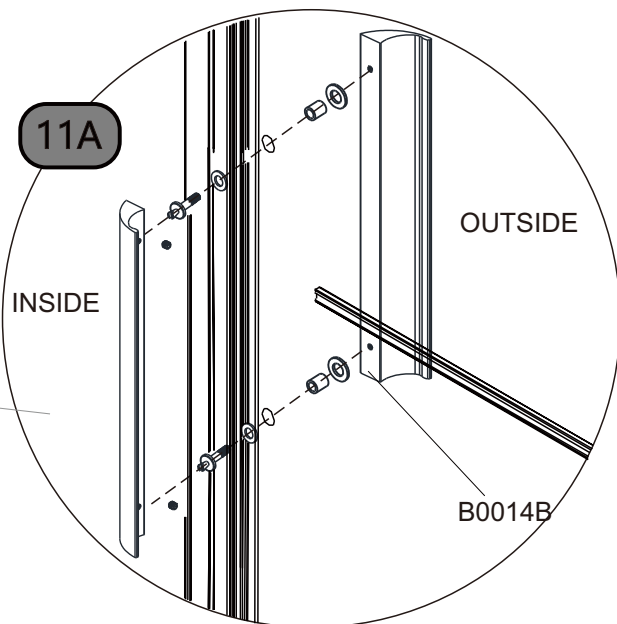
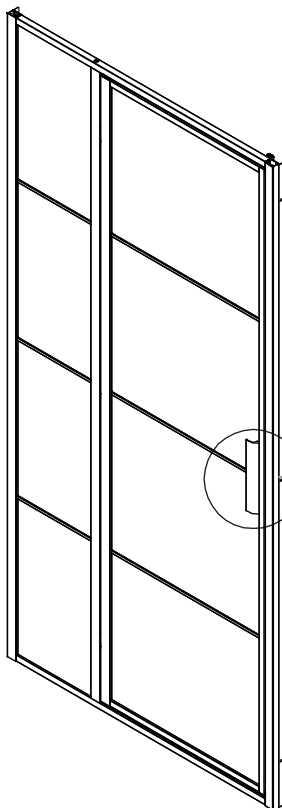

INSIDE

OUTSIDE

B0014B

12

Use a good quality anti-bacterial neutral cure silicone to seal the shower enclosure as shown below. Please be sure to wait 24hrs before use.

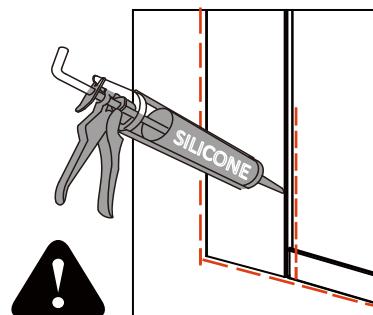
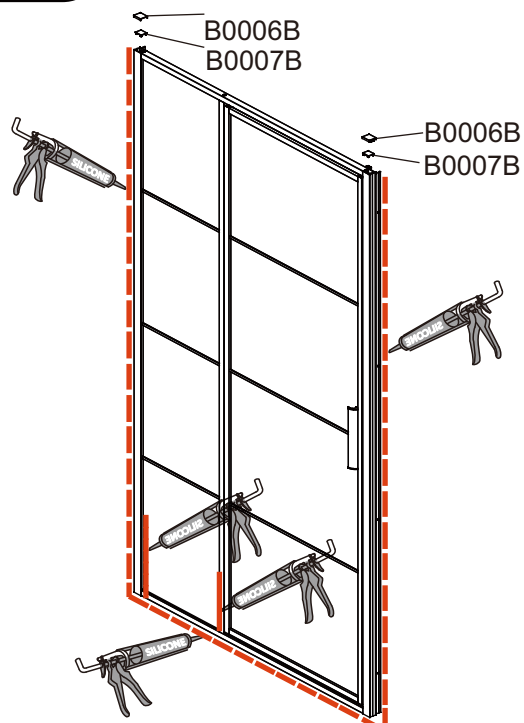

All sealant should be applied to the outside. Seal top to bottom between the wall profile and the wall. Seal the bottom between the tray/floor and the glass/rail/profile and approximately 50mm vertically between the wall profile and the glass.



Allow 24 hours for silicone to dry before use.

◆ Exploded Diagram

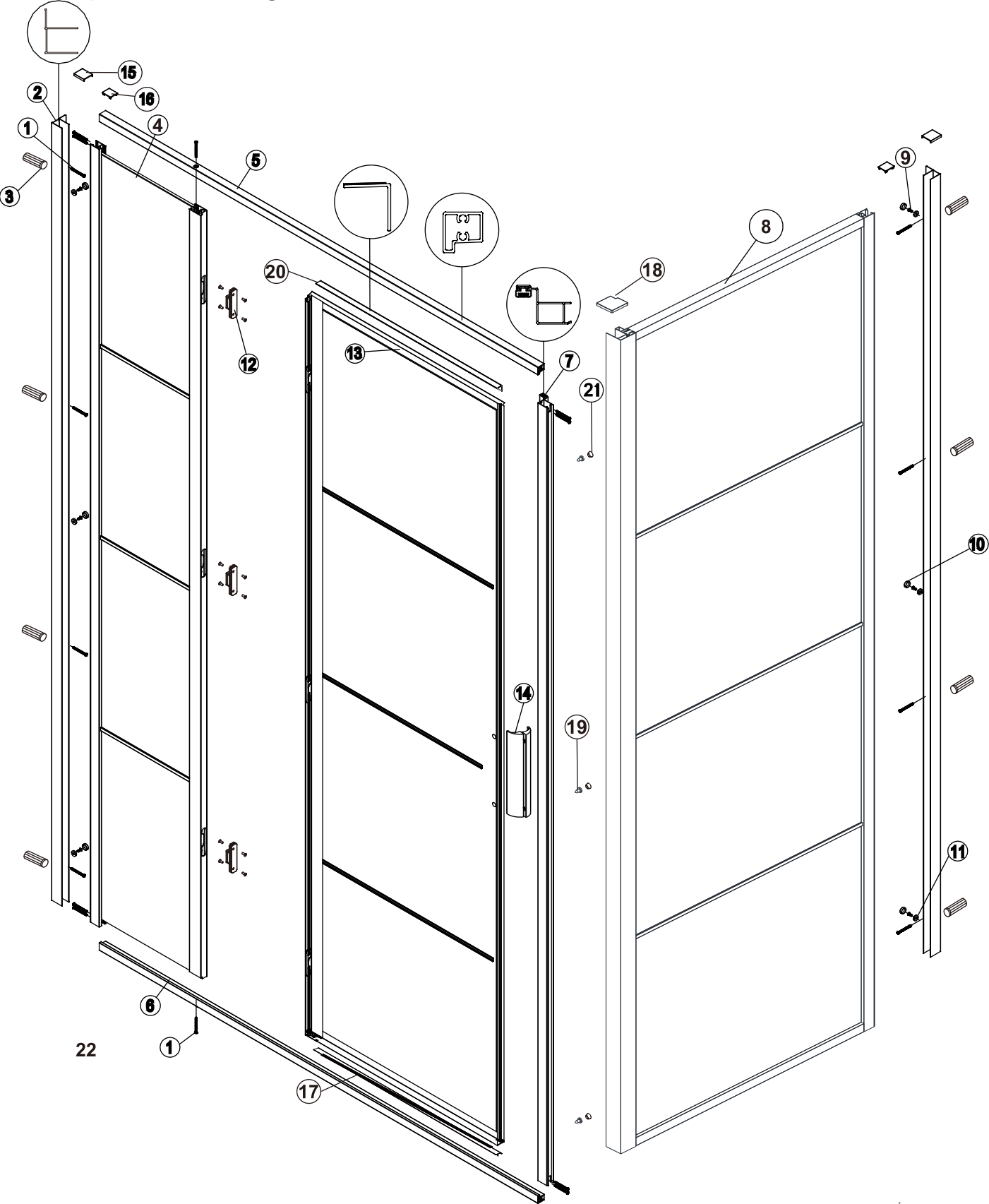

No.	Qty	Part No.	No.	Qty	Part No.	No.	Qty	Part No.
①	18	SP02SY51	⑨	6	SP02SY53	⑰	1	B0015B
②	2	B0001B	⑩	14	B0016B	⑱	1	B0010B
③	8	SP02SP12	⑪	14	B0017B	⑲	3	B0012B
④	1	FIXED PANEL	⑫	3	B0013B	⑳	1	B0008B
⑤	1	B0002B	⑬	1	DOOR PANEL	㉑	3	B0011B
⑥	1	B0003B	⑭	1	B0014B			
⑦	1	B0005B	⑮	2	B0006BB			
⑧	1	SIDE PANEL	⑯	3	B0007B			

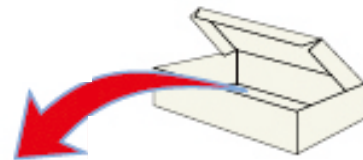
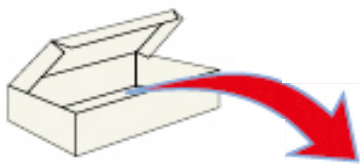

Side panel Fixing kit Components



B0012B
x3



B0011B
x3



B0010B
x1



B0010B
x1

Tools required

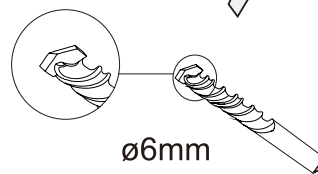
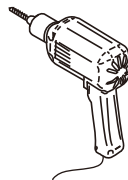
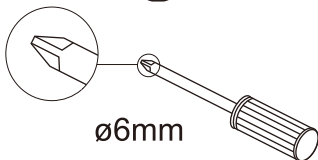
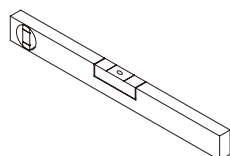
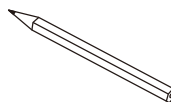
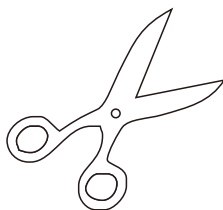
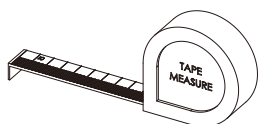

1

Ensure the shower tray is level in all directions and is properly sealed to the wall. The wall must be tiled down to the top edge of the tray. Do not angle out bottom tile.

TRAY MUST BE LEVEL IN ALL DIRECTIONS!

TRAY MUST BE SEALED FULLY AROUND WHERE THE TRAY MEETS THE WALL.

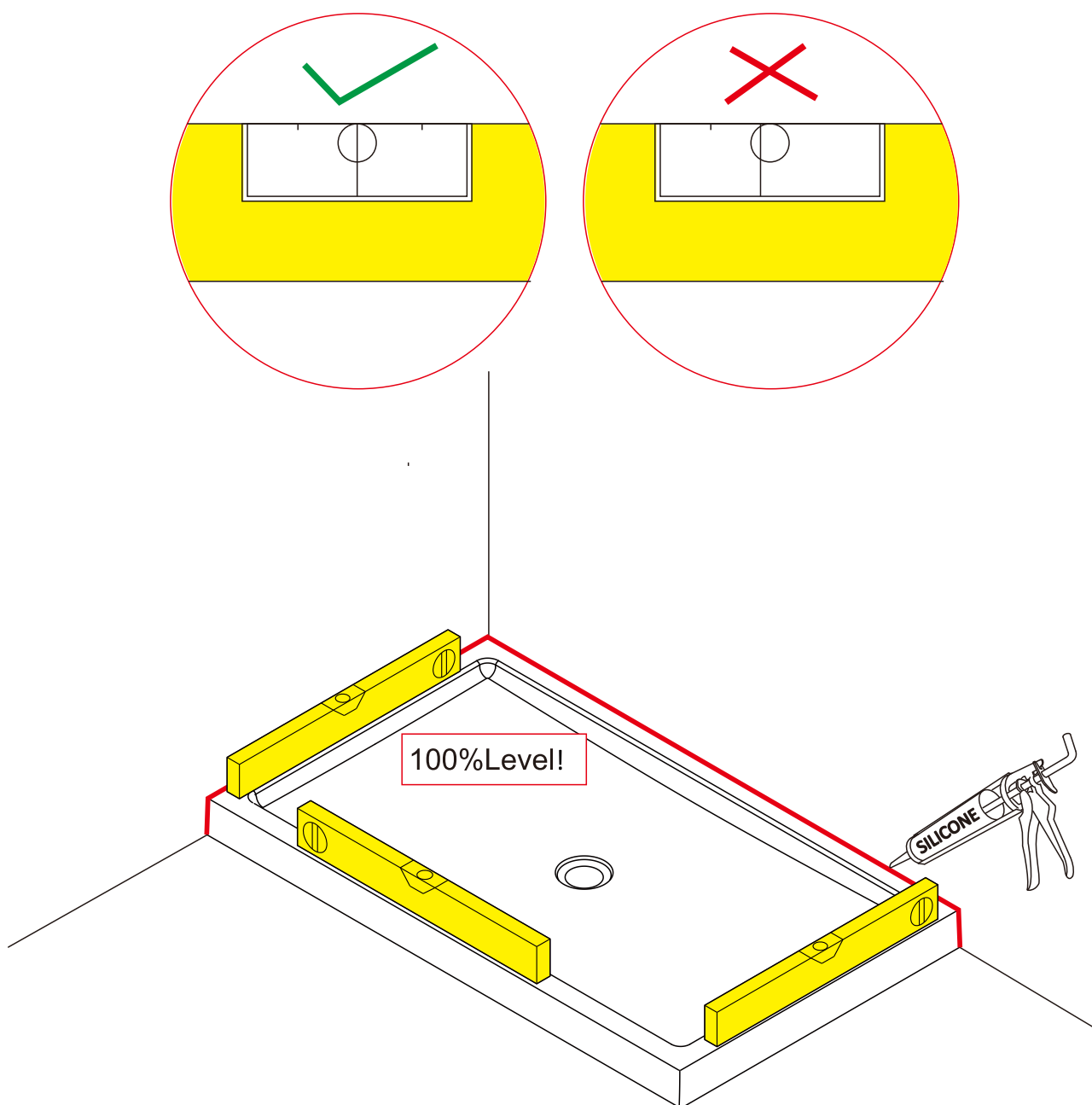

2

2A Measure the width of the X and Y positions top, middle and bottom and check the Min-Max. measurement is within the adjustment of the size chosen. Determine the positions of the wall profile within your adjustment.

2B Step in min 10mm on both sides. Plumb and mark the wall profiles positions.

Size	x
800	770-790
900	870-890

Size	Y
900	858-878
1000	958-978
1200	1158-1178
1400	1358-1378

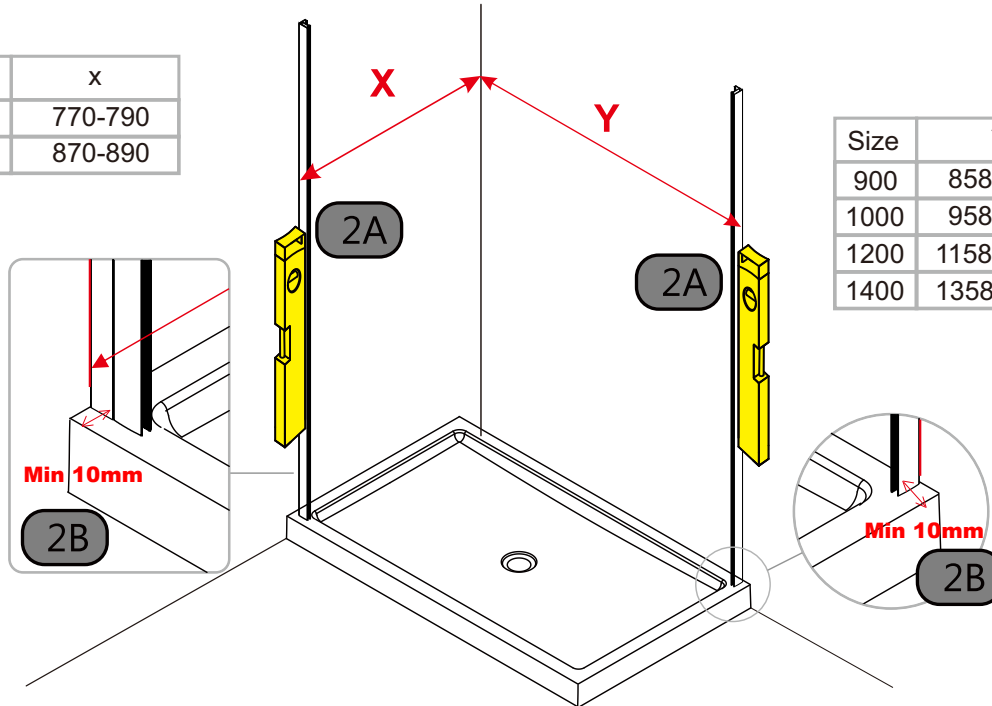

3

3A, 3B Plumb your profile then mark the holes positions.

3C, 3D Remove the wall profile for drilling and install wall plugs into each drilled hole.

3E Fit the screw cover clip onto the screw and fix the wall profiles to the wall with SP02SY51 as shown. Fit the screw cover caps

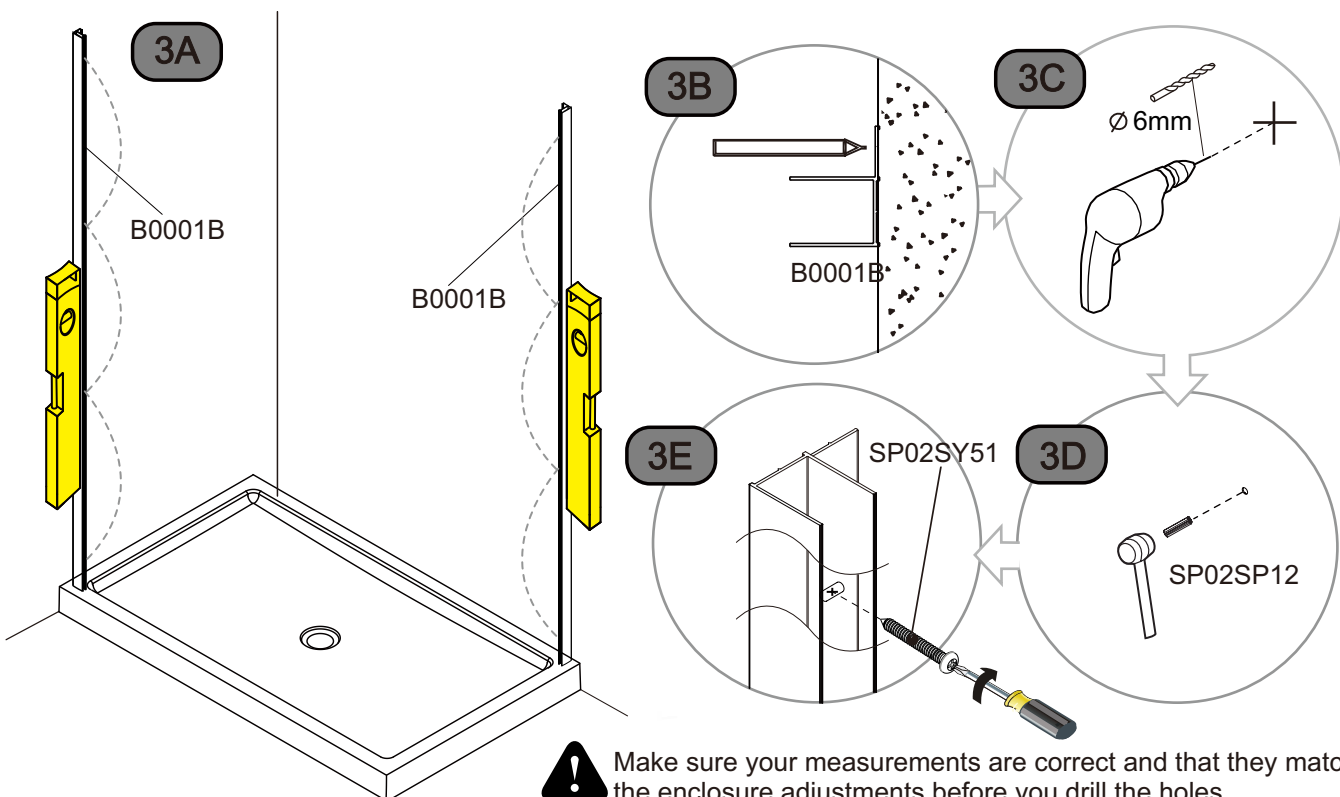

Make sure your measurements are correct and that they match the enclosure adjustments before you drill the holes.

4

Install the top profile -
Note: The protrusion of the profile should be on the outside of enclosure

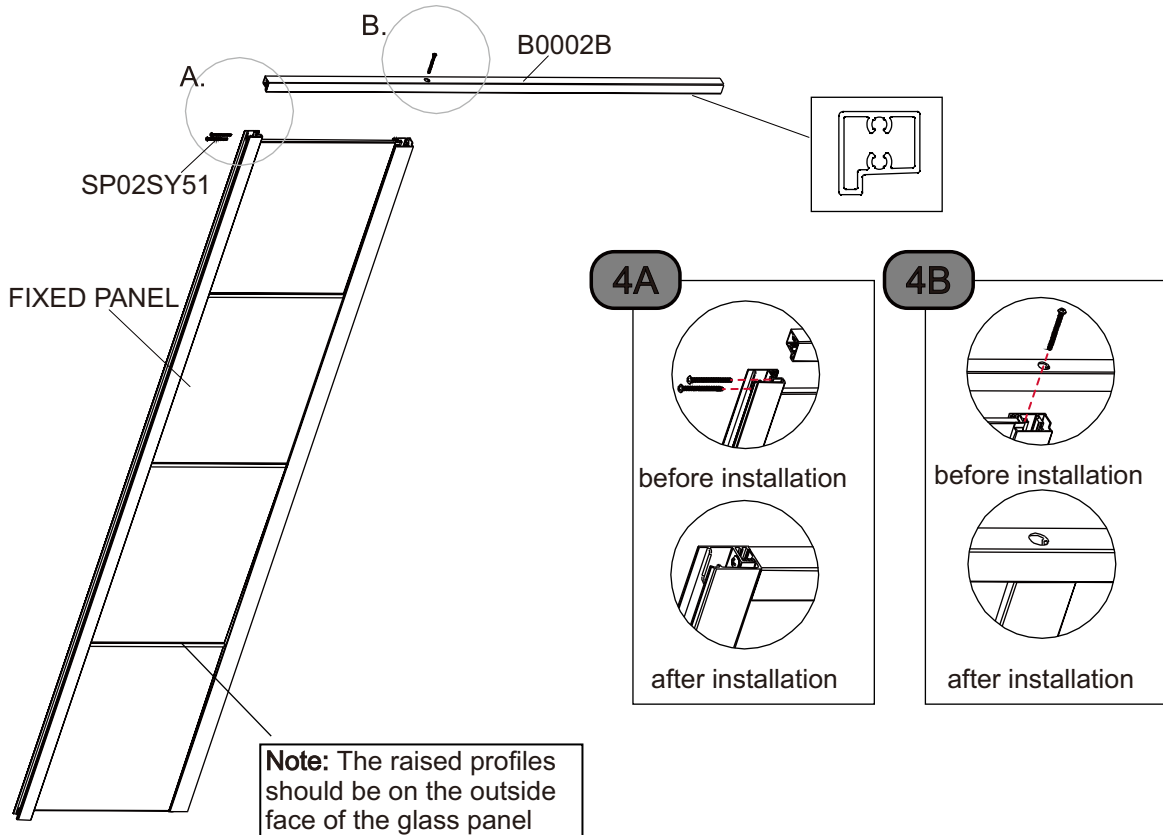

5

Install the bottom profile -
Note: The protrusion of the profile should be on the outside of enclosure

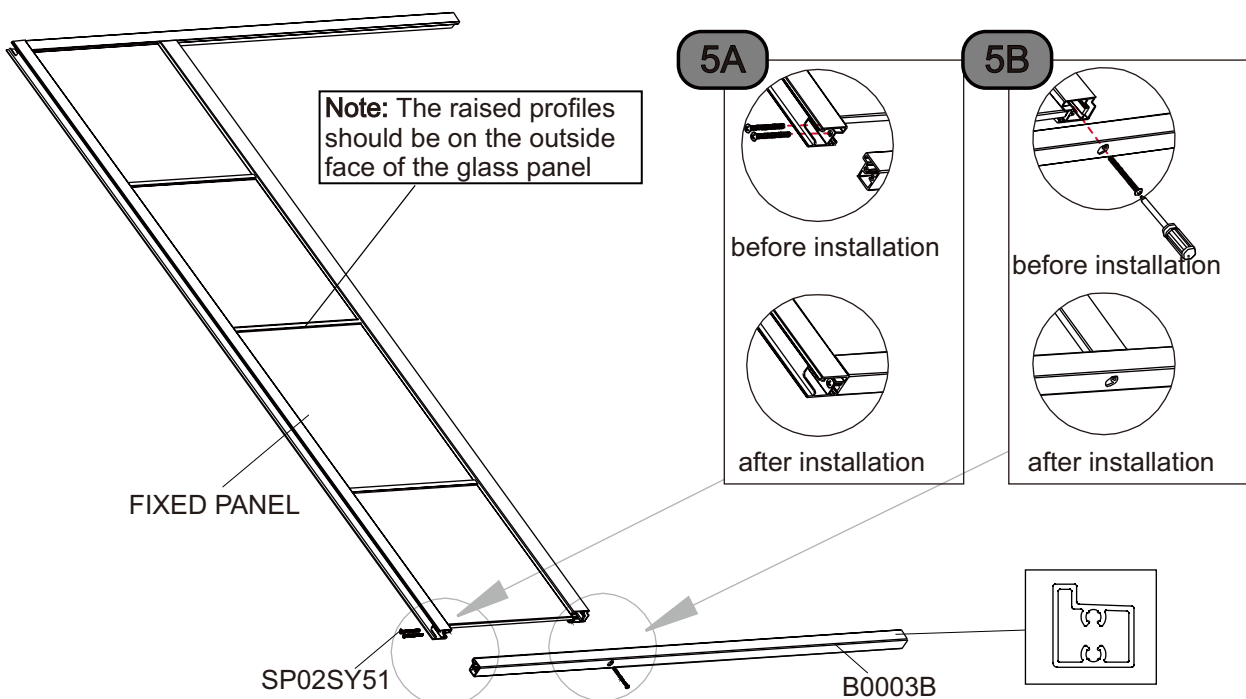

6

Install the closing post profile, ensuring the magnetic strip is to the inside of the enclosure.

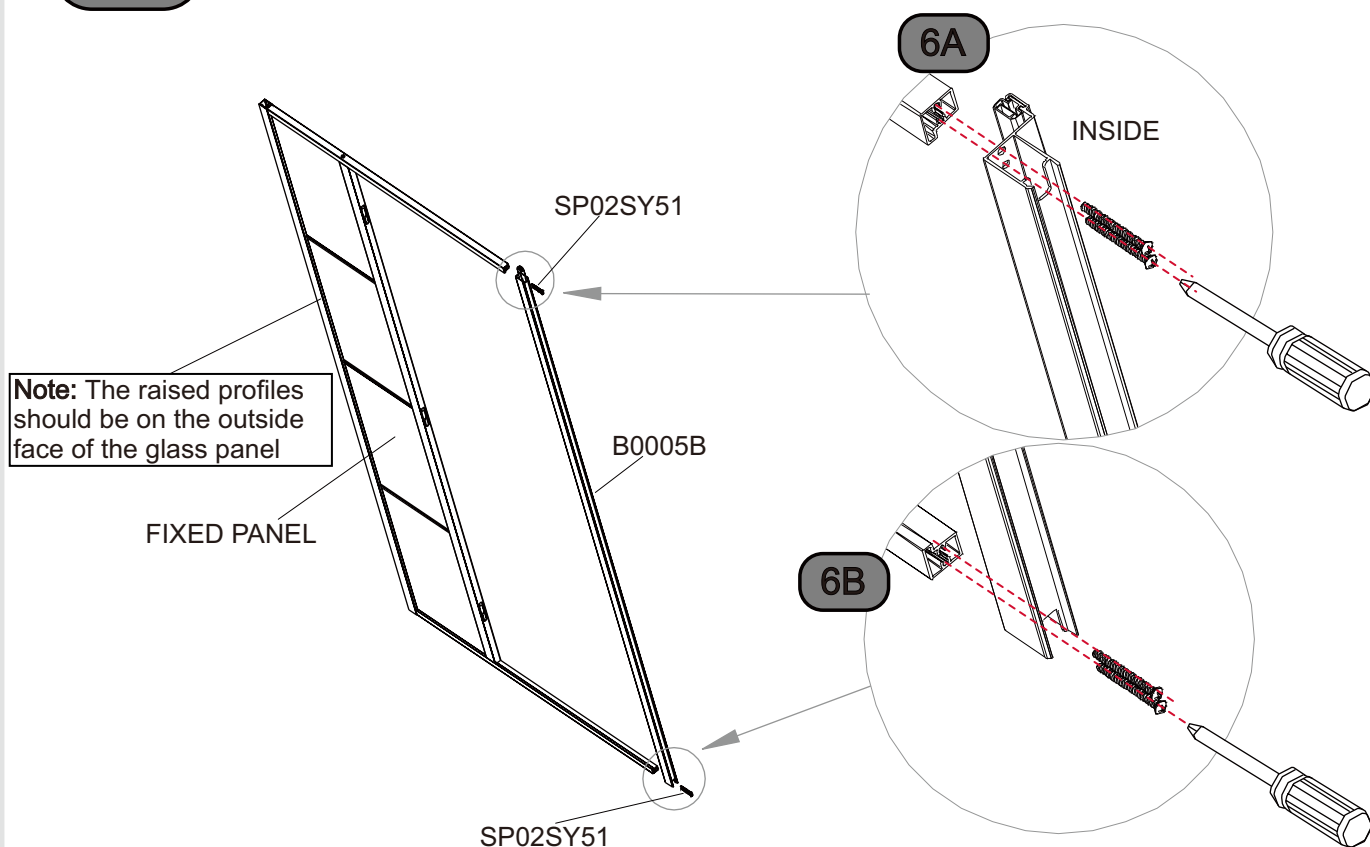

7

Once the frame is assembled it can then be fitted into the prefixed wall profile from Step 3.

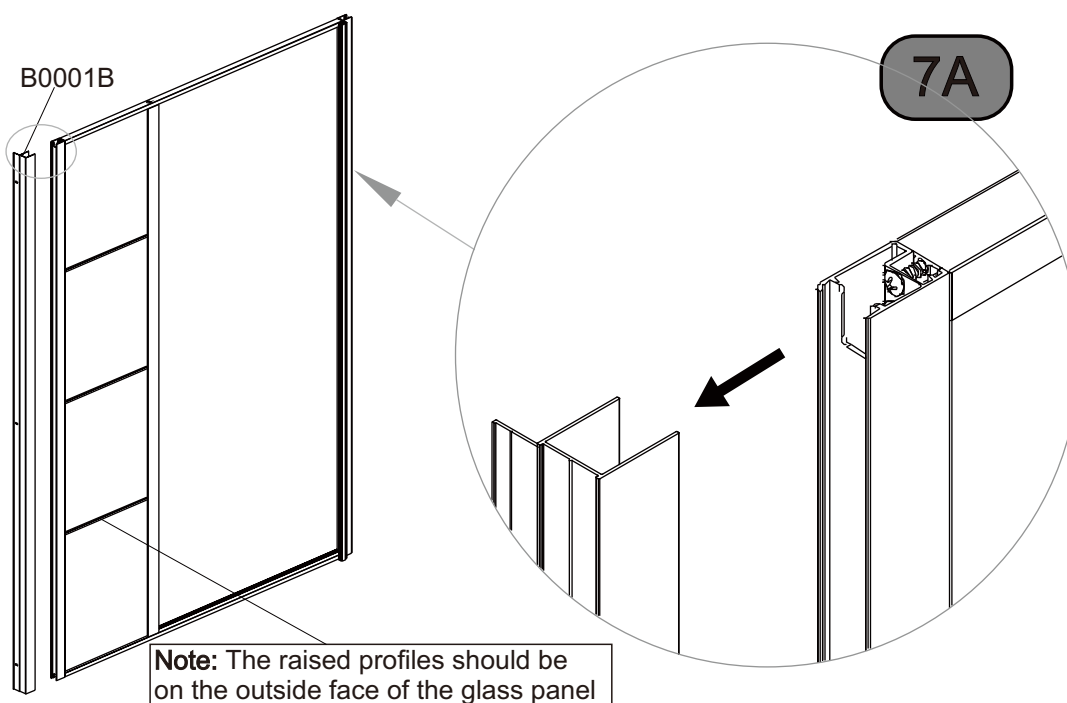

8

Fit the side panel into the wall profile and front profile as shown.

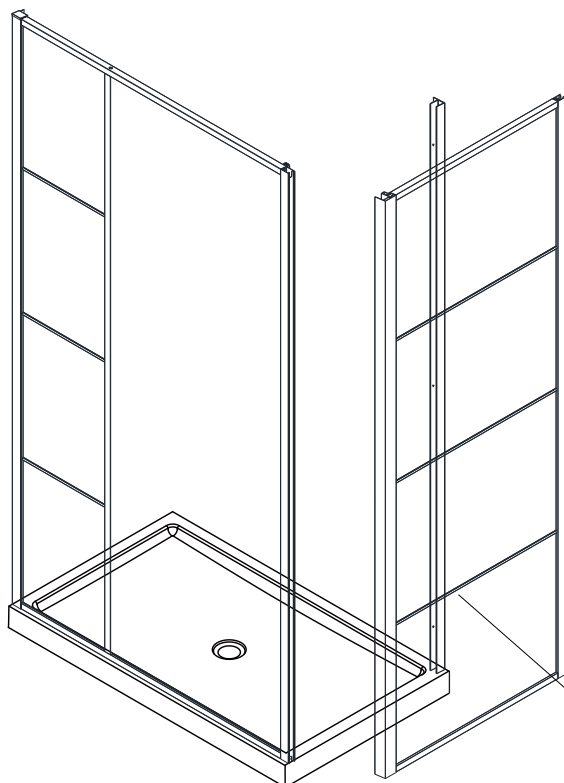

8A

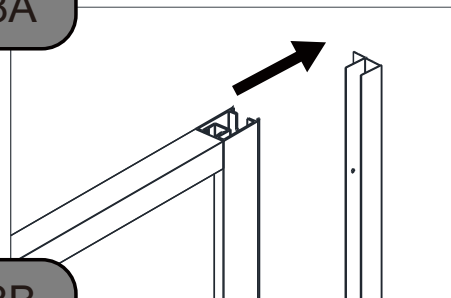

8B

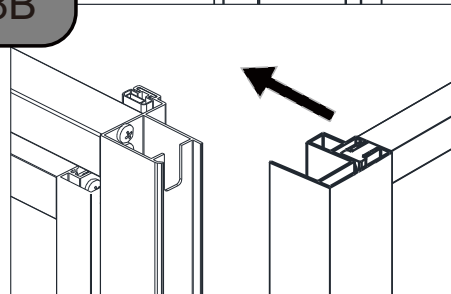

Note: The raised profiles should be on the outside face of the glass panel

9

Fix the corner post profile with screw B0012B and B0011B cover cap combination as shown.

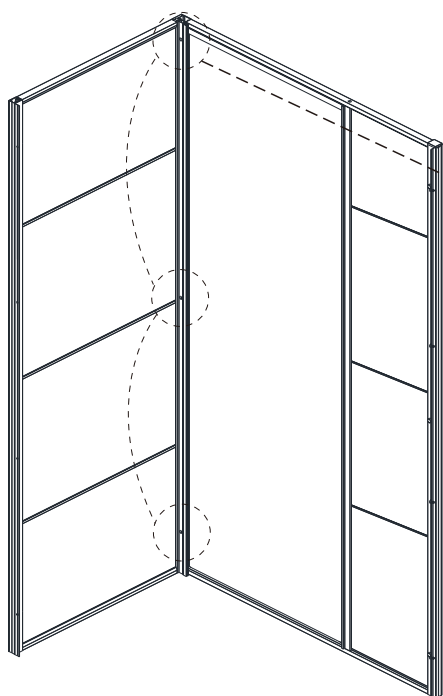

9A

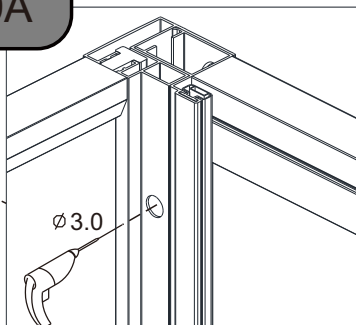

9B

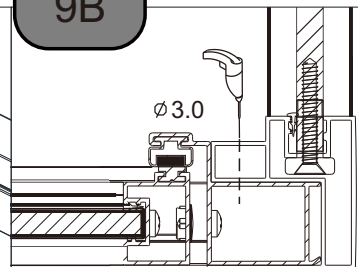

9C

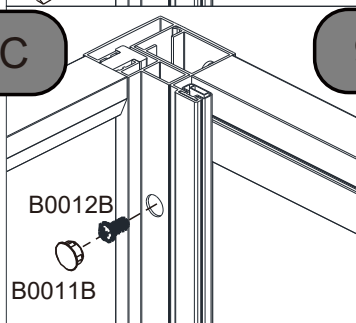

9D

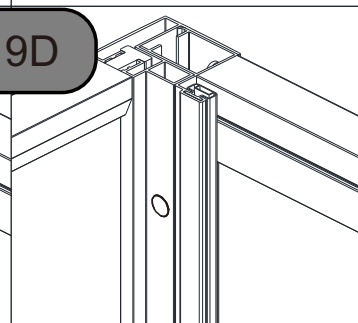

B0012B
B0011B

10

Adjust the enclosure to the desired width and secure with the SP02SY53 screw and cover cap combination as shown.

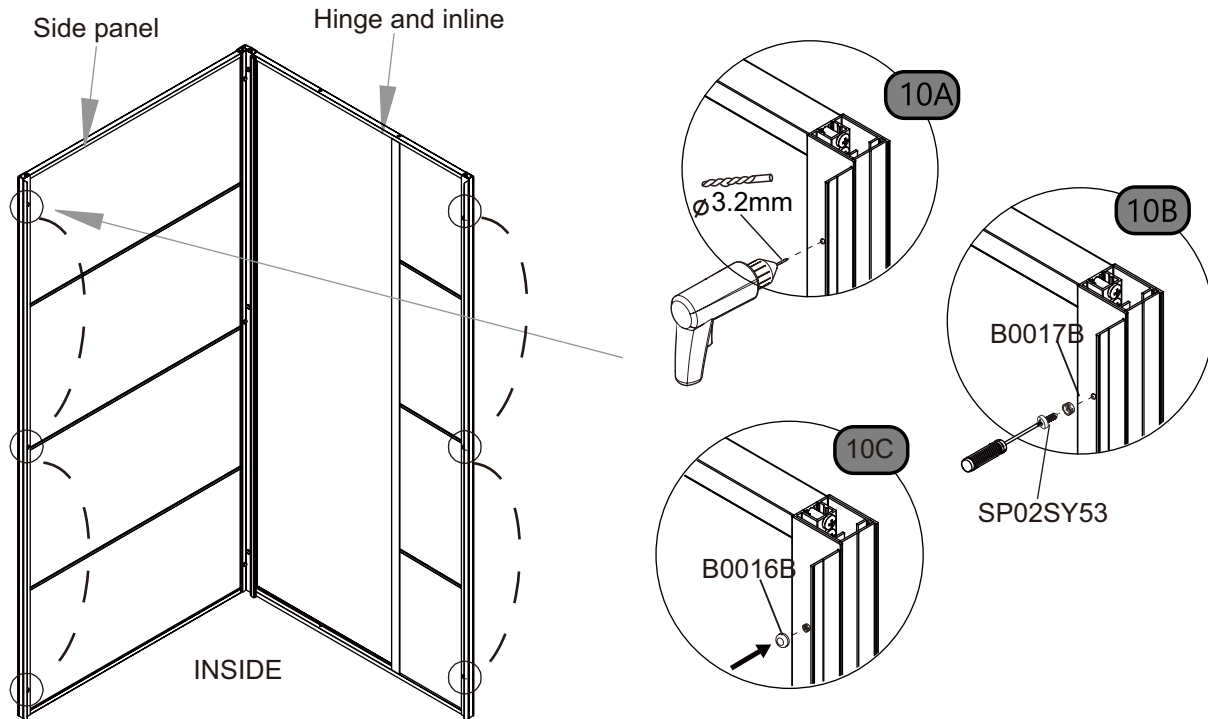

11

11A Install the hinges into the moving panel.
11B Add a dab of silicone to each end of the B0015B bottom seal and push vertically into the channel on the underside of the door profile.

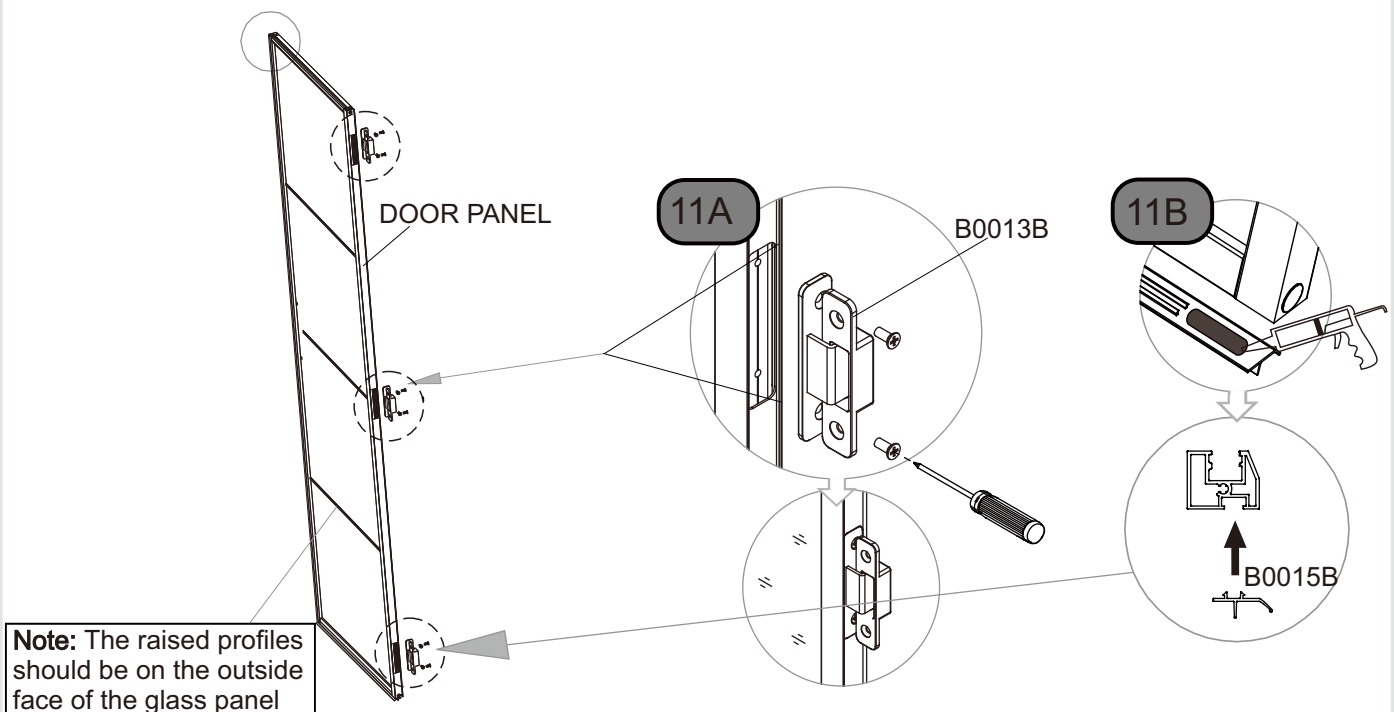

12

12A Offer up the door to the fixed profile - beginning at the top, install the hinges into each cavity of the fixed panel vertical profile and secure with hinge screws provided.

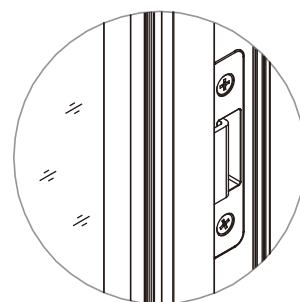
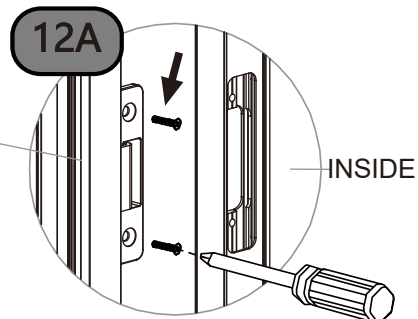
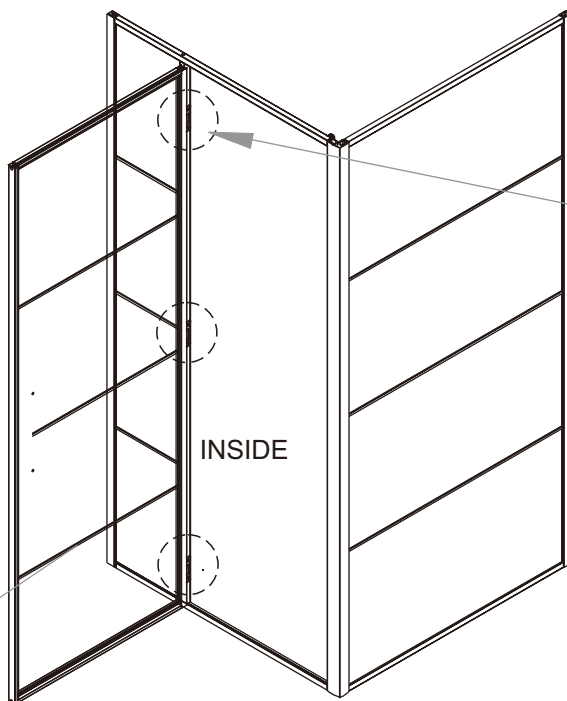

Note: The raised profiles should be on the outside face of the glass panel

13

Install the L shape gasket on the underside of the top profile.

13A For W900mm size enclosure cut 100mm off the length of the L shape gasket to fit.

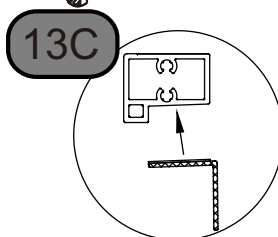
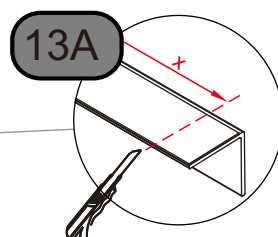
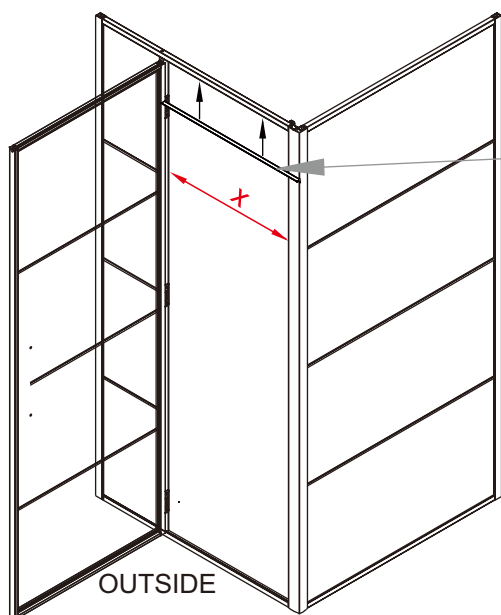

Note: Fix with the L shape to the inside

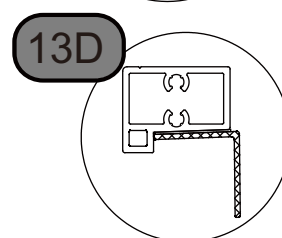
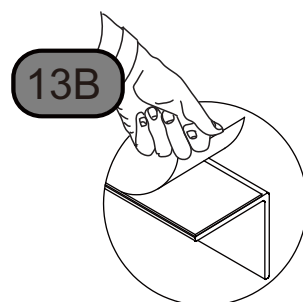

14

Install the handle onto the door using PVC washers provided. From the inside of the enclosure screw into the front handle, slide on the inside handle and fix with grubscrews with allen key provided.

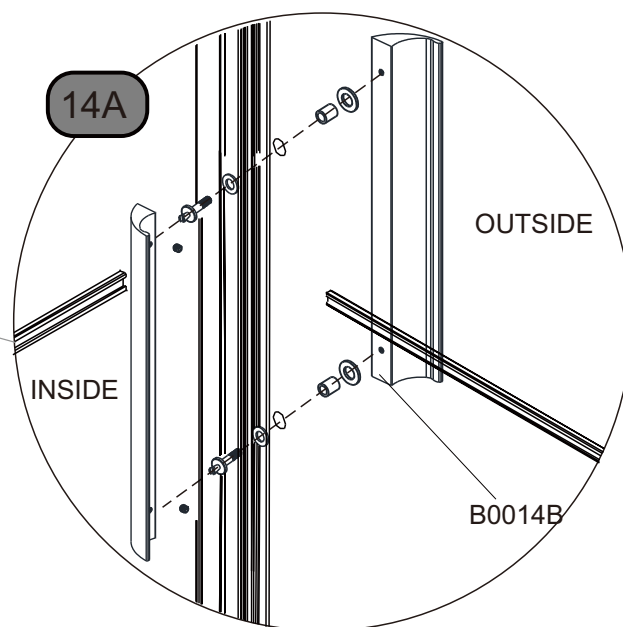
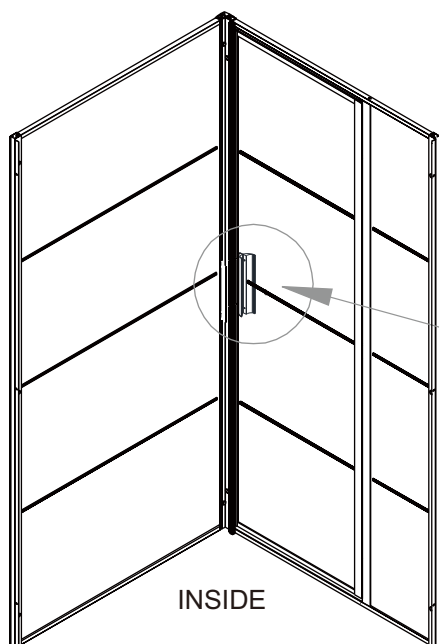

15

Use a good quality anti-bacterial neutral cure silicone to seal the shower enclosure as shown below. Please be sure to wait 24hrs before use.

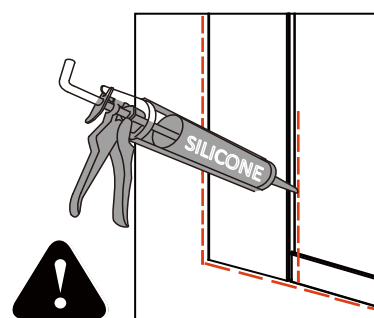
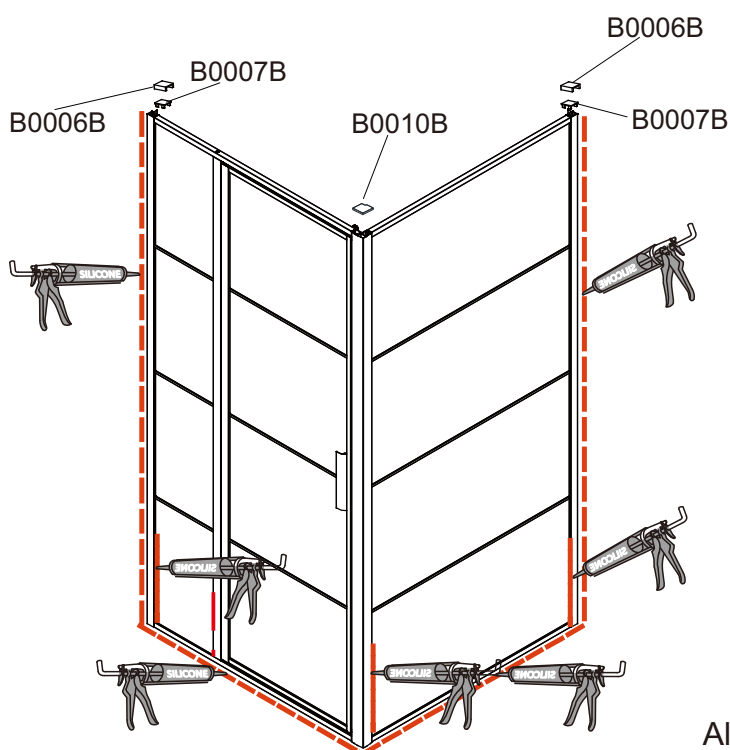

All sealant should be applied to the outside. Seal top to bottom between the wall profile and the wall. Seal the bottom between the tray/floor and the glass/rail/profile and approximately 50mm vertically between the wall profile and the glass.



Allow 24 hours for silicone to dry before use.

To download the Declaration of Performance (DOP) for this product use the link below.

<http://merlynshowering.com/aftersales-support/dop-certs/>

For further information contact IRL: 056 7791 888, UK: 0808 1011 429