

Hinge Door & 2 Inline Panels With Side Panel

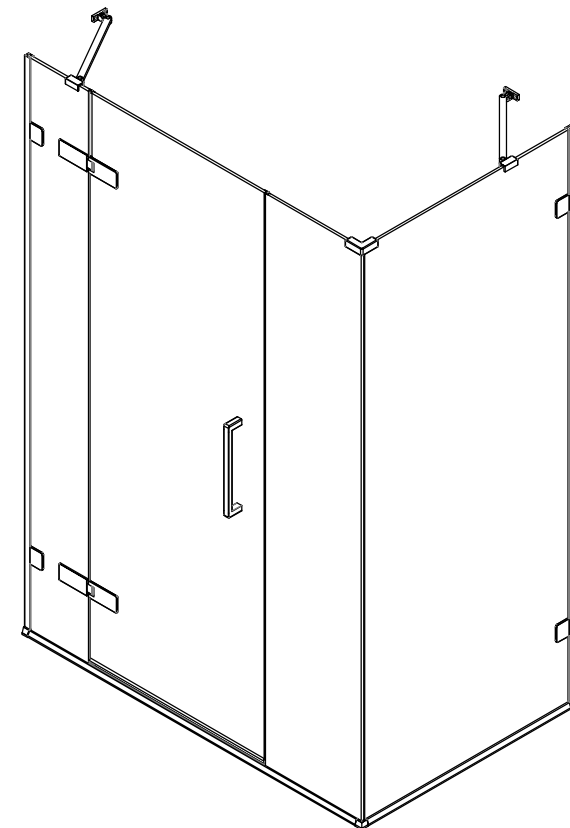

INSTALLATION GUIDE

www.merlynshowering.com

CE	
Merlyn Industries Ltd (MER01)	
20	
EN 14428	
Declaration of performance number CEARH1.2	
Shower enclosures with aluminium profiles and safety glass	
Cleanability	: Pass
Impact resistance/ shatter properties	: Pass
Durability	: Pass

MERLYN

Merlyn Showering
Unit 8, Purcellsinch Industrial Park,
Dublin Road, Kilkenny, Ireland.
Tel: 00353 56 779 1555
Fax: 00353 56 779 1576
www.merlynshowering.com

To download the Declaration of Performance (DOP) for
this product please use the link below.
<https://merlynshowering.com/aftersales-support/dop-certs/>

IMPORTANT: Please read the complete instructions before commencing fitting.

Make sure the tray is 100% level in all directions.

Check that you have the tools required.□

Check the installation site is compatible with the sizes of door supplied.□

Check all the enclosure components are present.□

Check the installation kit is complete.□

Do Not attempt to install the product unless you can tick all 4 boxes satisfactory.

The wall plugs supplied with the installation kit are for use in solid walls. Hollow or 'stud partition' walls will require alternative fixings. Please consult a hardware supplier for the correct type.

ATTENTION: TAKE EXTREME CARE WHEN HANDLING GLASS, WEAR PROTECTIVE EYEWEAR AND CLOTHING. DO NOT LEAVE THE GLASS ON HARD SURFACES AND AVOID CONTACT BETWEEN THE GLASS EDGES AND HARD SURFACES OR IMPACTS DURING THE INSTALLATION.

Fixing kit components



AC34
x1



AC35
x1

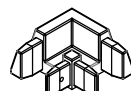

AC36
x1



MGST5X65
x8



MG8x51PLUG
x8

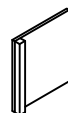

MGVC45
Installation tool
x1

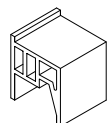

AC25SPACER
x2

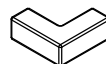

AC06
x1



AC13
x4



Cover cap
x4



AC14
x 2



Spacer
x 2



A06S0046
x2

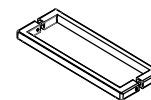

AC07
x1



8S1300511
x1

SP010SP281000

x1

Door assembly tool

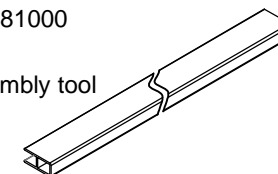

AC10

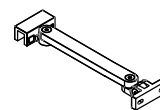

Bracing bar
x2



Clamp
cover cap
x4



Wall bracket
cover cap
x4



Wall plug
x4



4x30 screw
x4



4mm Hex key
x2

Tools required



PH2

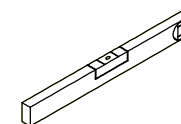

Ø6&8



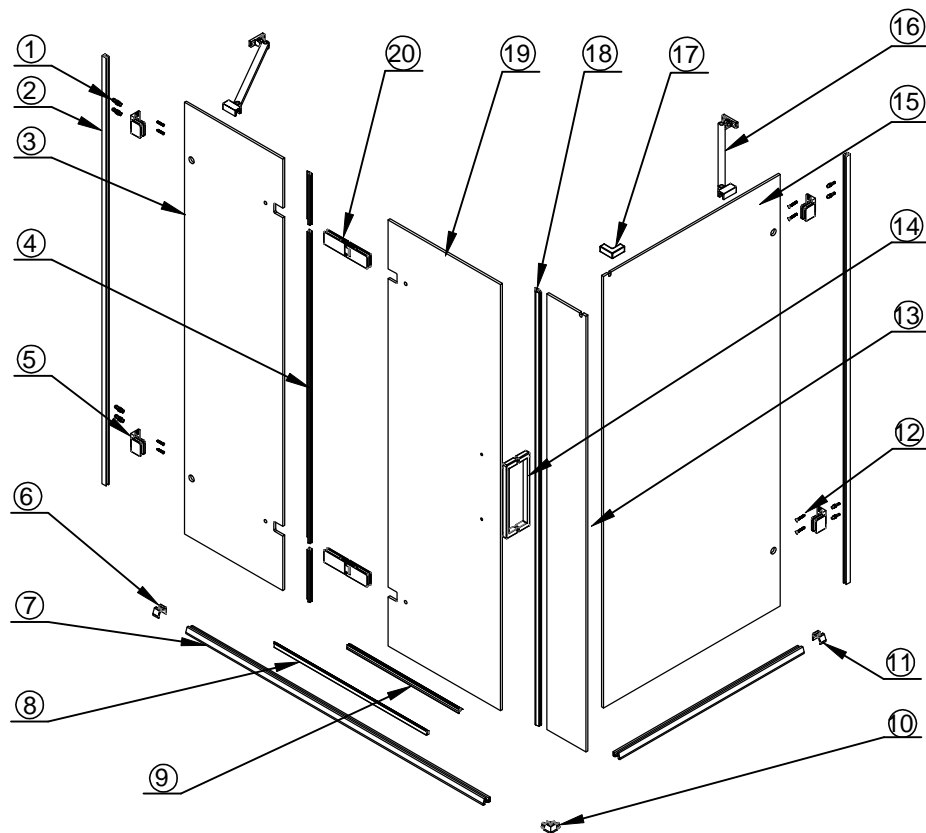

No.	QTY	Part No.	No.	QTY	Part No.	No.	QTY	Part No.
①	8	MG8x51PLUG	⑧	1	AC03SL/AC04SL	⑮	1	GHSA
②	2	AC01	⑨	1	MGVC30A	⑯	2	AC10
③	1	GMGHFB	⑩	1	AC36	⑰	1	AC06
④	1	MGVC44LSET/RSET	⑪	1	AC35	⑱	1	MGVC33A
⑤	4	AC13	⑫	8	MGST5X65	⑲	1	GMGDPC
⑥	1	AC34	⑬	1	GMGCPB	⑳	2	AC14
⑦	2	AC37	⑭	1	AC07			

Step 1

IMPORTANT!

Whether fitting on a tray or on a tiled Wetroom the tray or floor must be 100% level!

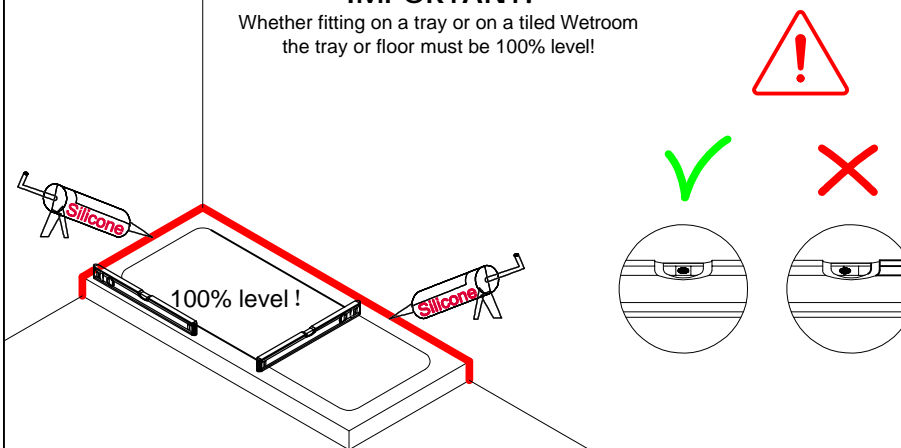

Step 2

Assemble the bottom track, corner bracket and end brackets on the tray. The gap between the ends of the track and the inside edge of the end bracket must be between 0 - 15mm, adjust the position of the track (A) until the gap at both ends is within this range.

Attention:

- Make sure there are no gaps between the wall and the end brackets, and between the corner bracket and the track.
- Make sure the track is parallel to the edge of the tray.

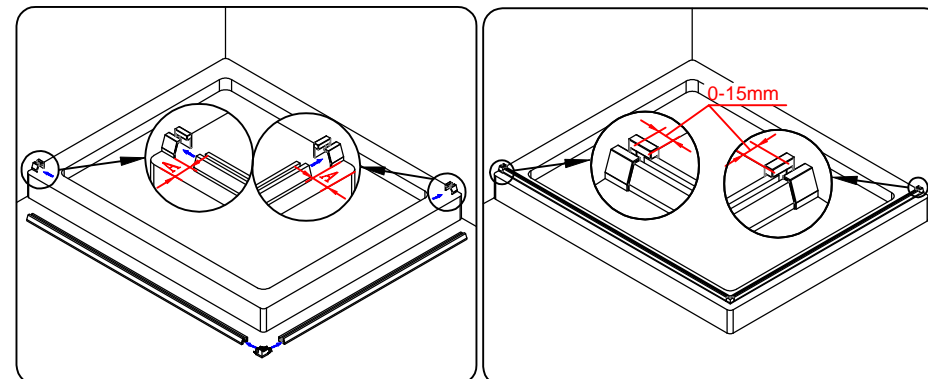

Step 3

Before assembling the brackets make sure panels are orientated the correct way. Measure hole centres from top and bottom to determine correct orientation of panel.

Note the differences between the hinged fixed panel (has notch cuts for hinge) and the side fixed panel (no notch cuts).

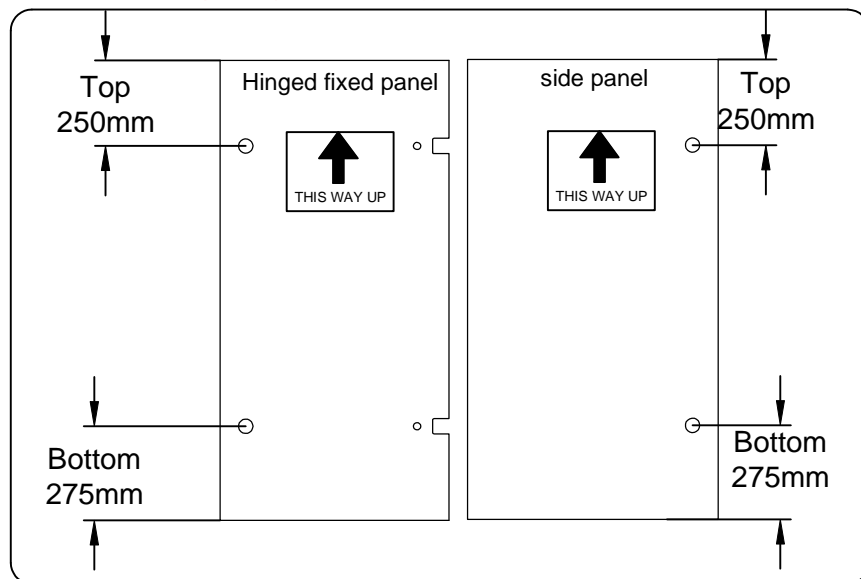

Step 4

Push on wall profile completely ensuring end is flush with the top of the glass panel.

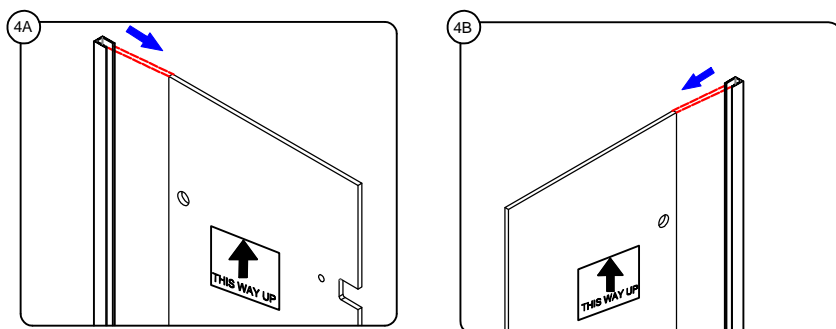

Step 5

Fix the wall brackets making sure to have the wall bracket in the center of the hole in the glass.

IMPORTANT ! This is critical as it is where the panel adjusts. If the brackets are not positioned in the center adjustment will be affected.

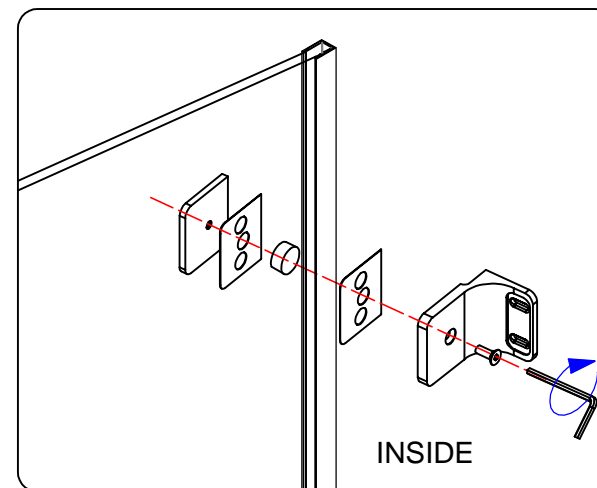

Step 6 Lift the assembled panel into the track. Plumb the panel and mark the centre of each slot.

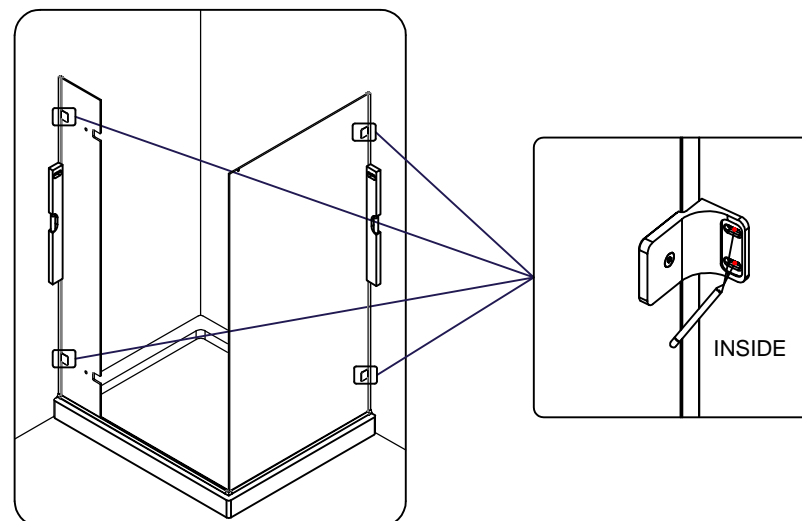

Step 7

Remove both fixed panels and the bottom track, then drill holes with 8mm diameter masonry bit and insert wall plugs. Ensure the wall plugs are flush with the tile.

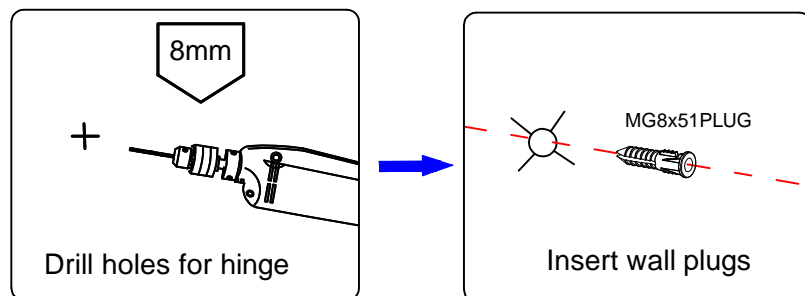

Step 8

Place the assembled bottom track back on the tray and place the inline panel into the track. Fix wall brackets. Do not fully tighten, leave enough slack for adjustment. Secure the top bracket first.

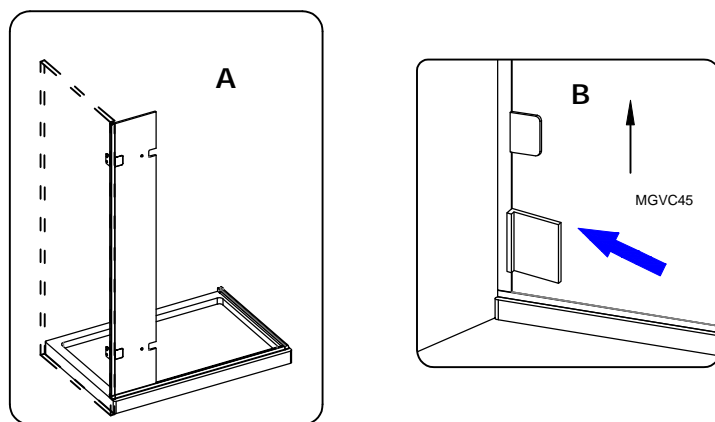

Step 9

- (A) Insert guide spacer to front corner of the track.
- (B) Fit side panel front corner first making sure edge of panel with 3M tape is tight to guide spacer.
- (C) Fit the inline panel and check all panels for level.
- (D) Fully tighten screws to the wall.

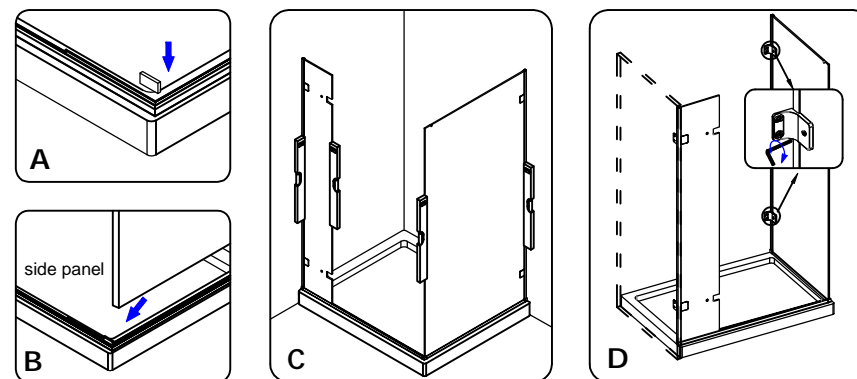

Step 10

Before fitting the front inline panel to the side panel make sure the notch in the glass is to the top and on the side closest to the side panel. Clean the inside of the inline panel (area that will receive the 3M tape).

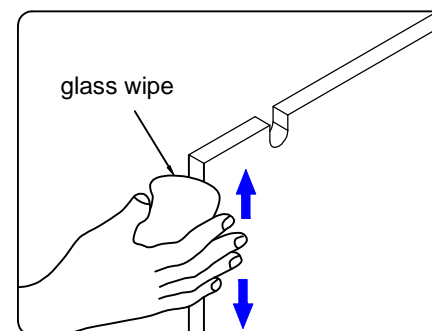

**Attention: 3M adhesive tape is single use only.
You will have just 1 attempt to fit panels.**

Step 11

11A Place bottom of panel into front track ensuring outside edge of inline panel is flush with the outside face of return panel.

11B Before you peel off the protective strip from the tape dry fit the panels ensuring outside edge of inline panel is flush to outside face of side panel.

11C Lean inline panel away from fixed side panel and peel off protective strip. Guide inline panel back to position ensuring panels are flush.

Tip: place a level along face of side panel and use as a guide to locate inline panel.

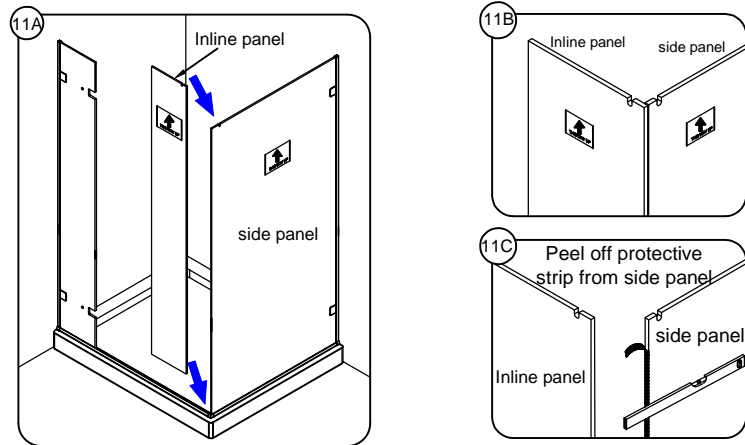

Step 12

Loosen grub screws on corner bracket and push firmly into position. Fully tighten grub screws once in position.

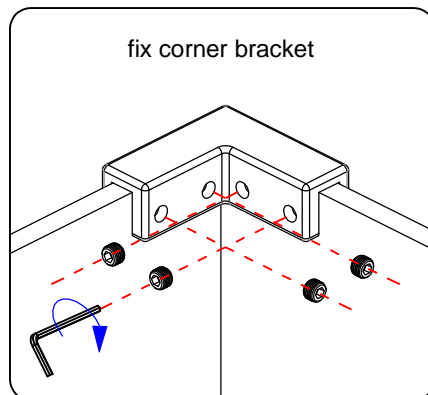

Step 13

Fit hinges to inline panel ensuring that the part of the hinge which has a notch will be on the moving panel side.

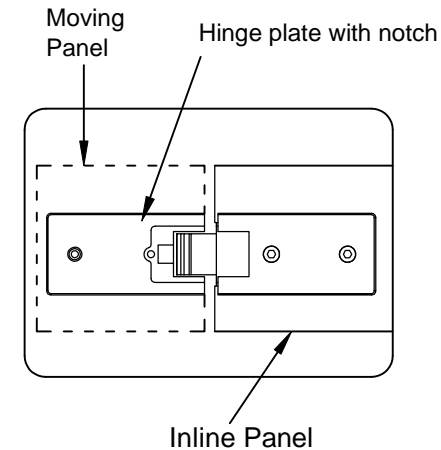

To help align the hinge, place the 2mm clear PVC spacer under the hinge on the edge of the cutout.

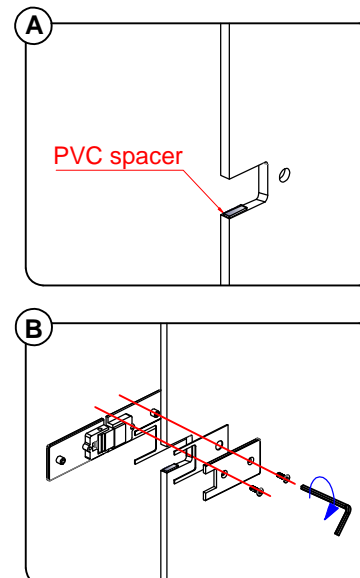

Tip: Use MDF tool for squaring hinges.

Remove back plates from hinges on moving panel side and place hinge plate, washers, bolts and hex key inside enclosure.

Step 14

Check door opening at bottom and make sure that the distance at the top is the same.

Gap top and bottom
should be width of
moving panel +12mm

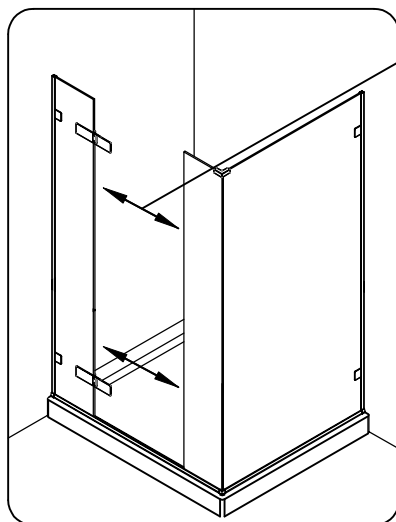

Fully tighten bracket to glass
on the inline panel.

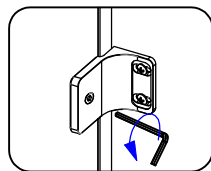

Step 15

Place locating aids and spacers on threshold, one each side of opening.

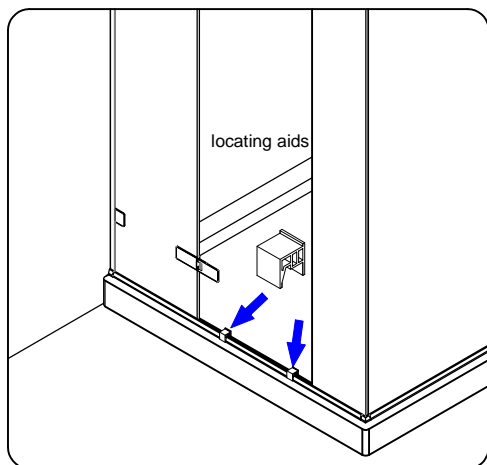

Step 16

Lift door onto positioning aids, and retain door into position using top holding strip.

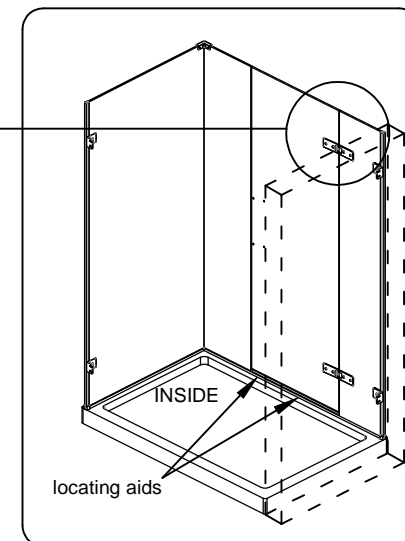
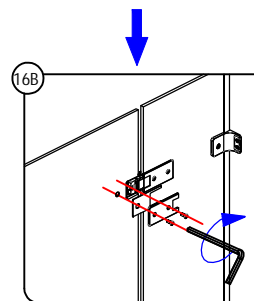
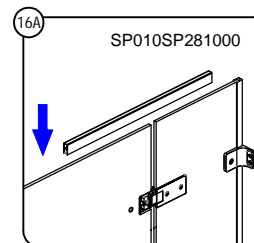

Step 17

Loosely fix back plate to hinges ensuring washers are in position and hinges are level.

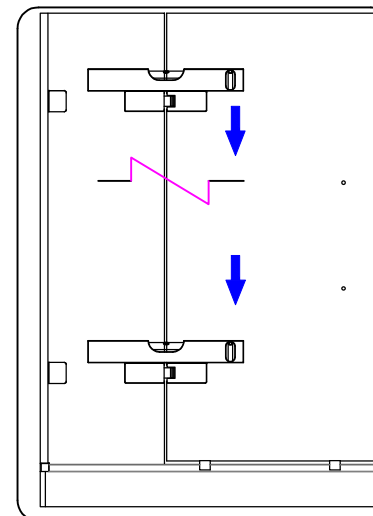

Step 18

Ensure gap between both glass panels is equal top and bottom, then fully tighten hinge bolts.

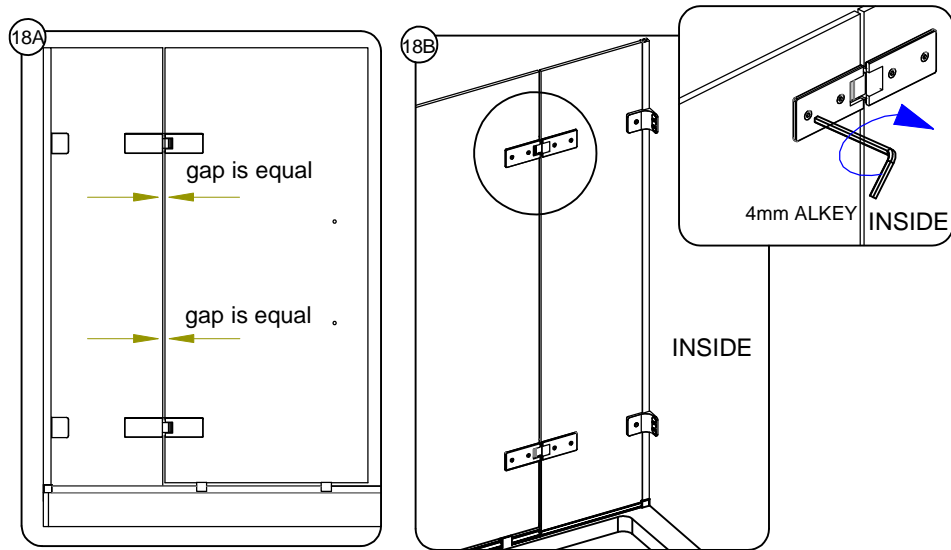

Step 20

Left and right hand seal kits (A) are provided, determine handing and use appropriate seal kit. Left hand model shown below.
Push on longest seal between hinges onto back edge of moving panel.
Take shortest seal and fit to top keeping notch to hinge. Repeat with longer bottom seal.
Fit closing seal (B) to edge of the inline panel. Make sure to keep fin to the inside.

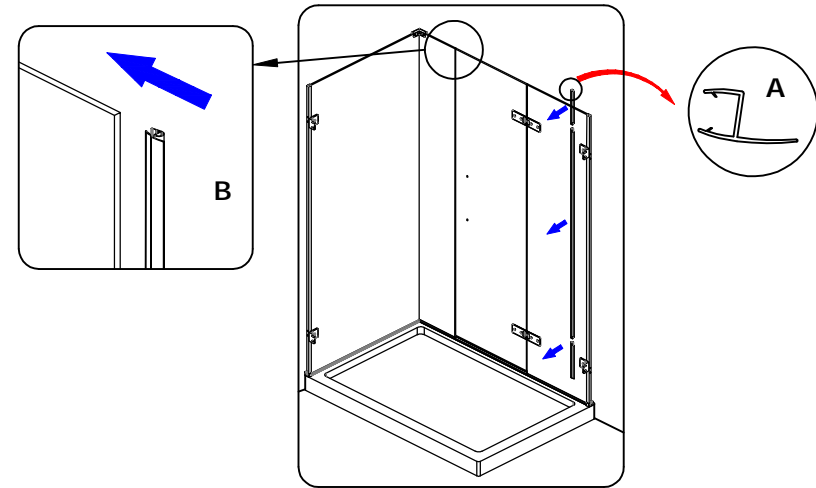

Step 19

Remove top holding strip. To remove door positioning aids open door outwards. When positioning aids have been removed check gap beneath door is even. If gap is not equal loosen hinges slightly and adjust.

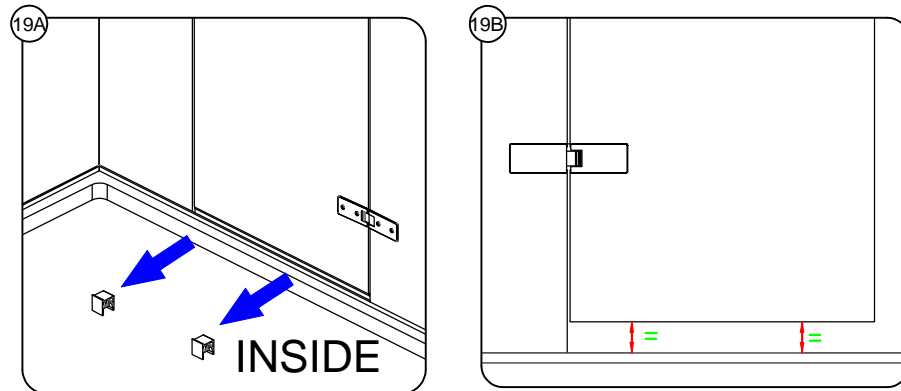

Step 21

Fit bottom door seal keeping longest fin to inside. Notch fin where it meets the closing seal to ensure door closes fully.

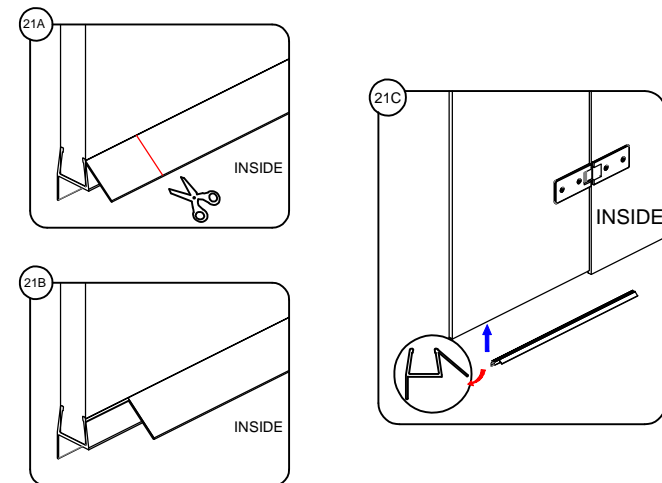

Step 22

Measure between the edge of the inline panel and the inside edge of the side panel and cut the infill seal to this length.

Apply a dab of silicone to both ends, insert to bottom profile. Note: The vertical fin should be positioned to the front of the enclosure.

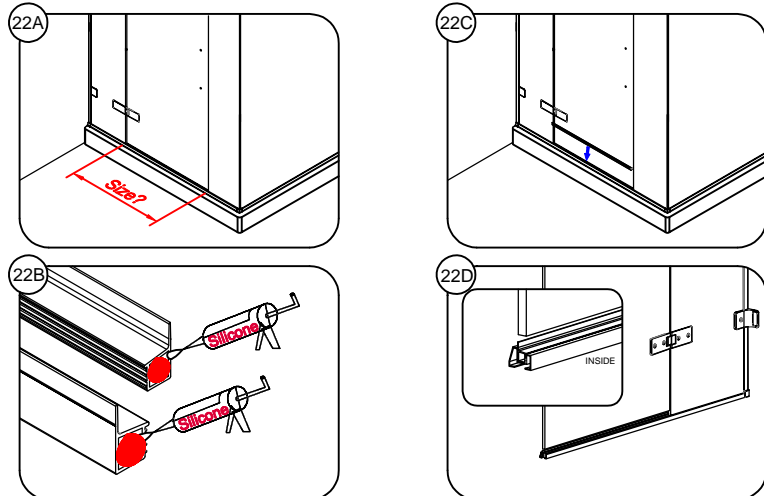

Step 24

Fit the handle to the door.

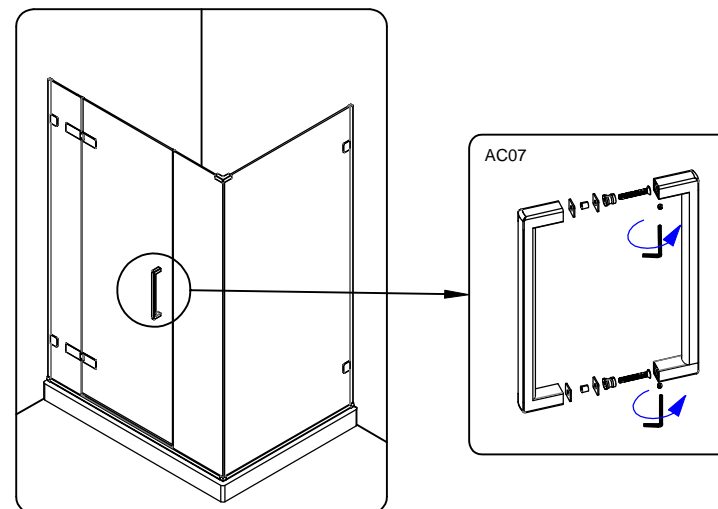

Step 23

Make sure there is no gap between the edge of the glass and the bottom seal.

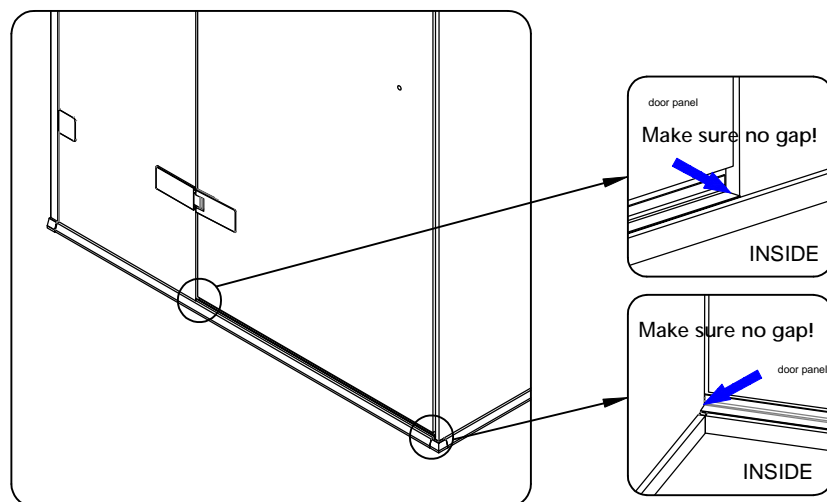

Step 25 Fix the top rails.

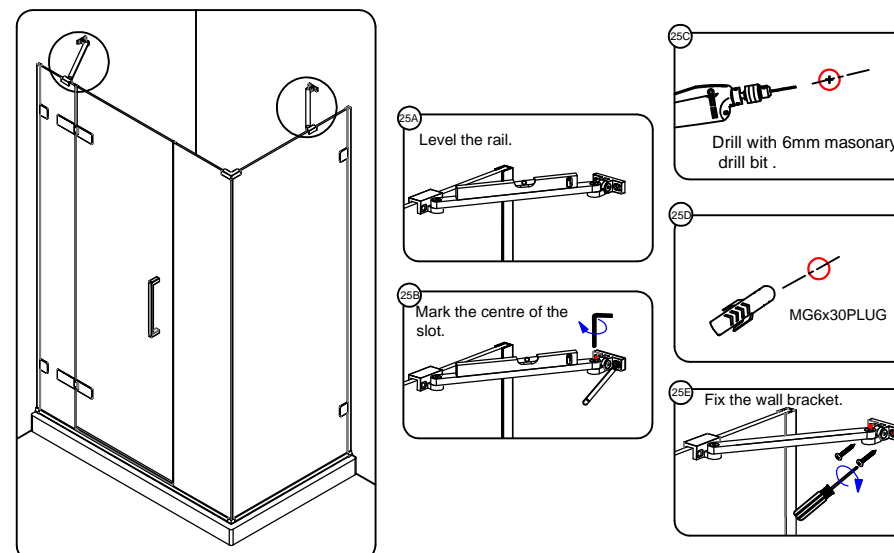

Step 26 Door adjustment

To adjust door to get required contact against closing seal first support door with door locating aids. Loosen all bolts fixing both hinges to glass and move by required amount. Tighten all bolts and remove door positioning aids.

Step 27

Where an angled bracing bar is fitted additional adjustment can be made by:

- 1) Loosen the 3 screws clamping the glass.
- 2) Move the glass panel in the direction required (see arrow).
- 3) Tighten the 3 screws.

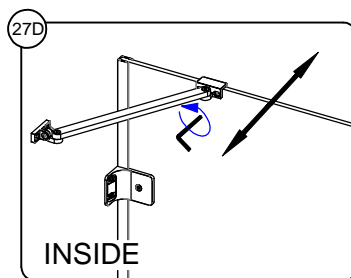
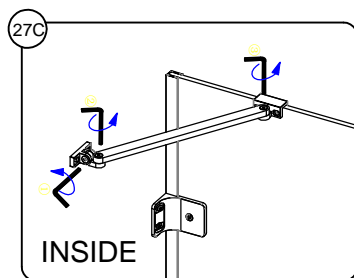
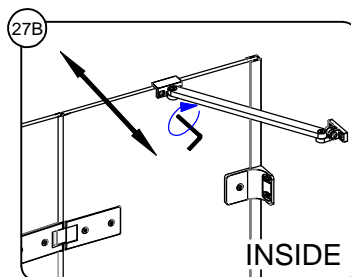
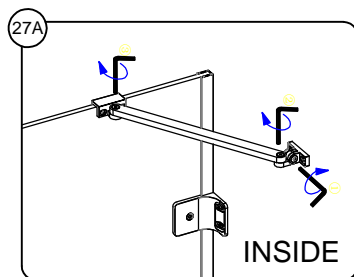

Step 28 Adjusting fixed panels

If after fitting you still need adjustment to align doors etc, you can achieve this by loosening the screws fixing the bracket to the wall and the bolts clamping the bracket to the glass.

Adjust the panels until the desired fit is achieved. Fully tighten all fixings.

Note: If no further adjustment is needed make sure all fixings have been tightened securely. ⚠

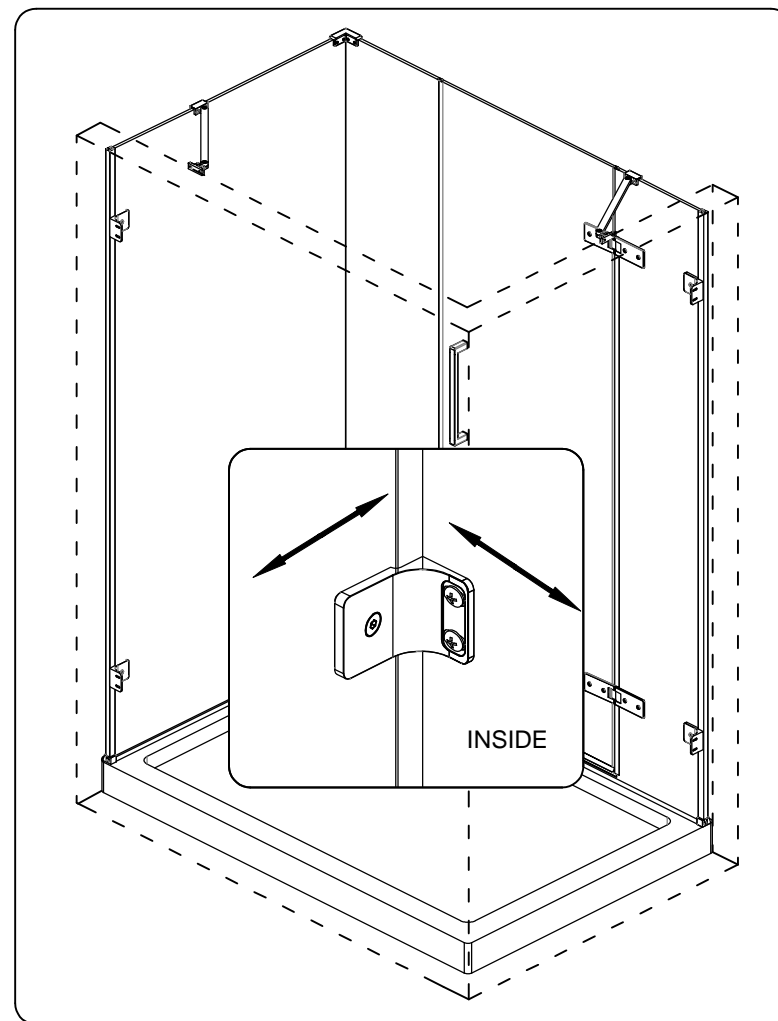

Step 29 Fitting cover caps.

Peel off protective strip to adhesive tape to back of cap and firmly press in position.

Tip: We recommend that you place a dab of silicone to the back of the cover caps at each end of the tape.

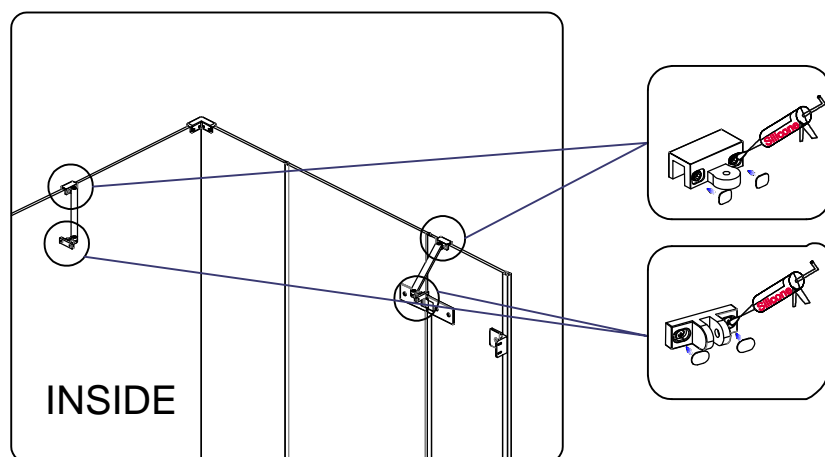
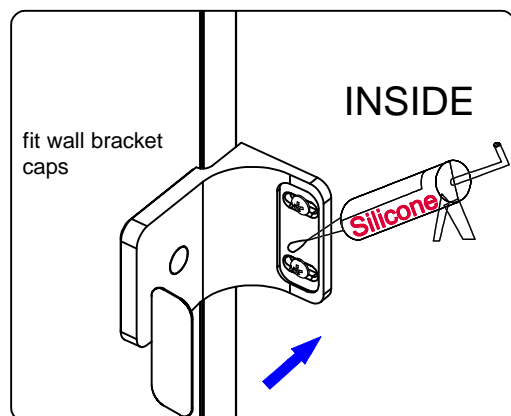

Step 30 Sealing your enclosure.

Make sure all surfaces are thoroughly cleaned and dry before applying sealant.

Only seal the outside of the enclosure (red line). Do not seal the inside.

Seal vertically along the wall, along the outside edge of the bottom profile and any joins in the profile, including where the bottom track meets the end brackets.

