

MERLYN

6|series sleek

## BIFOLD DOOR

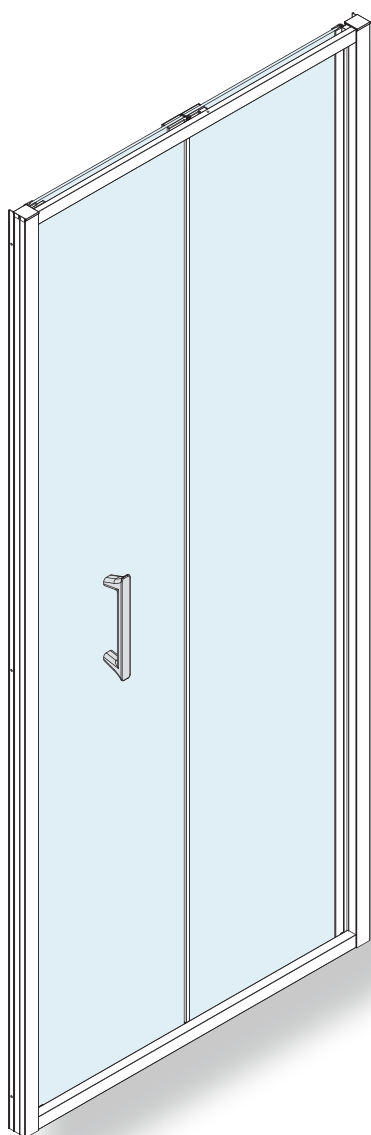

Pages 2-7

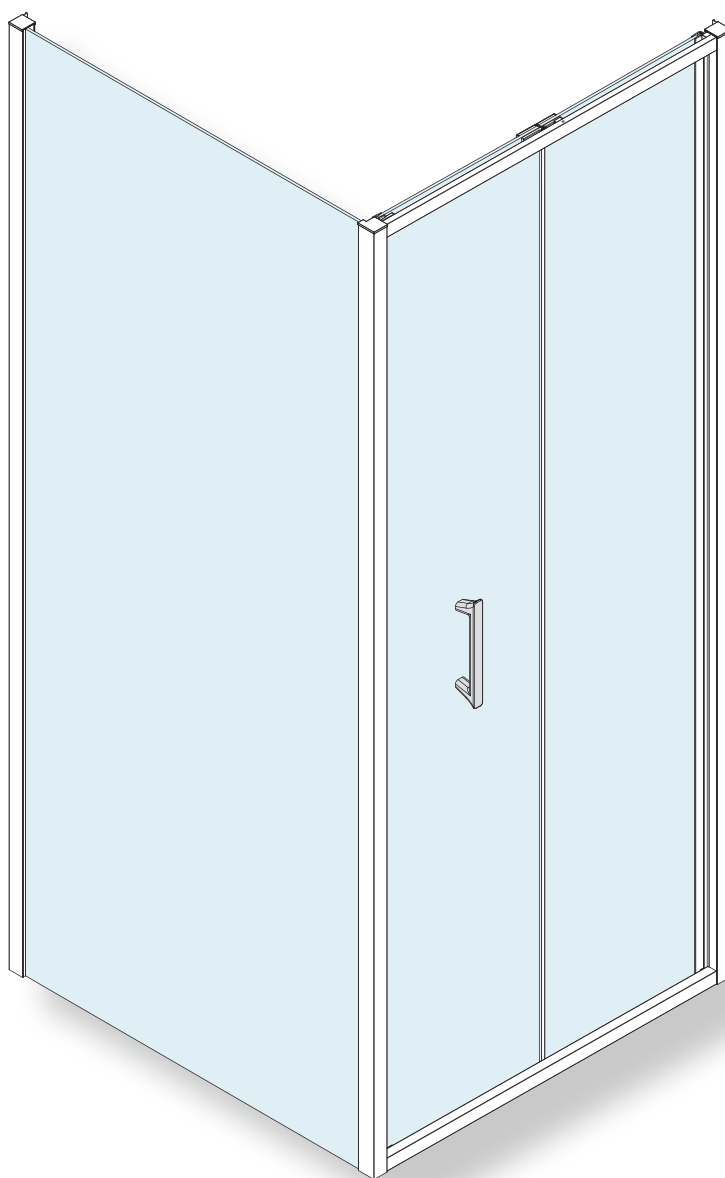

Pages 8-13

## INSTALLATION GUIDE

## **IMPORTANT:**

**Please read the complete instructions  
before commencing fitting.**

Make sure the tray is 100% level in all directions.  
Do Not attempt to install the product unless you  
can tick all 4 boxes satisfactorily.

- Check that you have the tools required ☐
- Check the installation site is compatible with  
the sizes of door supplied ☐
- Check all the enclosure components are present ☐
- Check the installation kit is complete ☐

The wall plugs supplied with the installation kit are  
for use in solid walls. Hollow or 'stud partition'  
walls will require alternative fixings. Please consult  
a hardware supplier for the correct type.  
It may also be necessary to consult your tiling sup-  
plier about the correct method for drilling  
your tiles.

**ATTENTION: TAKE EXTREME CARE WHEN  
HANDLING GLASS, WEAR PROTECTIVE EYEWEAR  
AND CLOTHING. DO NOT LEAVE THE GLASS ON  
HARD SURFACES AND AVOID CONTACT BETWEEN  
THE GLASS EDGES AND HARD SURFACES OR  
IMPACTS DURING THE INSTALLATION.**

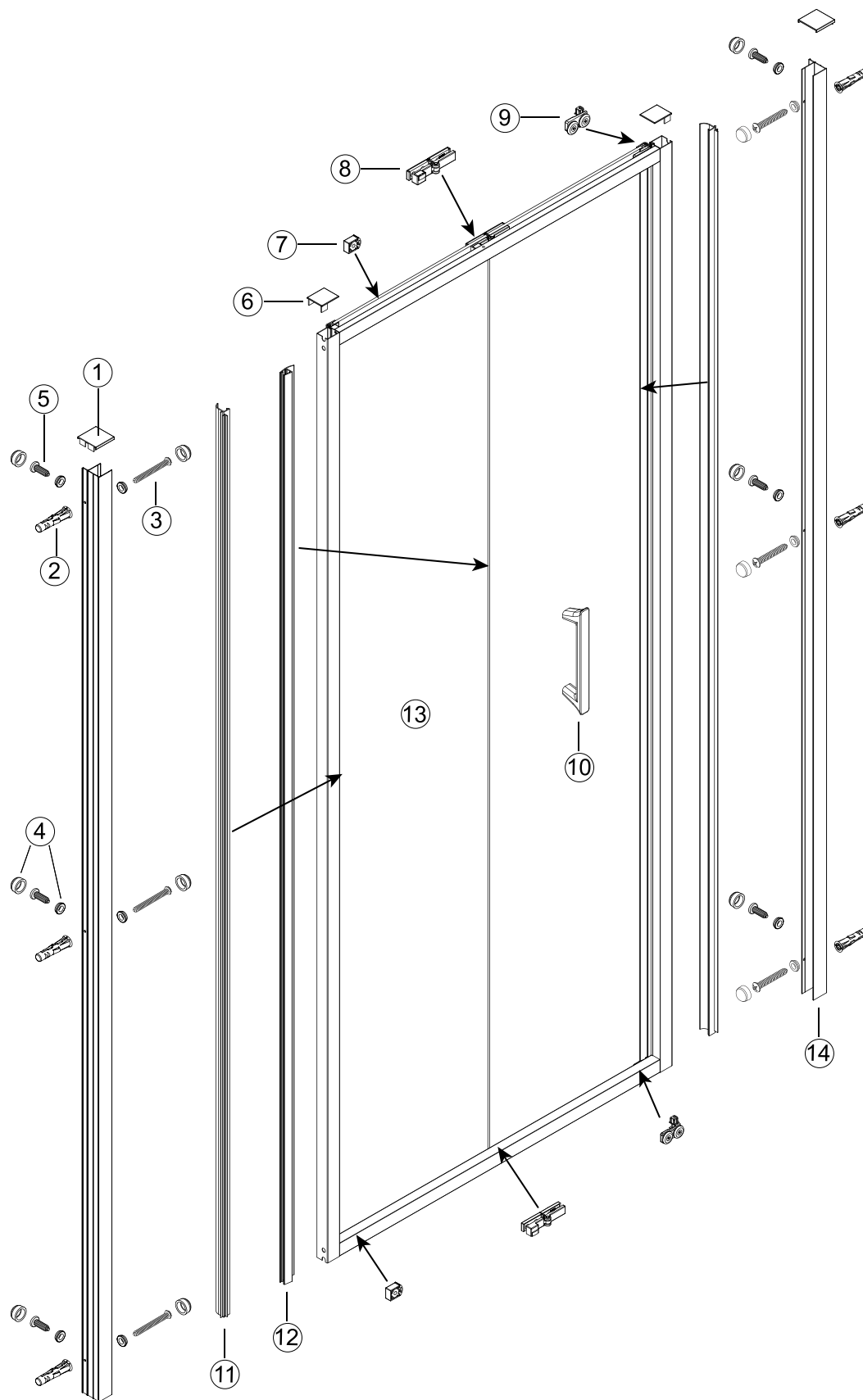

No.	QTY	descriptions	Part number	No.	QTY	descriptions	Part number	No.	QTY	descriptions	Part number
①	1	Wall profile cover cap	SP0SS6026	⑥	2	Frame cover cap	SP0SS6027	⑪	2	Frame upright seal	SP0SS6019
②	6	Wall plug	A03S0090	⑦	2	Bifold bump stop	SP0SS6037	⑫	1	Middle upright seal	SP0SS6020
③	6	4x30 screw	A03S0089	⑧	1	Hinge set	SP0SS6042	⑬	1	Bifold Door	A
④	12	Screw cover cap & clip	SP0SS6028	⑨	1	Bifold roller set	SP0SS6041	⑭	2	Wall profile	SP0SS6003
⑤	6	4x10 screw	SP0V4110	⑩	1	Handle	SP0SS6029				

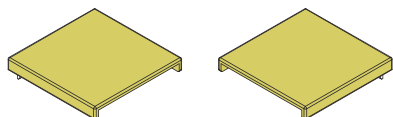
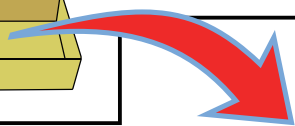
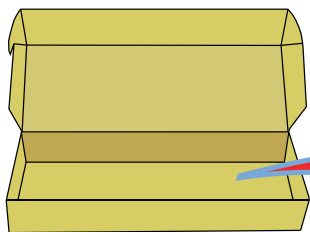

SP0SS6026  
X1

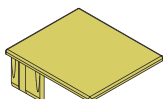

SP0SS6027  
X2

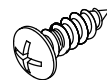

SP0V4110  
X6



SP0SS6028  
X12

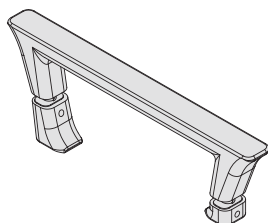

SP0SS6029  
X1

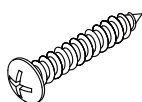

A03S0089  
X6

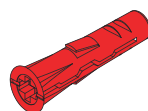

A03S0090  
X6

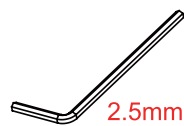

SP08S1300511  
X1

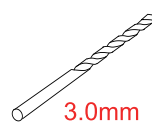

SP08S1301152  
X1

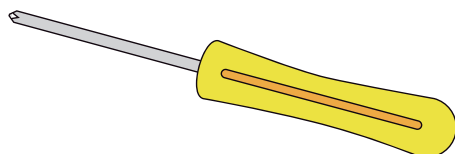
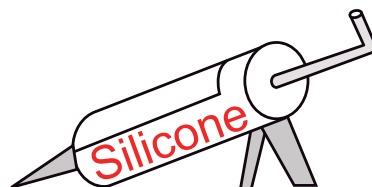
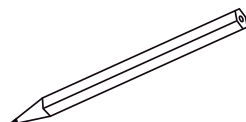
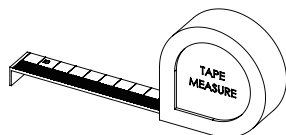
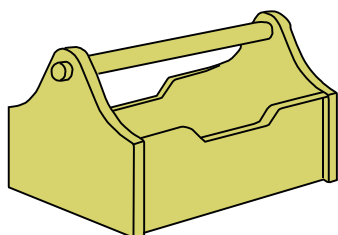

PH2

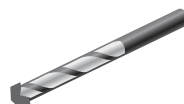
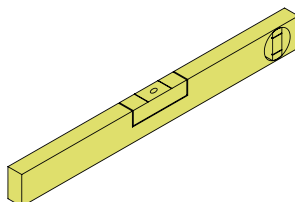

Ø6



1

Ensure the shower tray is level in all directions and is properly sealed to the wall. The wall must be tiled down to the top edge of the tray.

Do not angle out bottom tile.  
TRAY MUST BE LEVEL IN ALL DIRECTIONS!

TRAY MUST BE SEALED FULLY AROUND WHERE THE TRAY MEETS THE WALL.

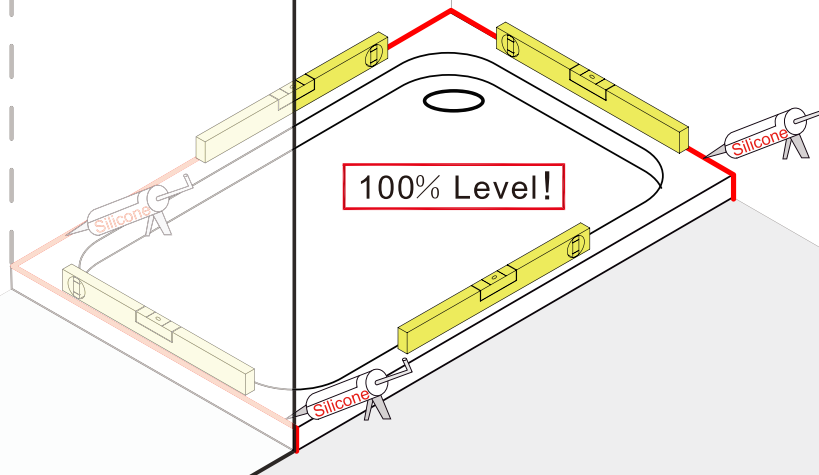
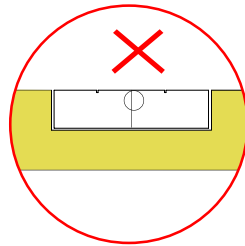
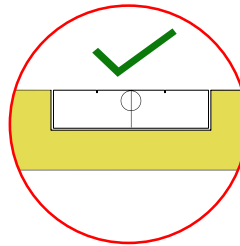

2

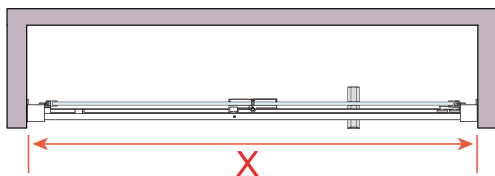

Size	X
760	710-750
800	750-790
900	850-890
1000	950-990

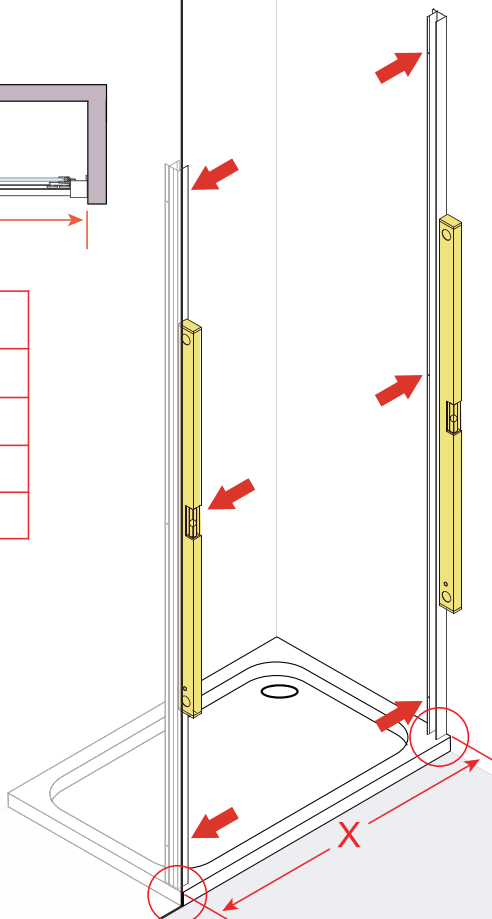
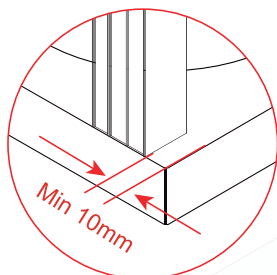

2A

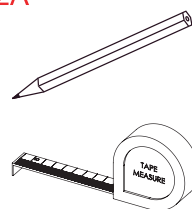

2B

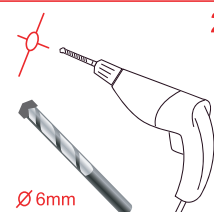

2C



3

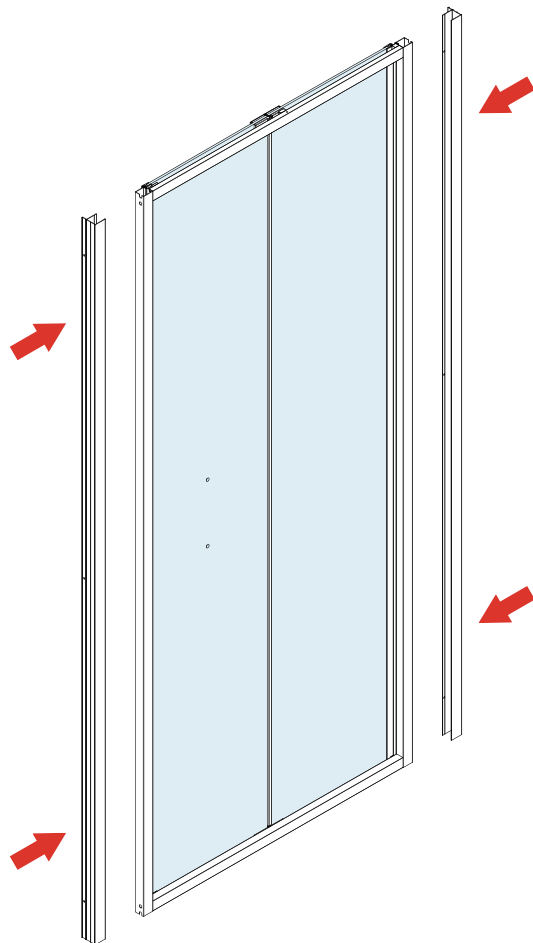

4

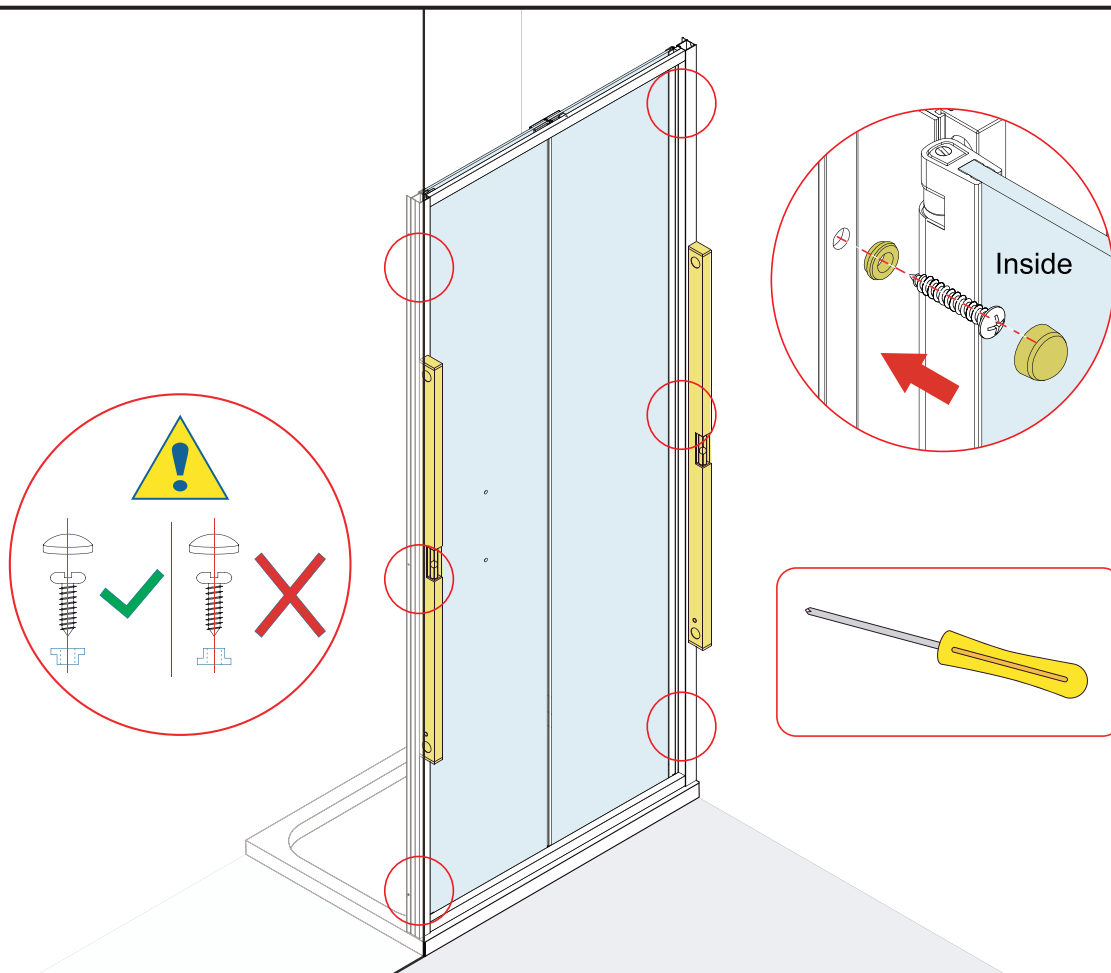

5

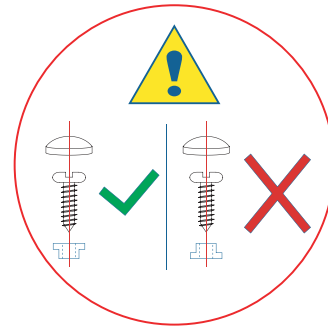
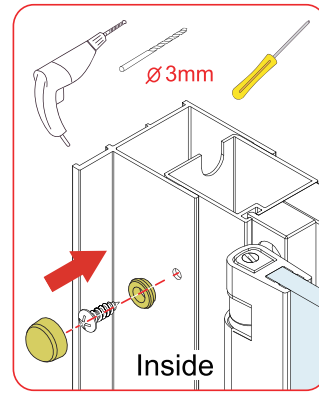
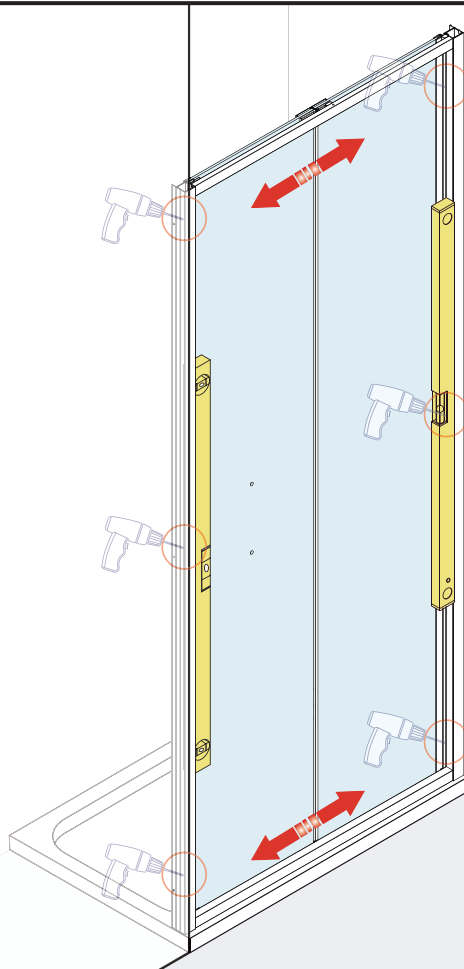

6

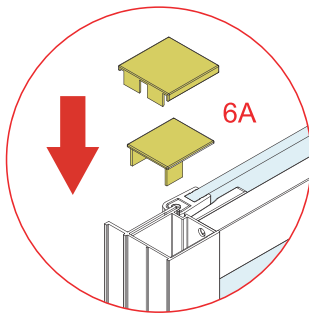

Note: The notched side of the top cap goes to the inside.

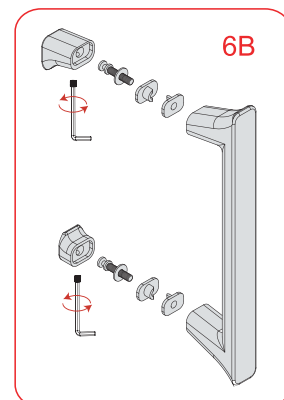
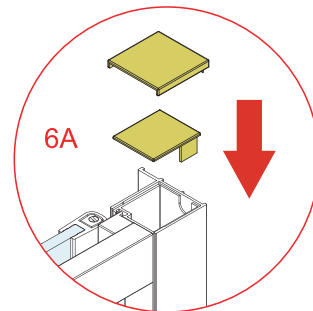
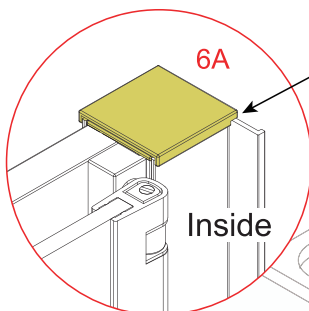

7

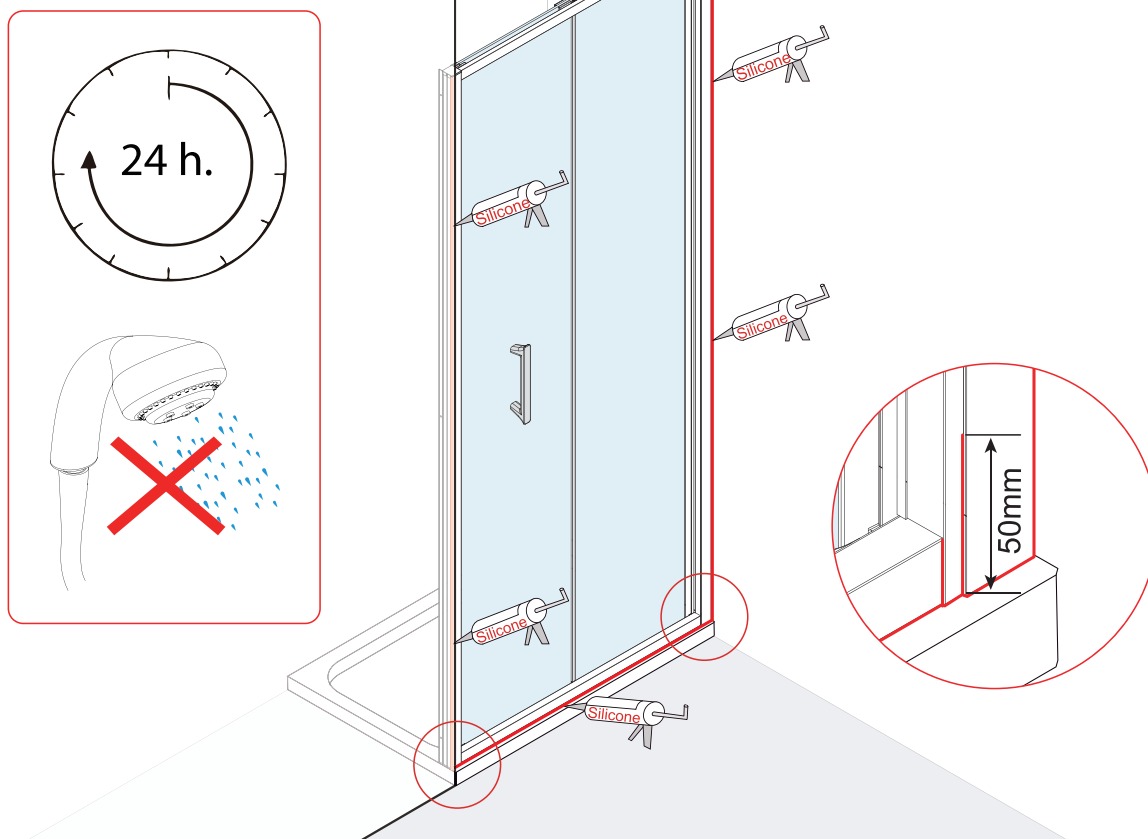



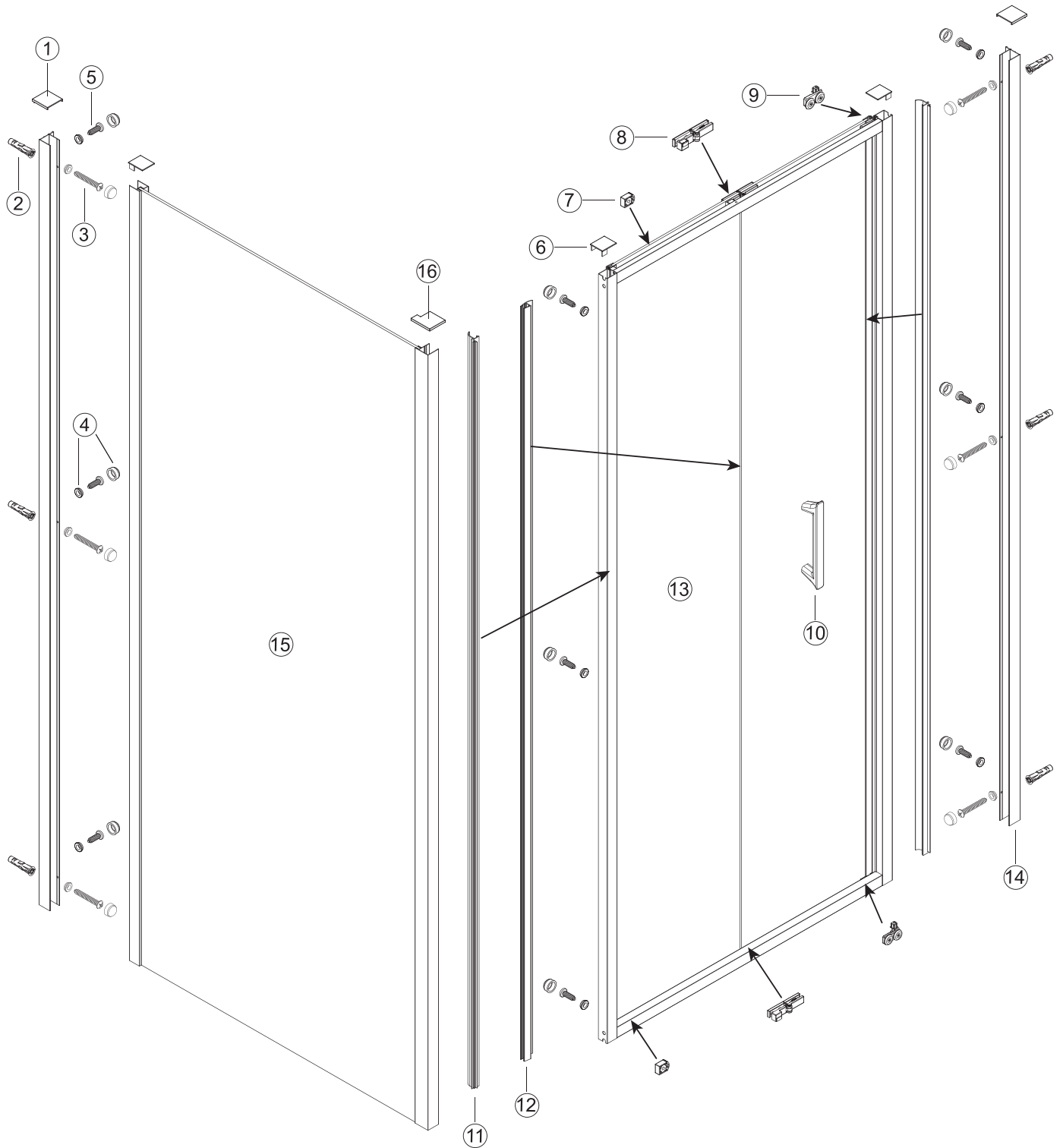

No.	QTY	descriptions	Part number	No.	QTY	descriptions	Part number	No.	QTY	descriptions	Part number
①	1	Wall profile cover cap	SP0SS6026	⑦	2	Bifold bump stop	SP0SS6037	⑬	1	Bifold Door	A
②	6	Wall plug	A03S0090	⑧	1	Hinge set	SP0SS6042	⑭	2	Wall profile	SP0SS6003
③	6	4x30 screw	A03S0089	⑨	1	Bifold roller set	SP0SS6041	⑮	1	Side Panel	B
④	15	Screw cover cap & clip	SP0SS6028	⑩	1	Handle	SP0SS6029	⑯	1	Corner post cover cap	SP0SS6030
⑤	9	4x10 screw	SP0V4110	⑪	2	Frame upright seal	SP0SS6019				
⑥	2	Frame cover cap	SP0SS6027	⑫	1	Middle upright seal	SP0SS6020				

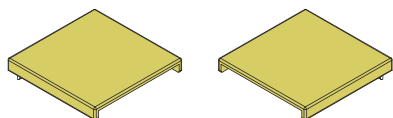
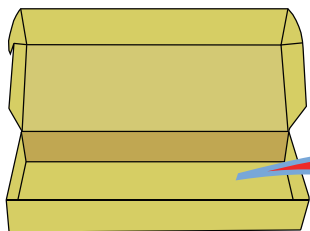

SP0SS6026  
X1

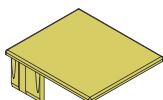

SP0SS6027  
X3

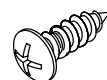

SP0V4110  
X9



SP0SS6028  
X15

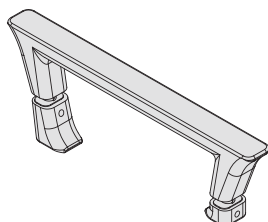

SP0SS6029  
X1

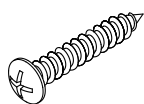

A03S0089  
X6

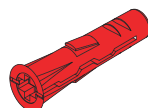

A03S0090  
X6

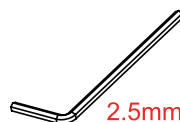

SP08S1300511  
X1

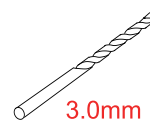

SP08S1301152  
X1

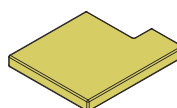
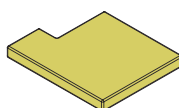

SP0SS6030  
X1

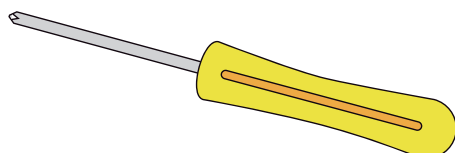
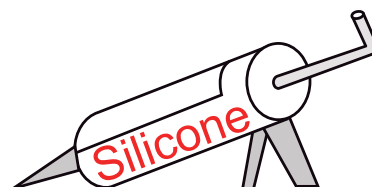
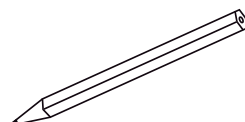
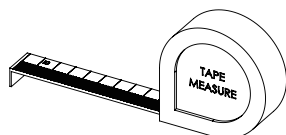
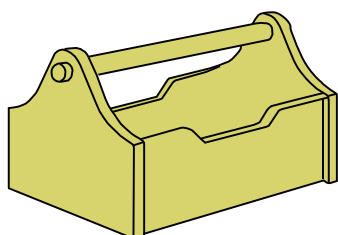

PH2

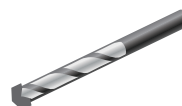
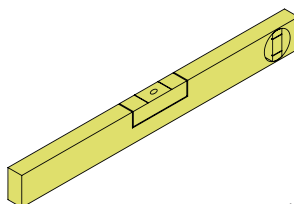

Ø6



1

Ensure the shower tray is level in all directions and is properly sealed to the wall. The wall must be tiled down to the top edge of the tray.

Do not angle out bottom tile.  
TRAY MUST BE LEVEL IN ALL DIRECTIONS!

TRAY MUST BE SEALED FULLY AROUND WHERE THE TRAY MEETS THE WALL.

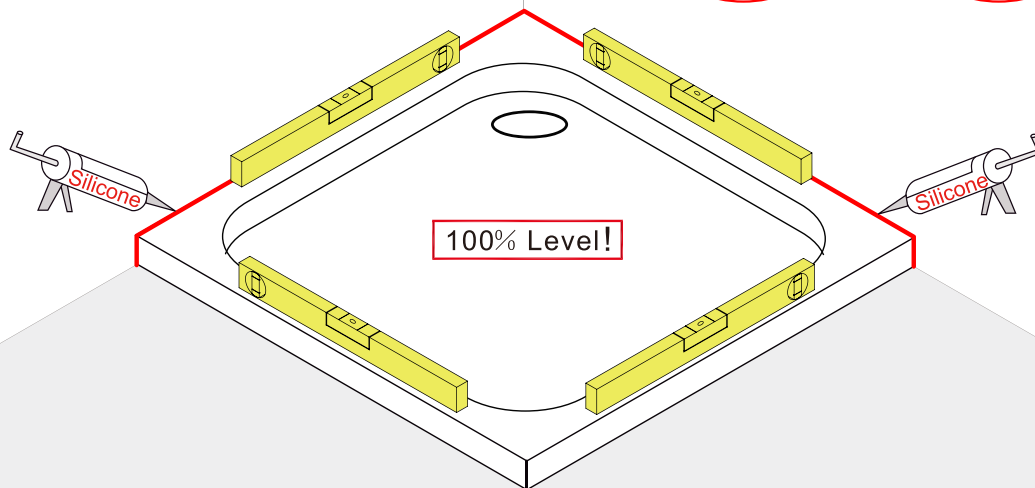
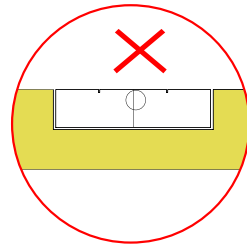
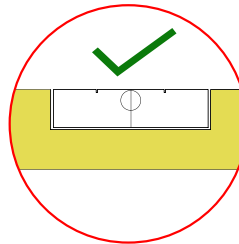

2

**NOTE:** Shown here with door fitted on right hand side. In this case X represents the adjustment range for the side panel profile. Y is the adjustment range for the door profile. If fitting the door on the left side then swap these around.

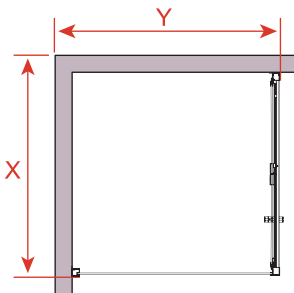

Size	X Side panel	Y Door
760		730-750
800		770-790
900		870-890
1000		970-990
1200		1170-1190
760	710-750	
800	750-790	
900	850-890	
1000	950-990	

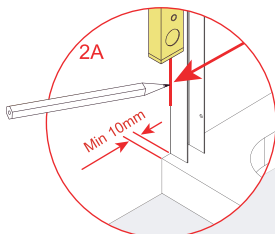

2A

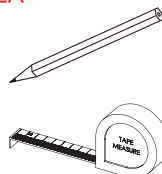

2B

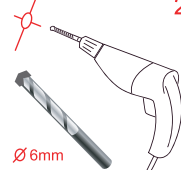

2C



2D

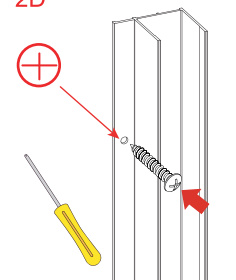

3

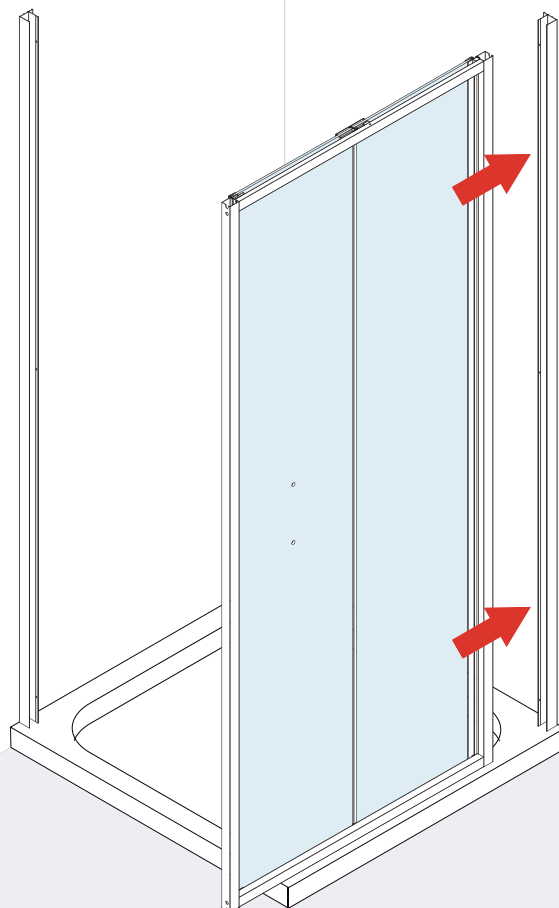

4

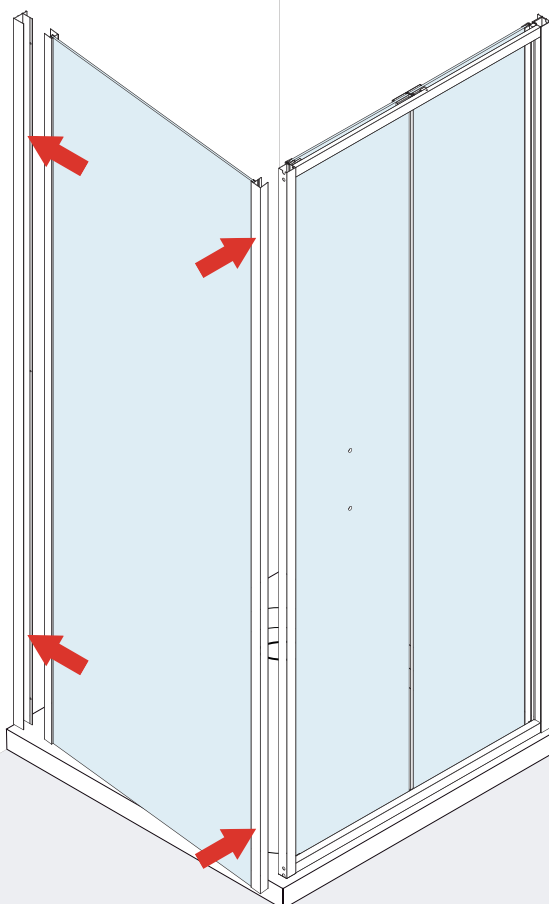

5

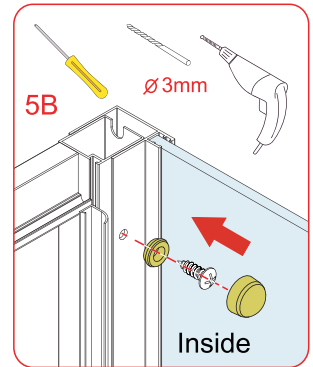
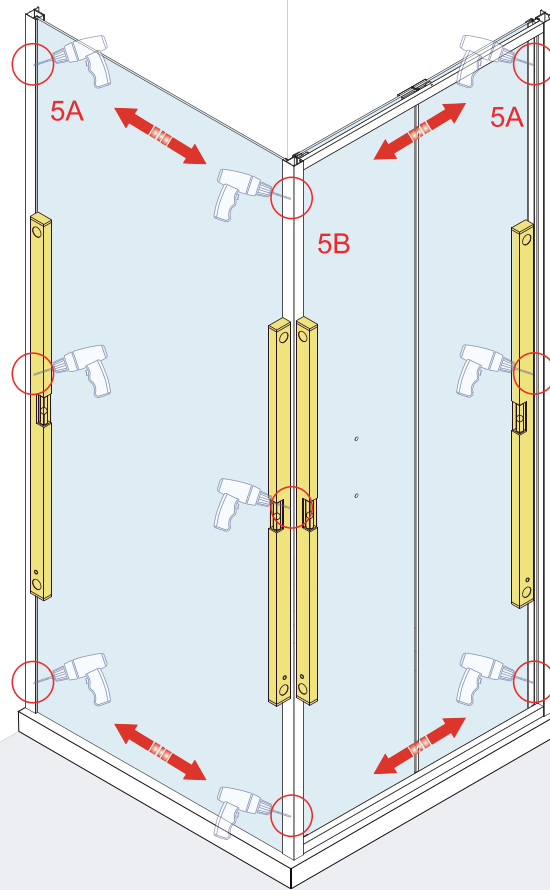
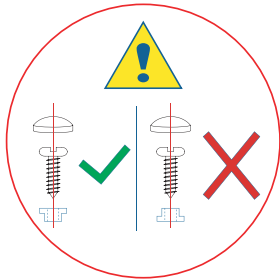
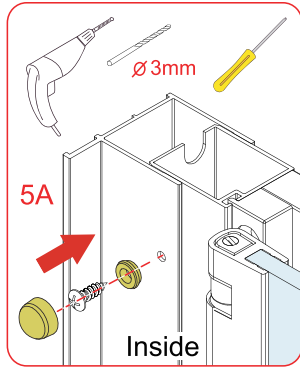

6

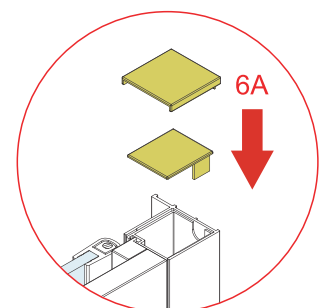
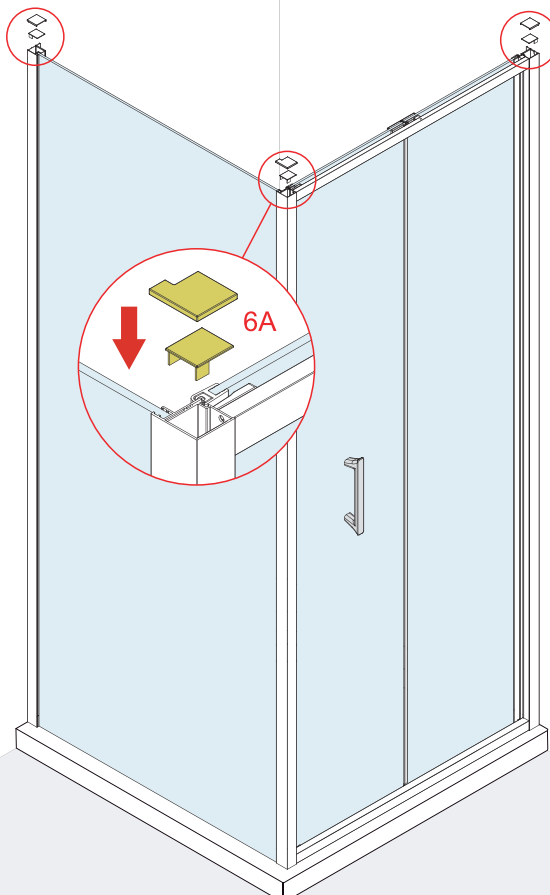
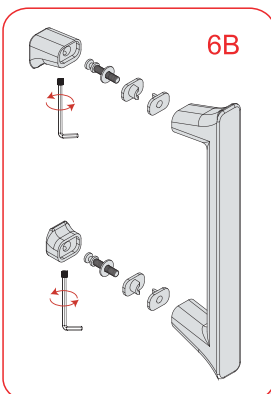
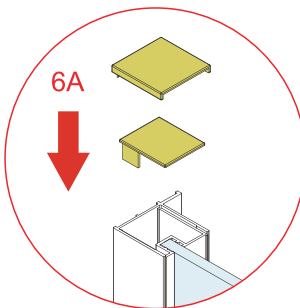

Note: The notched side of the top cap goes to the inside.

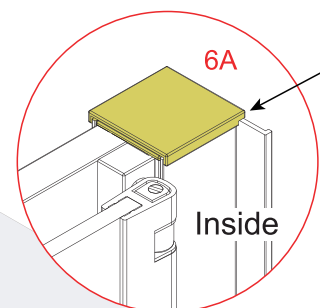

7

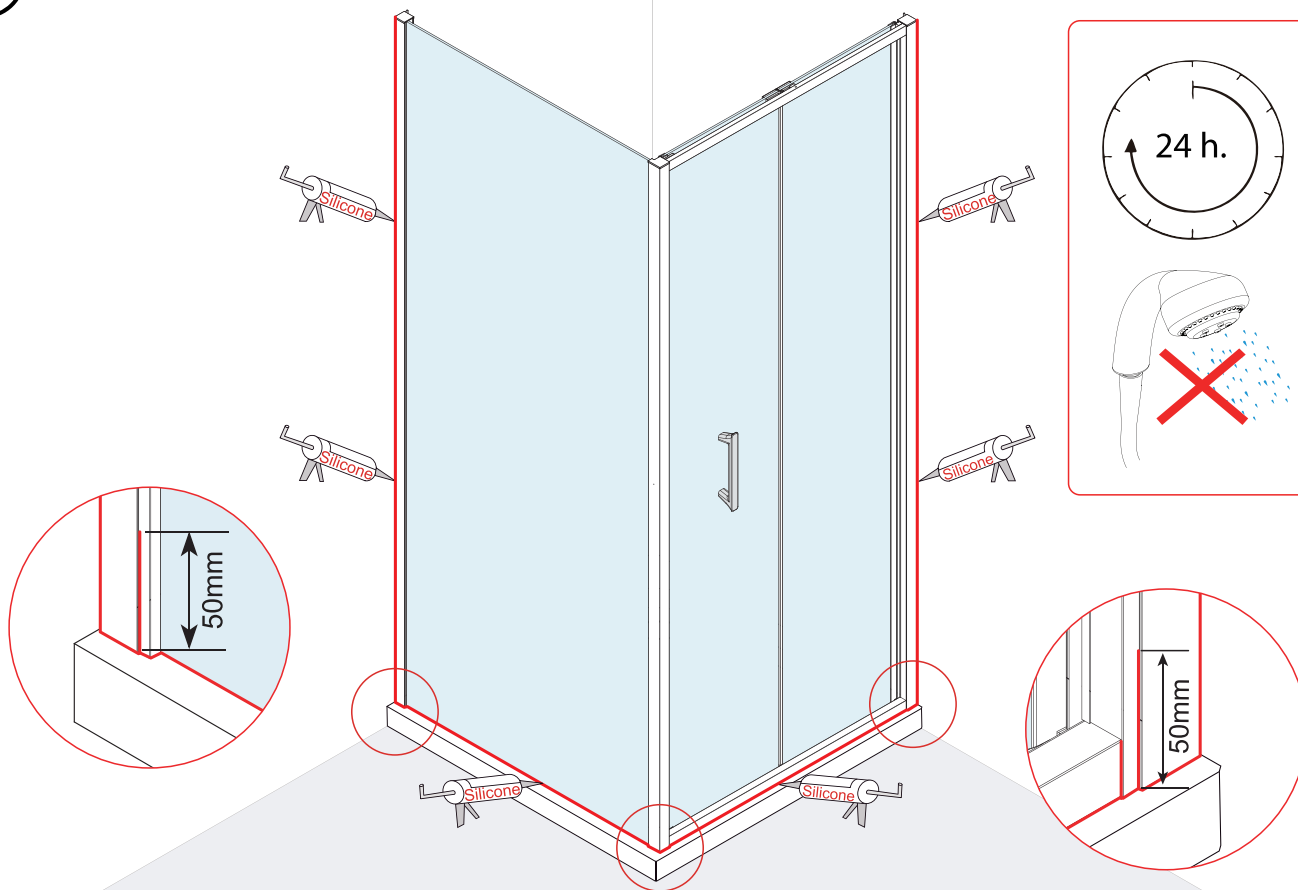

## **CLEANING**

It is important to clean your Merlyn shower door after every use. Wipe down all the glass and metal parts with a soft cloth. Do not allow lime scale to build up in hard water areas. Ensure that any residual water on the glass is removed after every use.

- Clean the glass regularly using soapy water.
- Do not use abrasive products on any surfaces.

Chrome is vulnerable to acid attack and some strong household cleaners including strong disinfectants, denture cleaners, hair dyes, wine making chemicals and photographic chemicals may contain acid. These materials may have a varying effect on the surface from black spots/streaks (which cannot be removed) to pitting the surface. Contact with these materials should be avoided.

## **TROUBLE SHOOTING**

### **Door Not functioning properly**

1. Is the tray 100% level ? (step1)
2. Do the finished tile measurements fall within the adjustment X and Y listed on (step 2) ?
3. Are the wall profiles plumb ? (step 2)
4. Is the frame square and plumb ? (step 5)

### **Door Leaking**

1. Was the tray adequately sealed before the enclosure was installed ? (step 1)
2. Is the door sealed correctly ? (step 7)

To download the Declaration of Performance (DOP) for this product  
please use the link below.

<https://merlynshowering.com/aftersales-support/dop-certs/>

For further information please contact: IRL:0567791555 UK:08081011429