

M E R L Y N

sleek

HINGE DOOR

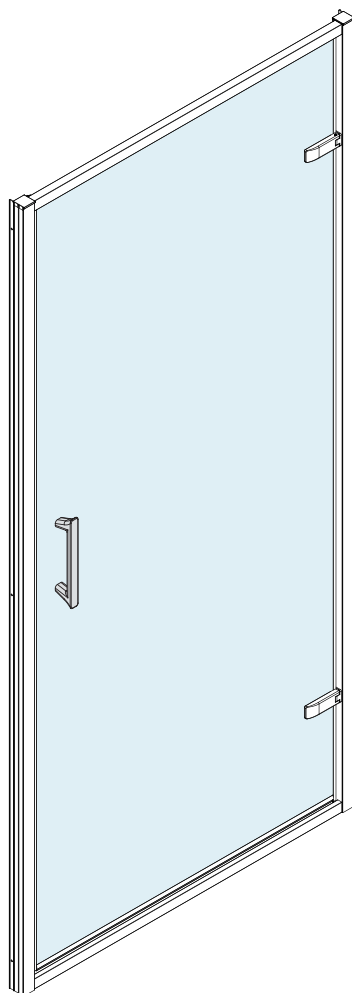

Sleek Chrome

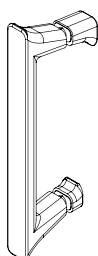

Sleek Black / Sleek BBR

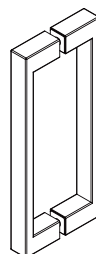

INSTALLATION GUIDE

IMPORTANT:

**Please read the complete instructions
before commencing fitting.**

Make sure the tray is 100% level in all directions.
Do Not attempt to install the product unless you
can tick all 4 boxes satisfactorily.

- Check that you have the tools required ☐
- Check the installation site is compatible with
the sizes of door supplied ☐
- Check all the enclosure components are present ☐
- Check the installation kit is complete ☐

The wall plugs supplied with the installation kit are
for use in solid walls. Hollow or 'stud partition'
walls will require alternative fixings. Please consult
a hardware supplier for the correct type.
It may also be necessary to consult your tiling
supplier about the correct method for drilling
your tiles.

**ATTENTION: TAKE EXTREME CARE WHEN
HANDLING GLASS, WEAR PROTECTIVE EYEWEAR
AND CLOTHING. DO NOT LEAVE THE GLASS ON
HARD SURFACES AND AVOID CONTACT BETWEEN
THE GLASS EDGES AND HARD SURFACES OR
IMPACTS DURING THE INSTALLATION.**

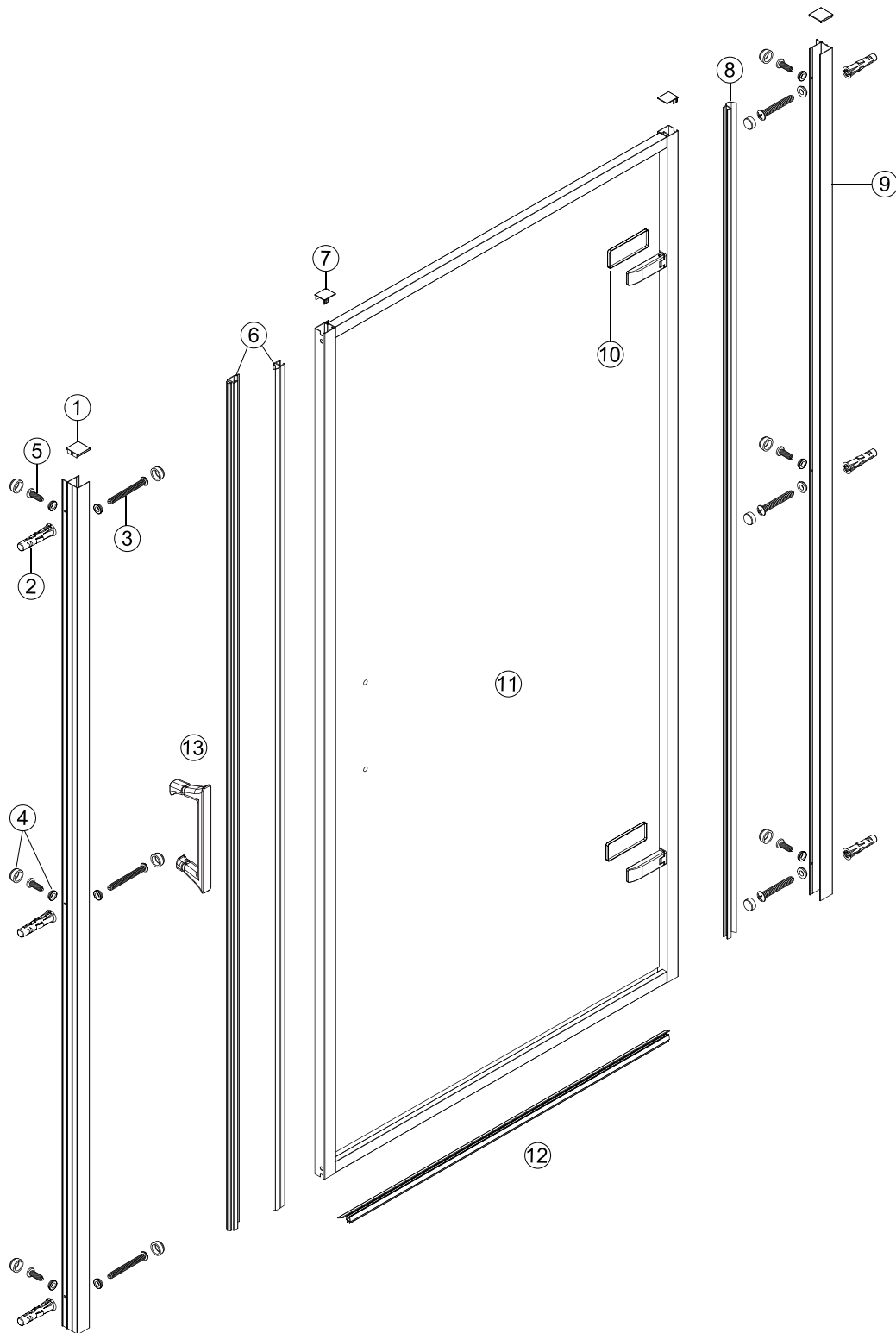

Note: Chrome / Matt black / Brushed brass colour are available, MB means Matt black, BBR means burshed brass.

No.	QTY	descriptions	Part number			No.	QTY	descriptions	Part number		
①	1	Wall profile cover cap	SP0SS6026	SP0SS6026MB	SP0SS6026BBR	⑧	1	Upright seal	SP0SS6073	SP0SS6073	SP0SS6073
②	6	Wall plug	A03S0090	A03S0090	A03S0090	⑨	2	Wall profile	SP0SS6003	SP0SS6003MB	SP0SS6003BBR
③	6	4x30 screw	A03S0089	A03S0089	A03S0089	⑩	2	Cover cap	SP0SS6091	SP0SS6091MB	SP0SS6091BBR
④	6	Screw cover cap & clip	SP0SS6028	SP0SS6028MB	SP0SS6028BBR	⑪	1	Moving panel	A	A	A
⑤	6	4x10 screw	SP0V4110	SP0V4110	SP0V4110	⑫	1	Bottom seal	B	B	B
⑥	1	Magnet seal set	SP0SS6074	SP0SS6074	SP0SS6074	⑬	1	Handle	SP0SS6029	SP0SS6058MB	SP0SS6058BBR
⑦	2	Frame cover cap	SP0SS6027	SP0SS6027MB	SP0SS6027BBR						

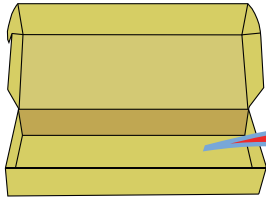

Note: Chrome / Matt black / Brushed brass colour are available, MB means Matt black, BBR means burshed brass.

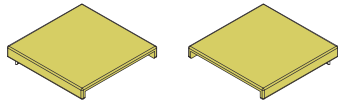

SP0SS6026/MB/BBR
X1

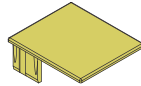

SP0SS6027/MB/BBR
X2



SP0V4110
X6



SP0SS6028/MB/BBR
X12

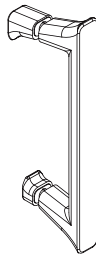

SP0SS6029
X1

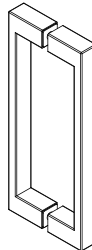

SP0SS6058MB/BBR
X1

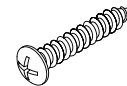

A03S0089
X6

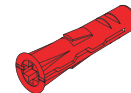

A03S0090
X6

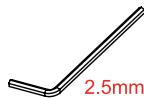

SP08S1300511
X1

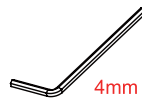

8S1300611
X1



SP08S1301152
X1

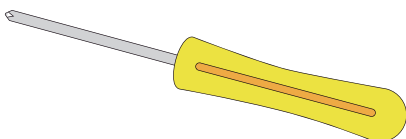
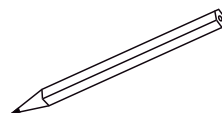
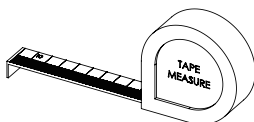
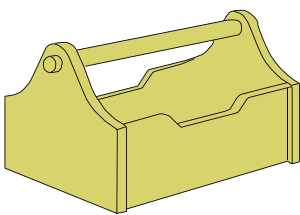

PH2

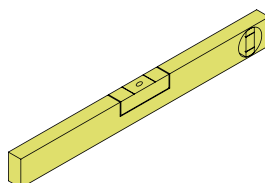

∅6



1

Ensure the shower tray is level in all directions and is properly sealed to the wall. The wall must be tiled down to the top edge of the tray.

Do not angle out bottom tile.
TRAY MUST BE LEVEL IN ALL DIRECTIONS!

TRAY MUST BE SEALED FULLY AROUND WHERE THE TRAY MEETS THE WALL.

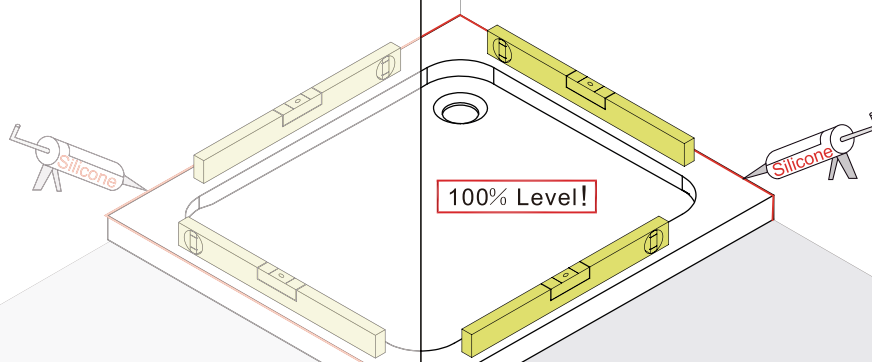
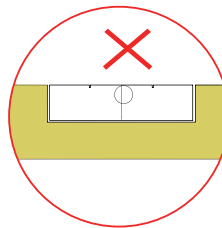
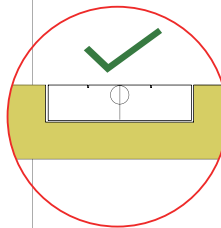

2

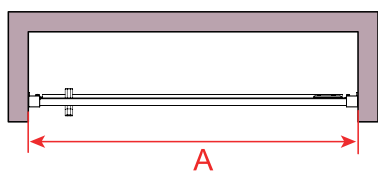

Size	A
760	710-750
800	750-790
900	850-890
1000	950-990

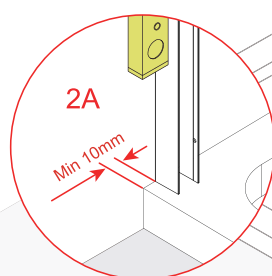

2A

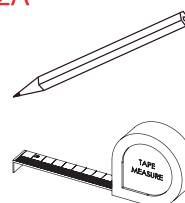

2B

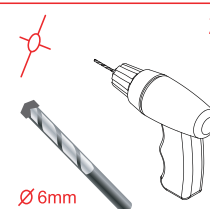

2C



3

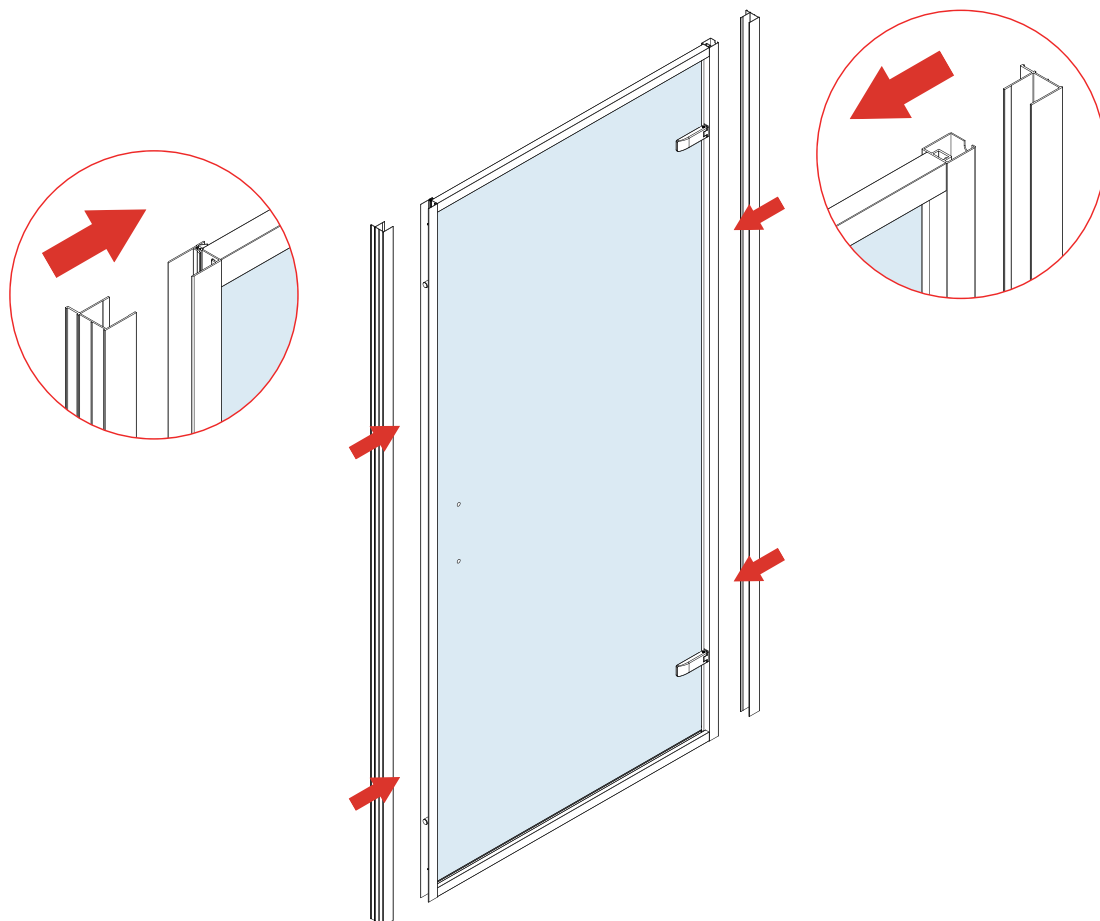

4

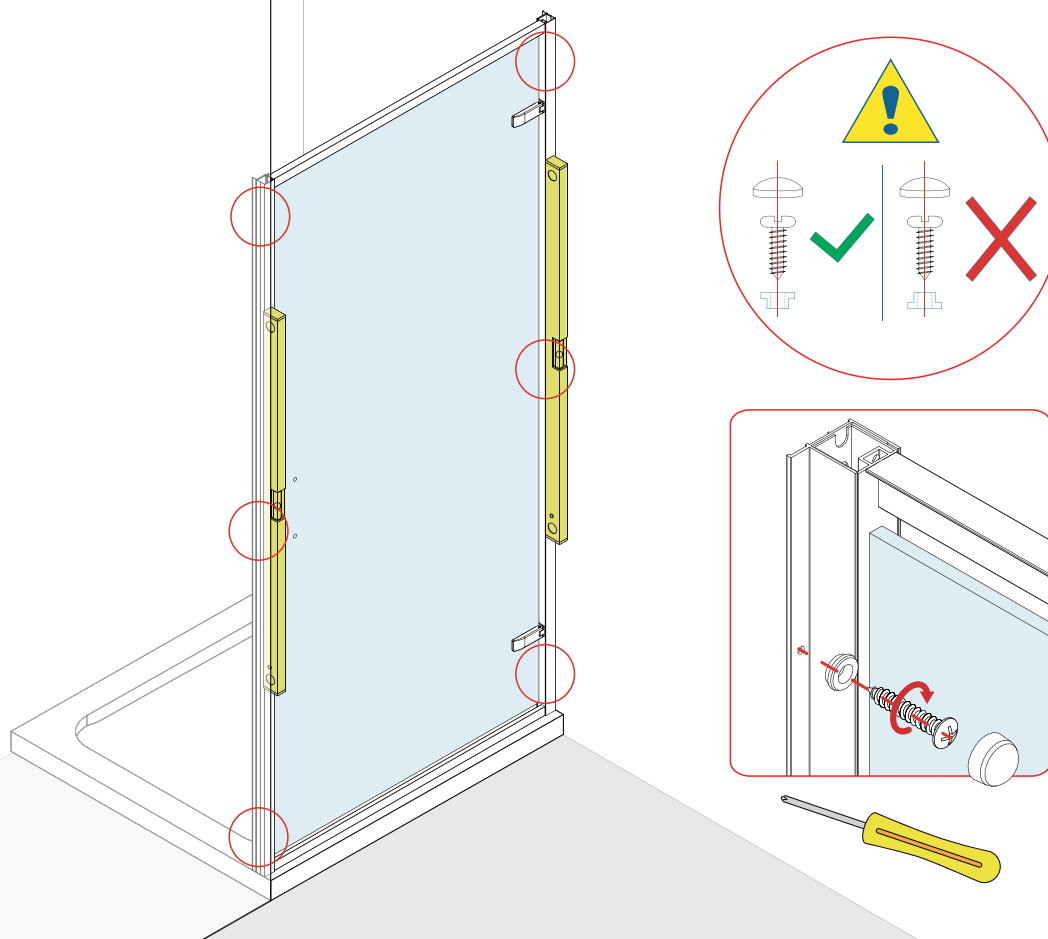

5

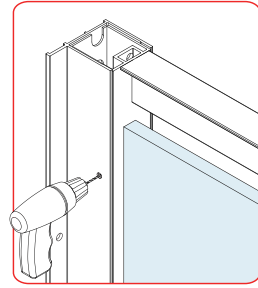
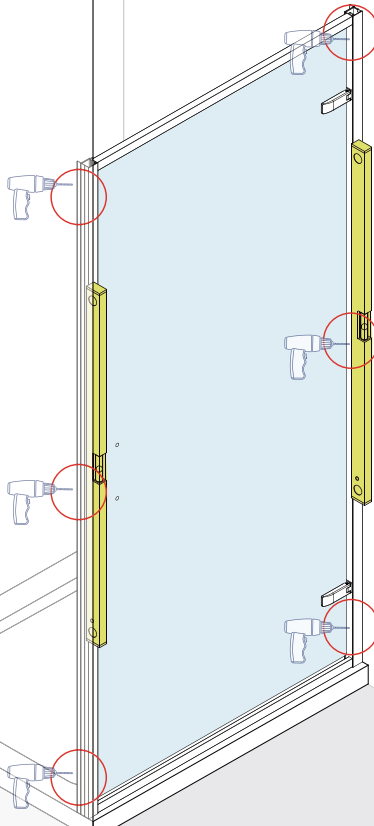
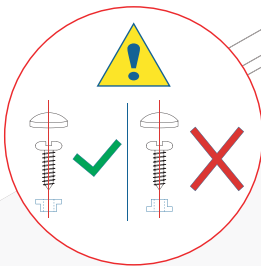
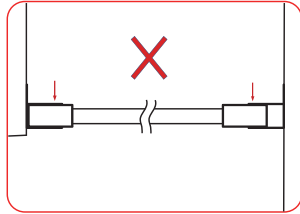
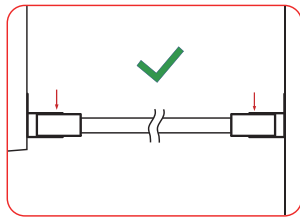

φ 3mm

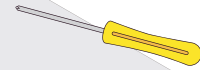
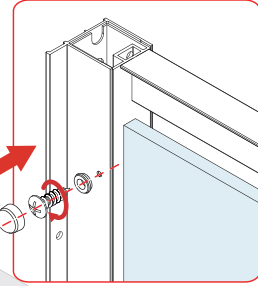

6

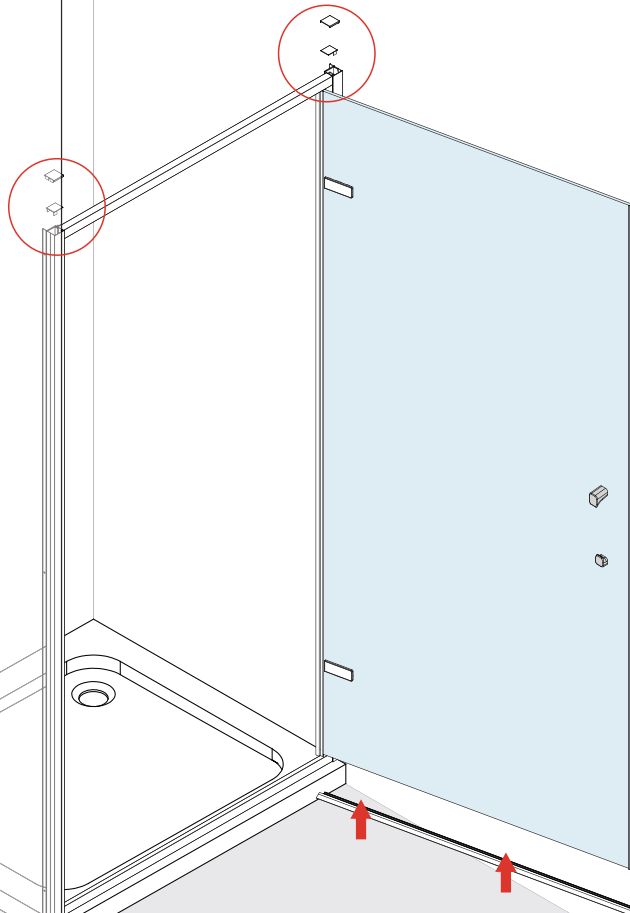
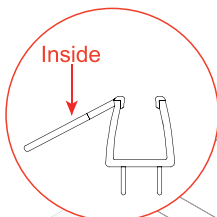
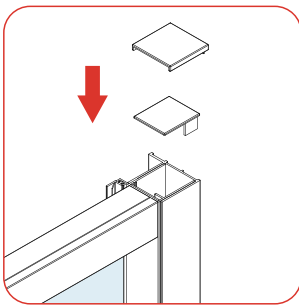

Sleek Chrome

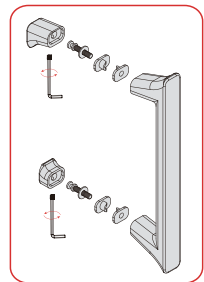

Sleek Black
Sleek BBR

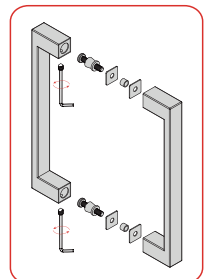

7

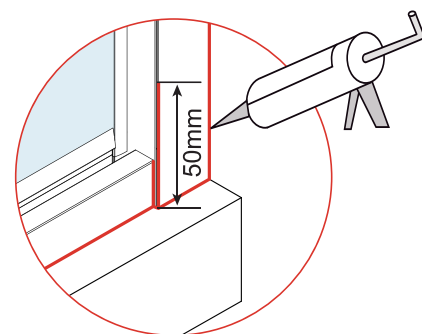
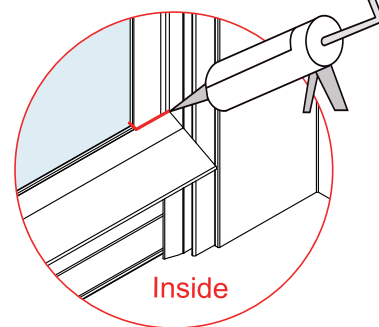
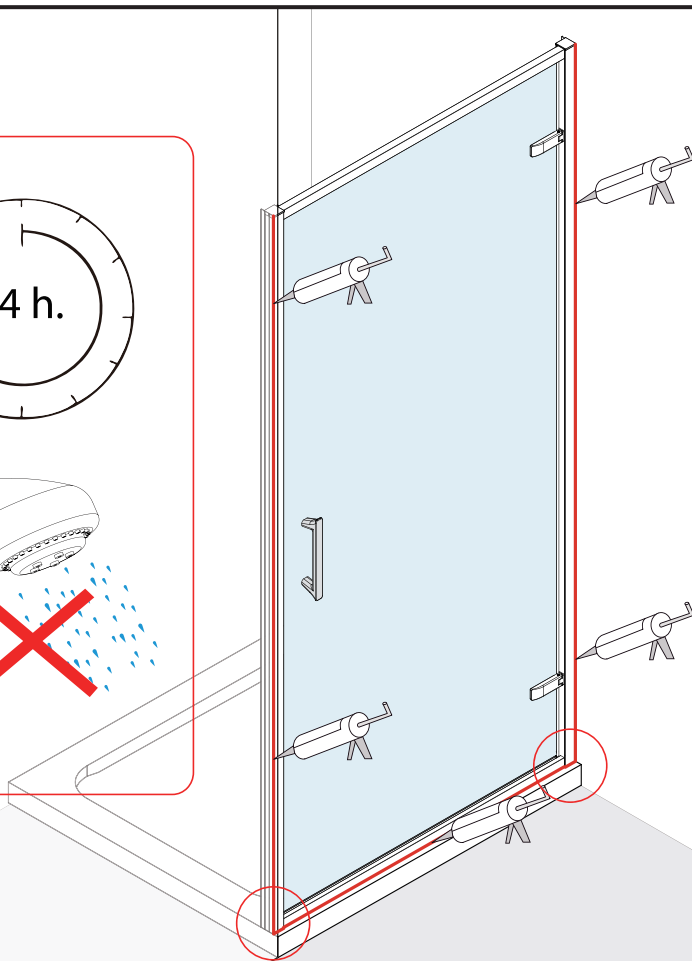
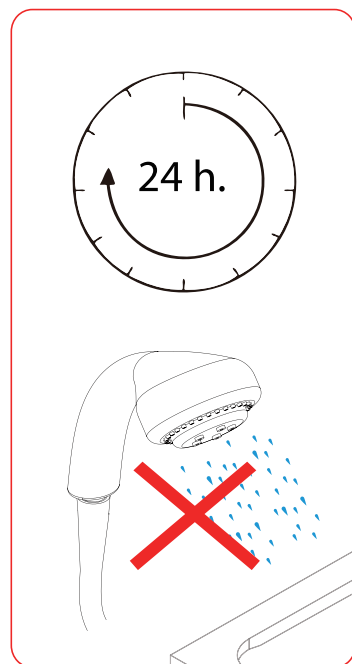

CLEANING

It is important to clean your Merlyn shower door after every use. Wipe down all the glass and metal parts with a soft cloth. Do not allow lime scale to build up in hard water areas. Ensure that any residual water on the glass is removed after every use.

- Clean the glass regularly using soapy water.
- Do not use abrasive products on any surfaces.

Chrome is vulnerable to acid attack and some strong household cleaners including strong disinfectants, denture cleaners, hair dyes, wine making chemicals and photographic chemicals may contain acid. These materials may have a varying effect on the surface from black spots/streaks (which cannot be removed) to pitting the surface. Contact with these materials should be avoided.

TROUBLE SHOOTING

Door Not functioning properly

1. Is the tray 100% level? (step 1)
2. Do the finished tile measurements fall within the adjustment A listed on (step 2)?
3. Are the wall profiles plumb?(step 2)

Door Leaking

1. Was the tray adequately sealed before the enclosure was installed?(step 1)
2. Are the upright seals fitted correctly? (step 7)

To download the Declaration of Performance (DOP) for this product
please use the link below.

<https://merlynshowering.com/aftersales-support/dop-certs/>

For further information please contact: IRL:0567791555 UK:08081011429