

Installation Guide

MB3B Two Panel Bath screen

IMPORTANT

Please read the complete instructions
before commencing fitting.

Do Not attempt to install the product unless you can tick all 4 boxes satisfactorily

- | | | | |
|---|--------------------------|--|--------------------------|
| ▪ Check that you have the tools required | <input type="checkbox"/> | ▪ Check all the enclosure components are present | <input type="checkbox"/> |
| ▪ Check the installation site is compatible with the sizes of door supplied | <input type="checkbox"/> | ▪ Check the installation kit is complete | <input type="checkbox"/> |

The wall plugs supplied with the installation kit are for use in solid walls. Hollow or 'stud partition' walls will require alternative fixings. Please consult a hardware supplier for the correct type. It may also be necessary to consult your tiling supplier about the correct method for drilling your tiles

**ATTENTION: TAKE EXTREME CARE WHEN HANDLING GLASS.
WEAR PROTECTIVE EYEWEAR AND CLOTHING.
DO NOT LEAVE THE GLASS ON HARD SURFACES AND AVOID
CONTACT BETWEEN THE GLASS EDGES AND HARD SURFACES OR
IMPACTS DURING THE INSTALLATION**

NOTE: Please ensure the bathscreen
Is installed on the inside of the bath top.

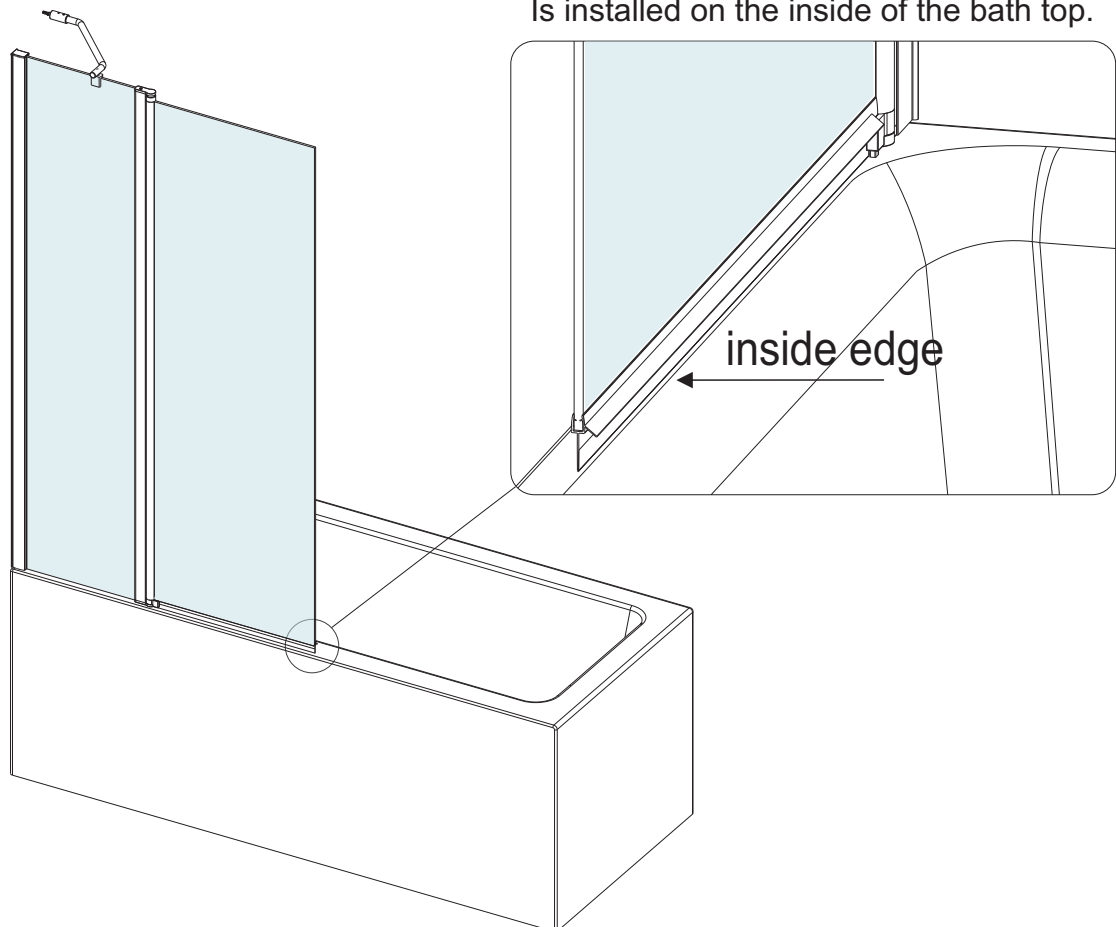

COMPONENTS AND BOX CONTENTS

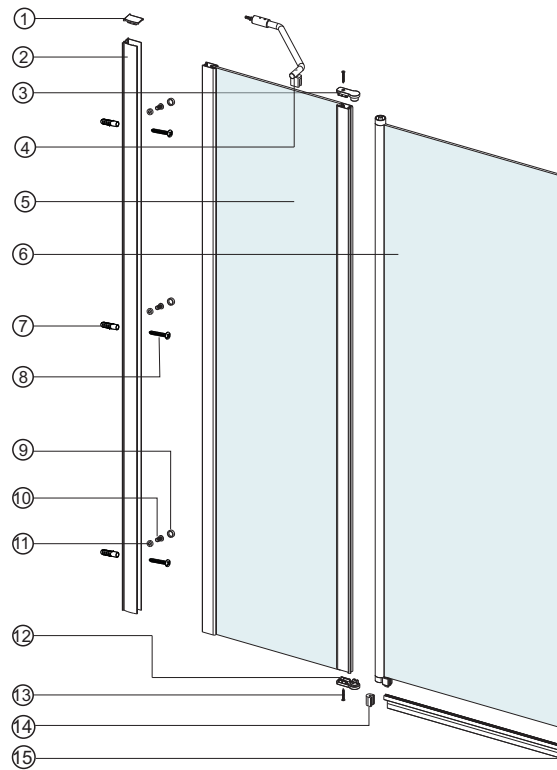

No.	Description	Qty	Part No.	No.	Description	Qty	Part No.	No.	Description	Qty	Part No.	No.	Description	Qty	Part No.
1	Wall profile cover	2	SP0MOBY002L/R	6	Moving Glass Panel	1	A	11	Screw Cover Cap Clip	3	2SS009	16			
2	Wall profile	1	LR8387C	7	Wall Plug	3	2SP12	12	Bracket bottom Leakfree	1	SP0LF02	17			
3	Bracket top Leakfree	1	SP0LF01	8	Screw(4X40mm)	3	A2403001	13	Screw(3.5X30mm)	2	SP0M7029	18			
4	Stabilising Bar	1	BSYS023C	9	Screw Cover Cap	3	2SS008	14	foam plastics	1	LP-123	19			
5	Fixed Glass Panel	1	B	10	Screw(4X12mm)	3	A2401201	15	Clear Seal	1	SP0LFCS	20			

Fixing Kit components

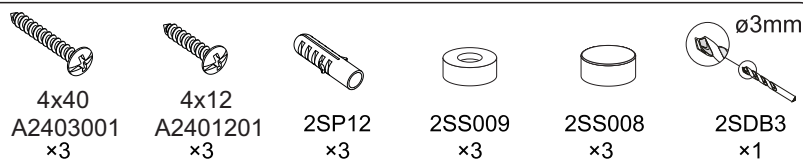

Tools required

- 6mm Masonry drill bit
- Power drill
- Neutral cure anti bacterial silicone
- Pencil
- Tape measure
- PH2 Philips Head screw driver
- Spirit level with horizontal and vertical level indicators

IMPORTANT - Installation Site

1. Ensure your bath is level before fitting. This screen is not designed to fit on baths with stepped fronts, roll top rims or integral soap dishes.
2. The tiling or other wall finishing should be effectively sealed at the bath edges.

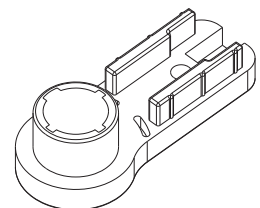

Top Bracket
SP0LF01
x1

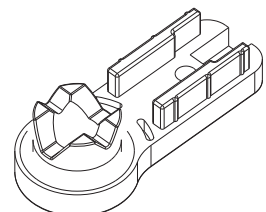

Bottom Bracket
SP0LF02
x1

INSTALLATION

1. Silicone on the bath edge if not siliconed previously fig 1.

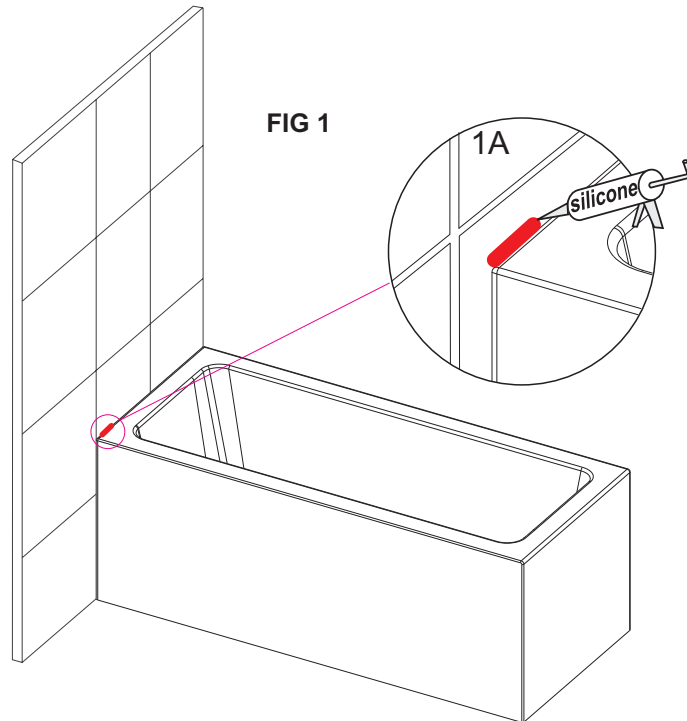

2. Insert the fixed panel B into the wall profile. Do not fix to the wall profile fig 2.

FIG 2

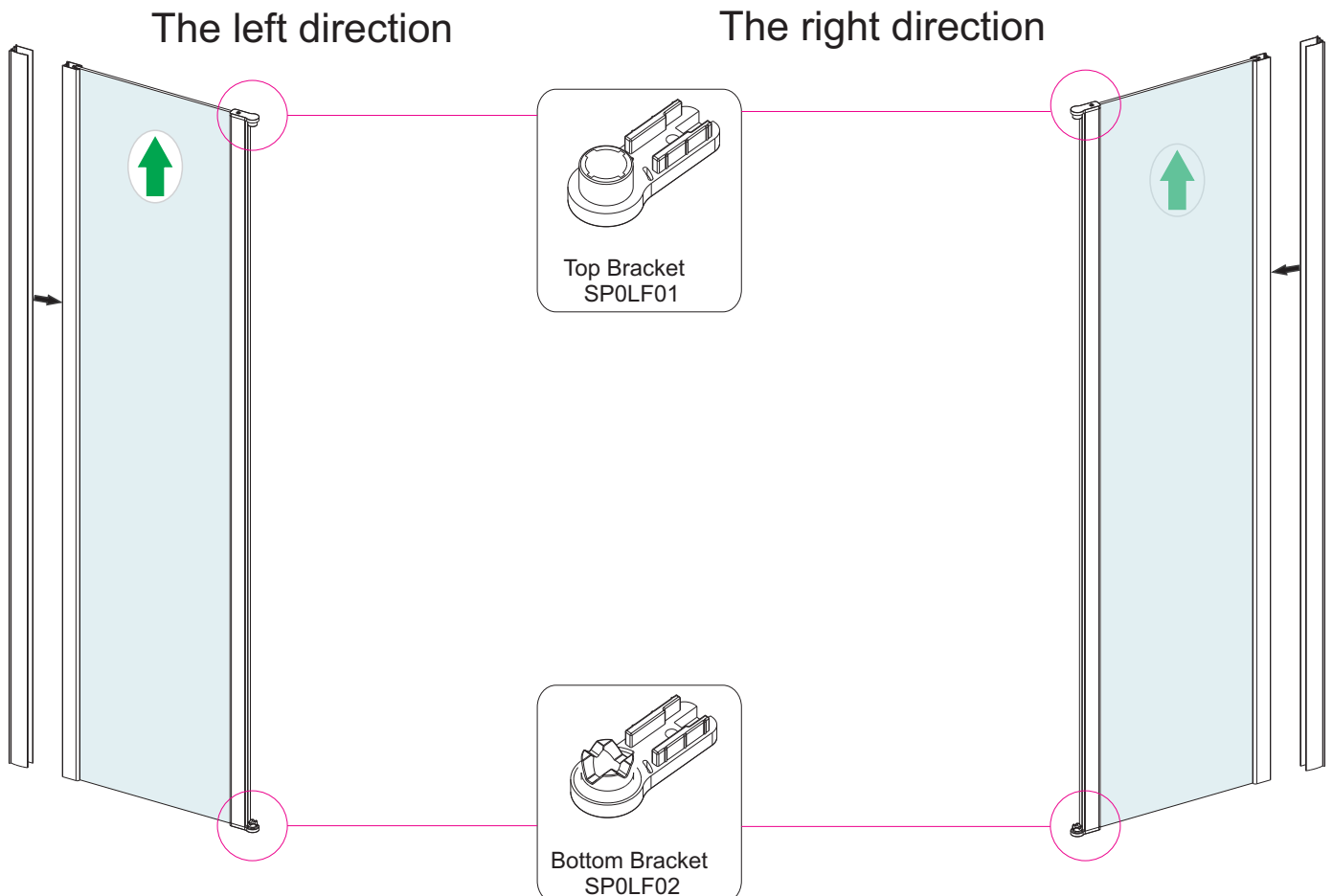

3. Fit the bottom clear seal **SP0LFCS** on to the bottom of the bathscreen **fig 3** . Apply silicone as shown in **fig 3A** firstly.

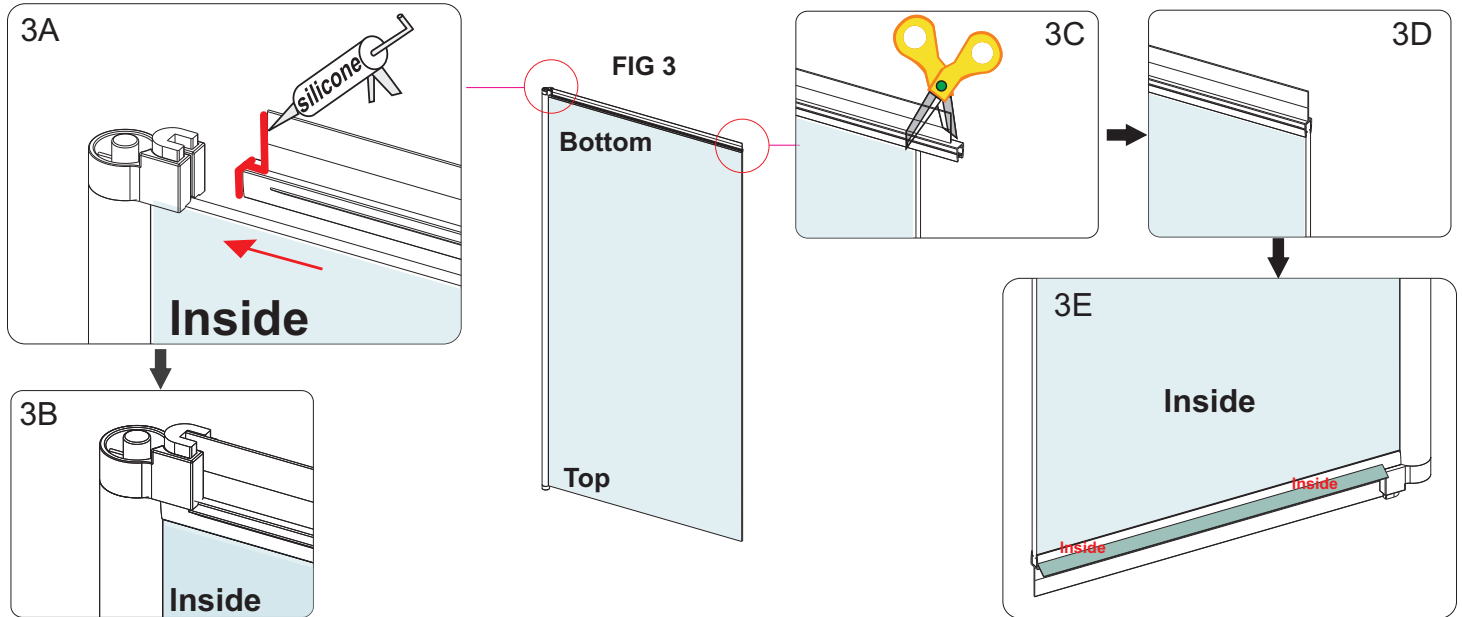

4. Position the wall profile **LR8387C** so the seal on the moving panel sits on the inside edge of the bath. **Fig 4**.

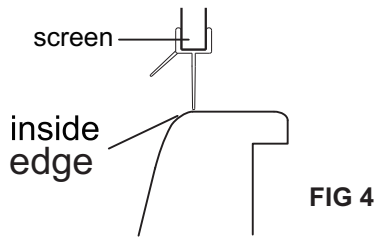

5. Plumb the wall profiles **LR8387C** using the vertical element of the spirit level. Mark 3 holes, drill with 6mm masonry bit and fit wall plugs **2SP12**. Using the 3 Screw **A2403001**, fix wall profiles to wall. **Fig 5**.

NOTE: Only silicone the wall profile after fixing to the wall (see sealing section).
Do not silicone on the back of the wall profile before fixing to the wall.

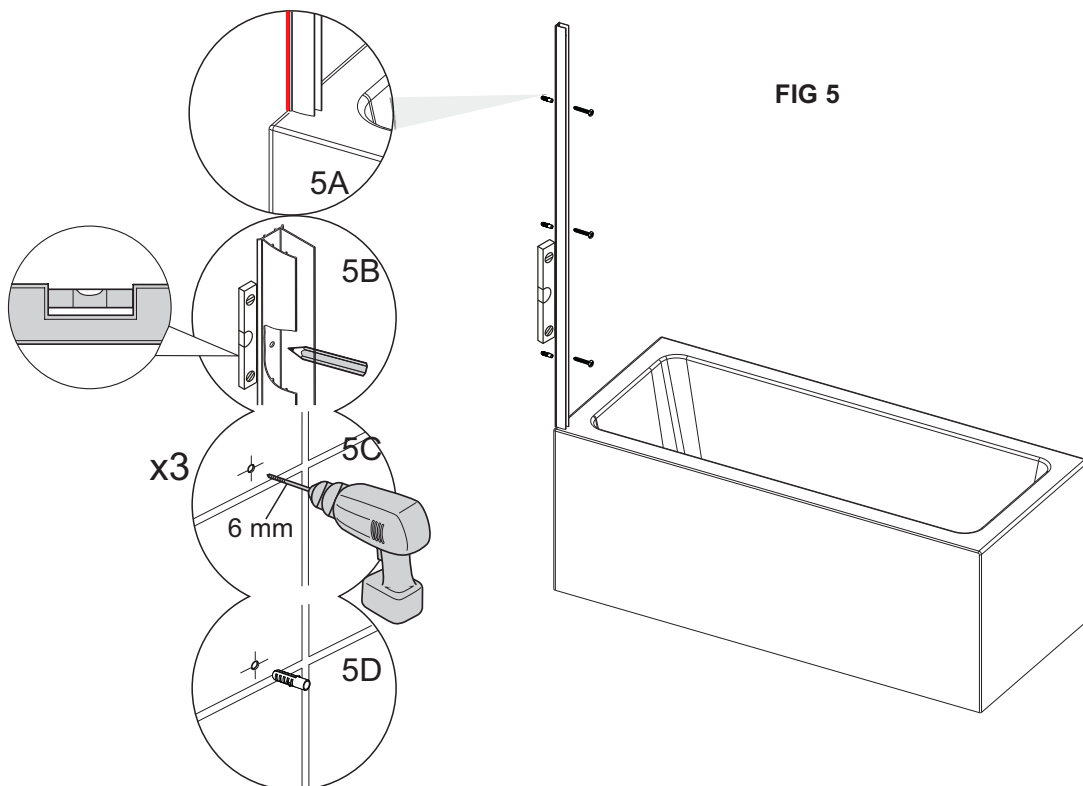

6. Drill 3 holes top, middle and bottom through the wall profile and fixed panel using a 3mm steel drill bit. Using the Screws **A2401201**, and screw cover caps **2SS008** and screw cover caps clips **2SS009** fix the hinge upright to the wall profile in 3 places. **Fig 6**.

Note: Ensure bottom pivot bracket is always on the bottom of the fixed panel.

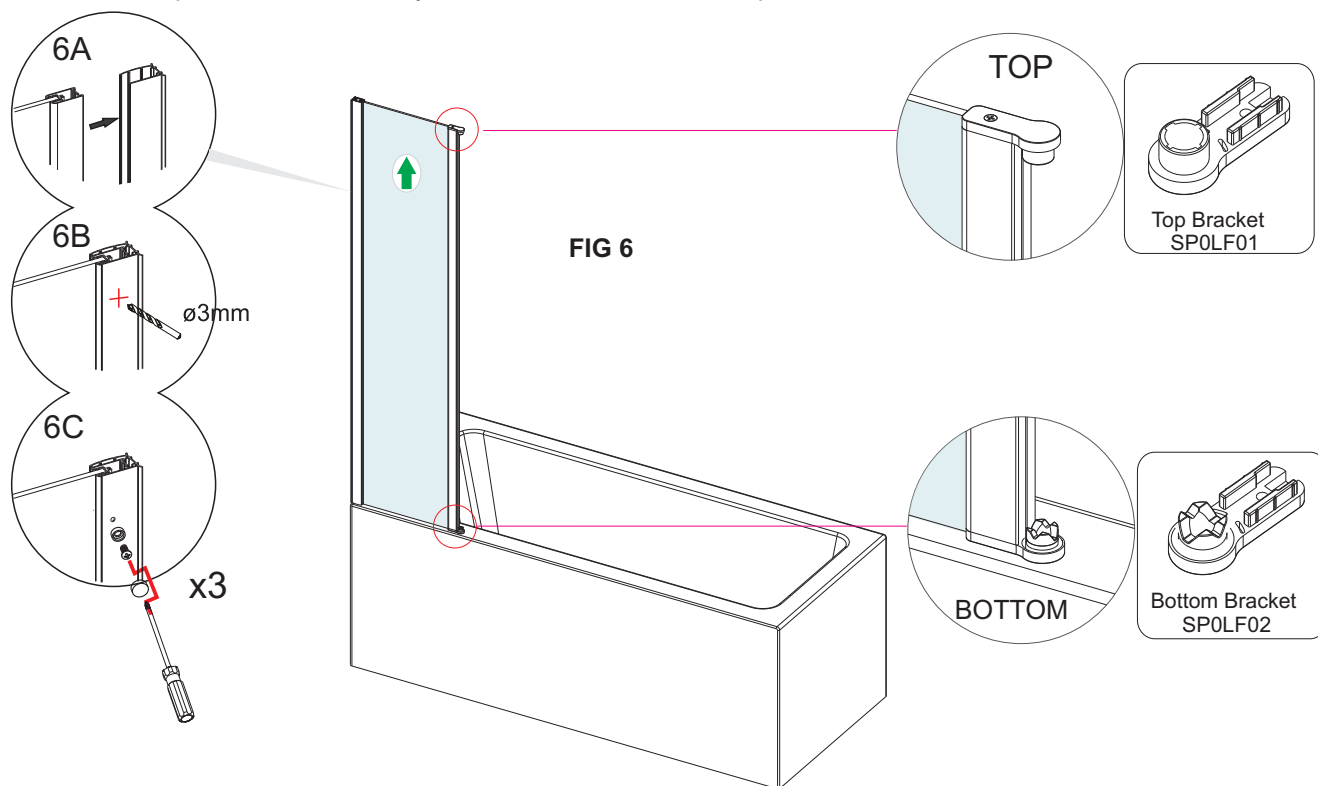

7. To change the handing of the stabilising bar **BSYS023**, unscrew where the arm attaches to the glass clamp and reverse. Place the stabilising bar onto the fixed panel. Mark the fixing point for the bracket to the wall. Use 6mm masonry bit, insert 1 wall plug **2SP12** and fix to wall with screw **A2403001**. Fasten the bracket to the glass keeping the washer on the outside of the glass. Attach cover caps to bracket. **Fig 7**.

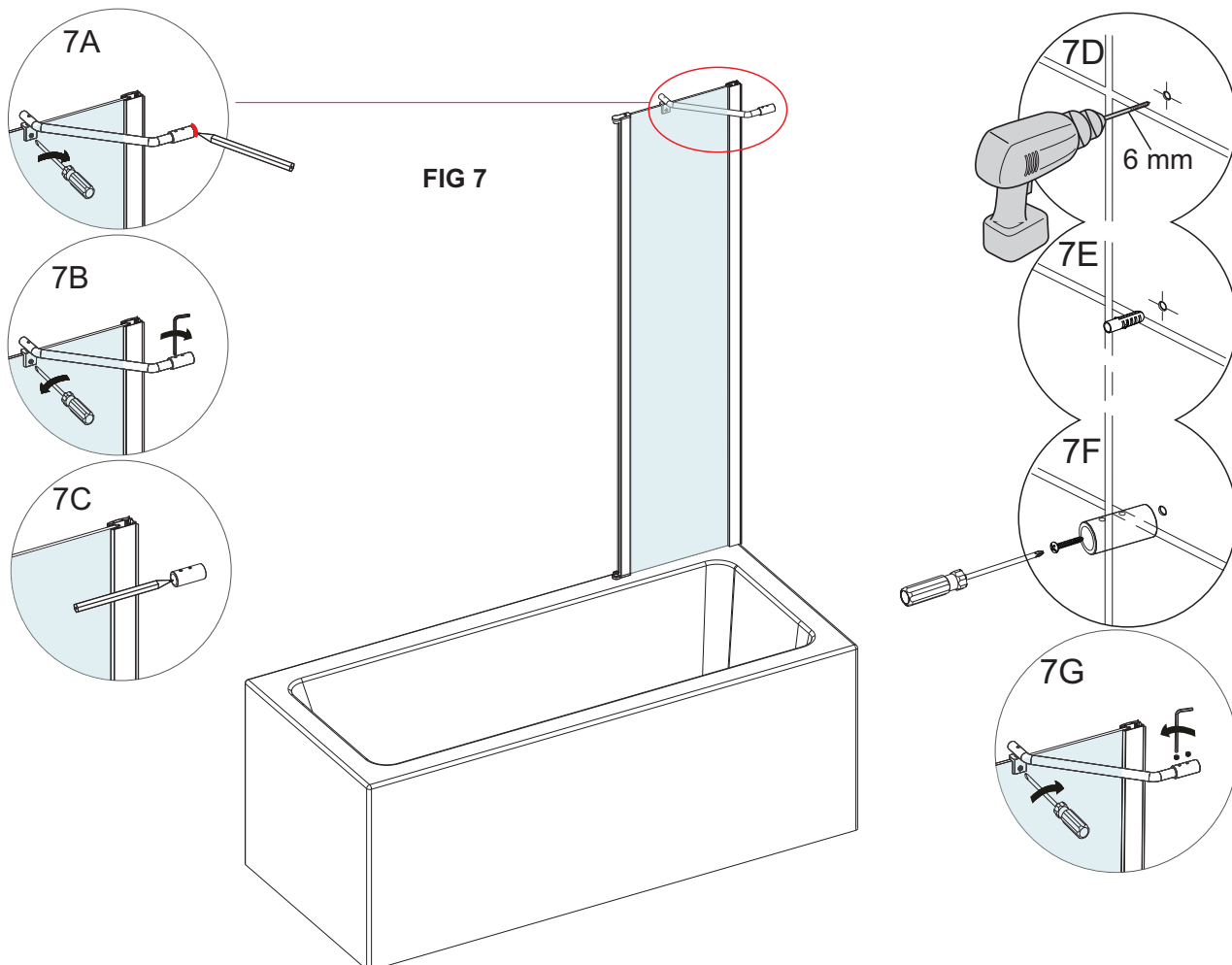

8. Place moving panel into the bottom pivot bracket and fix the top pivot bracket into position as shown in 8A – 8C”.

9. Fix the wall profile cover **SP0MOBY002L/R** and **BSYS025C** bath.Fig 8.

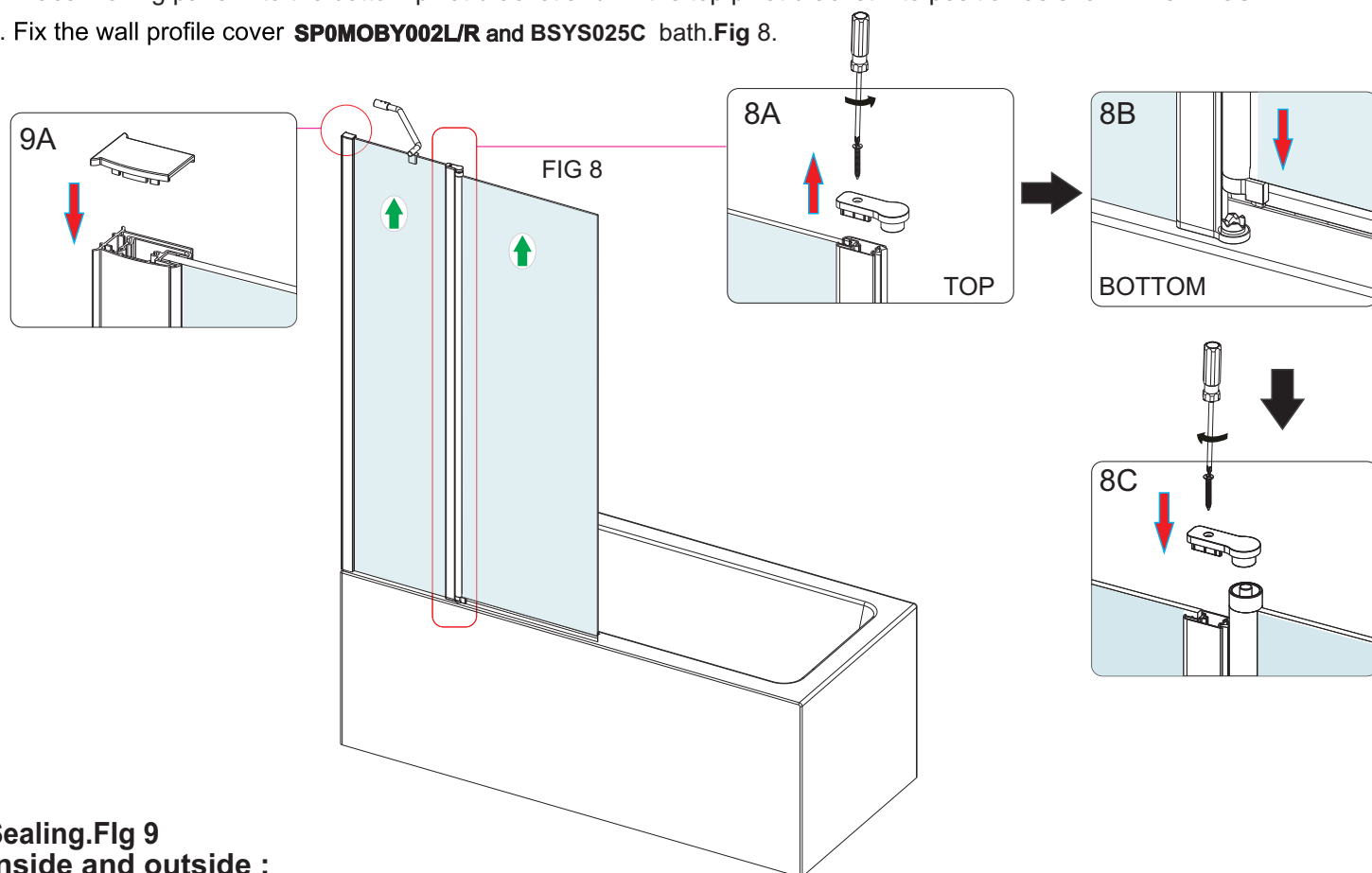

Sealing.Flg 9

Inside and outside :

When installation is complete seal the joint between the wall profile and the wall, top to bottom on the inside and outside.

Silicone where the fixed panel and hinge bracket sit on the bath inside and outside. Seal 50mm up where the hinge upright and the fixed panel glass over lap.

Seal 50mm up where

Seal with silicone according to the position of inner and outer red thick lines.

