

## HINGE DOOR & INLINE PANEL

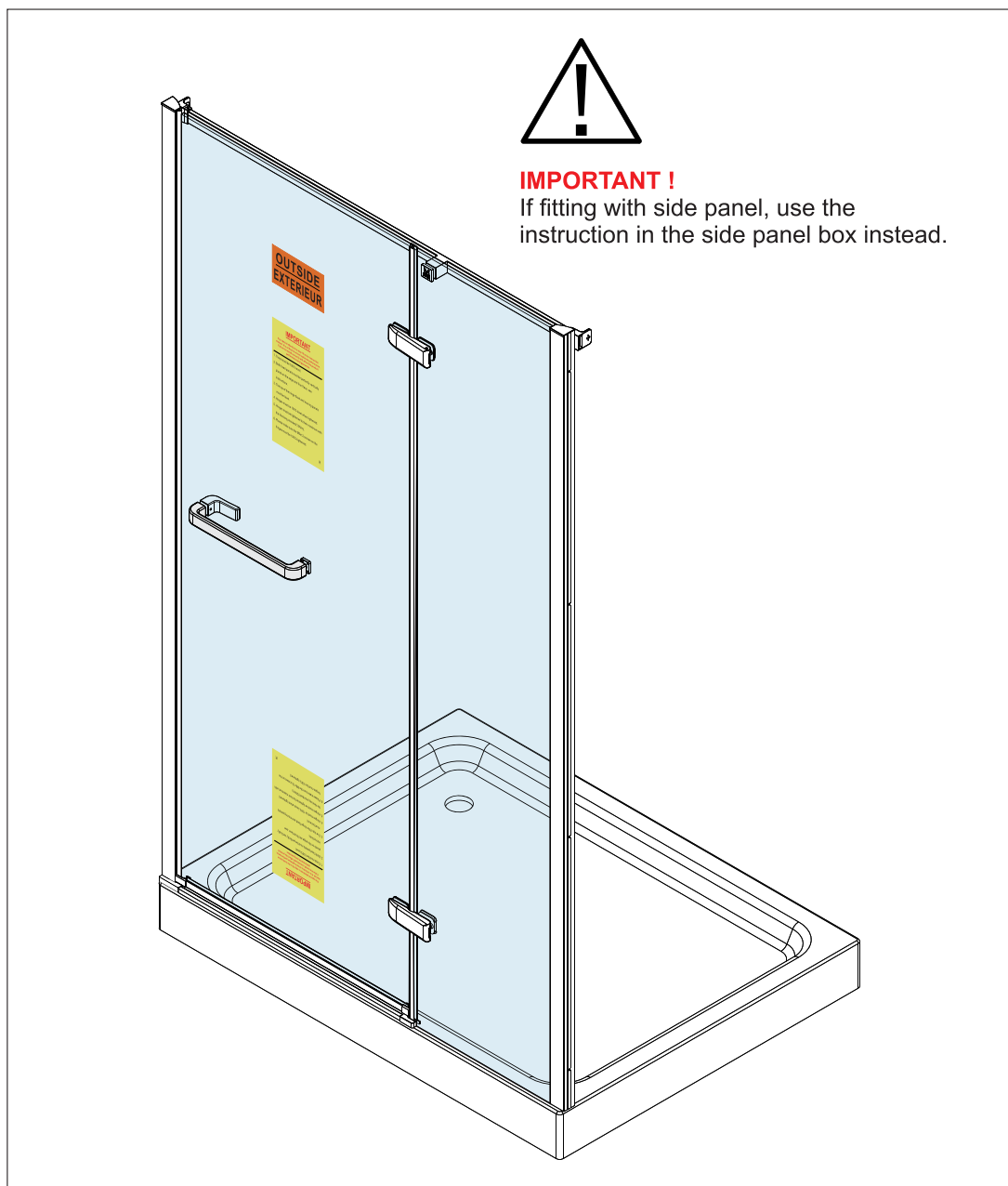

## INSTALLATION GUIDE

**IMPORTANT:**  
**Please read the complete instructions  
before commencing fitting.**

Make sure the tray is 100% level in all directions.  
Do Not attempt to install the product unless you  
can tick all 4 boxes satisfactorily.

- Check that you have the tools required ☐
- Check the installation site is compatible with  
the sizes of door supplied ☐
- Check all the enclosure components are present ☐
- Check the installation kit is complete ☐

The wall plugs supplied with the installation kit are  
for use in solid walls. Hollow or 'stud partition'  
walls will require alternative fixings. Please consult  
a hardware supplier for the correct type.  
It may also be necessary to consult your tiling  
supplier about the correct method for drilling your  
tiles.

**ATTENTION: TAKE EXTREME CARE WHEN  
HANDLING GLASS, WEAR PROTECTIVE EYEWEAR  
AND CLOTHING. DO NOT LEAVE THE GLASS ON  
HARD SURFACES AND AVOID CONTACT BETWEEN  
THE GLASS EDGES AND HARD SURFACES OR  
IMPACTS DURING THE INSTALLATION.**

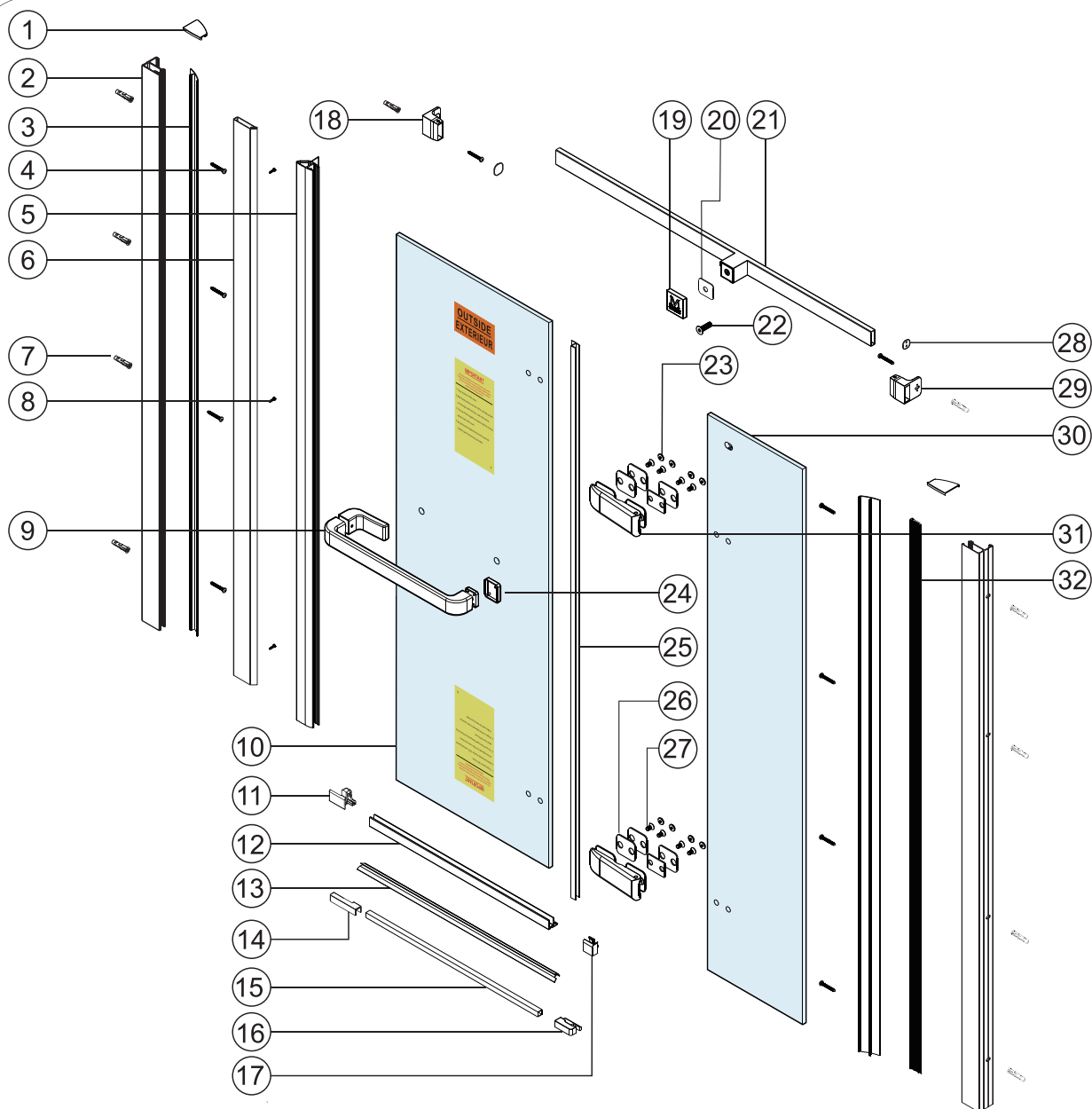

No.	Qty	Part No.	No.	Qty	Part No.	No.	Qty	Part No.
(1)	2	A06S0060	(12)	1	A06S0002	(23)	8	A06S0012
(2)	2	A06S0058	(13)	1	A06S0042	(24)	1	A06S0016
(3)	2	A01S0115	(14)	1	A06S0034	(25)	1	A06S0041
(4)	8	A06S0049	(15)	1	A06S0004	(26)	8	A06S0011
(5)	1	A06S0044	(16)	1	A06S0036 L/R	(27)	8	A06S0013
(6)	1	A06S0001	(17)	1	A06S0038 L/R	(28)	2	A06S0032
(7)	10	8SSJ066	(18)	1	A06S0030	(29)	1	A06S0031
(8)	3	A06S0047	(19)	1	A06S0081	(30)	1	C
(9)	1	A06S0014	(20)	1	A06S0020	(31)	2	A06S0009
(10)	1	A	(21)	1	B	(32)	1	A01S0154
(11)	1	A06S0037	(22)	1	A06S0021			

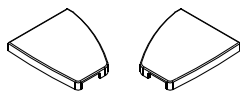
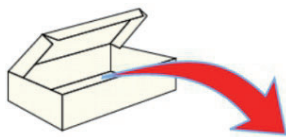

A06S0060 L/R  
×2

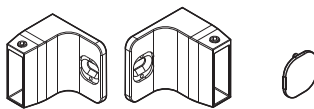

A06S0030 ×1 A06S0031 ×1 A06S0032 ×2

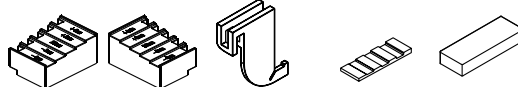

A06S0067 ×2 A06S0039 ×2 A06S0062 ×1 A06S0063 ×1

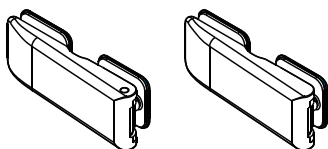

A06S0009 ×1 A06S0009 ×1



A06S0081  
×1



A06S0021  
×1



A06S0020  
×1

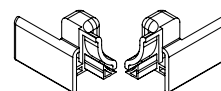

A06S0037  
×1

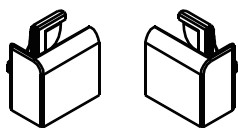

A06S0038  
×1

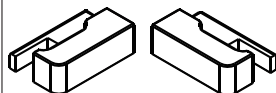

A06S0036  
×1

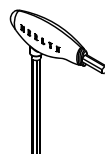

4mm  
A06S0046  
×1

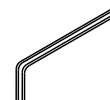

3.0mm  
8S1300611  
×1

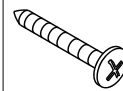

4x30  
A06S0049  
×8



4x10  
A06S0047  
×3

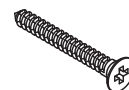

4x30  
A06S0048  
×2



8SSJ066  
×10

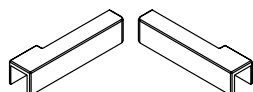

A06S0034  
×1

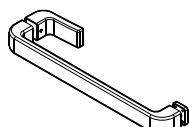

A06S0014  
×1

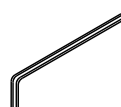

2.5mm  
8S1300511  
×1



A09S0052  
×1

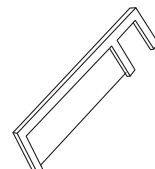
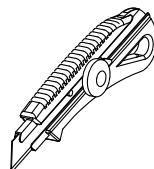
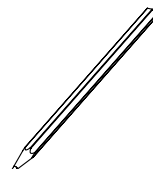
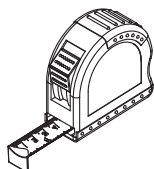
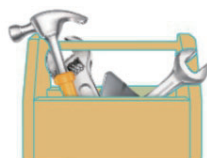

PH2

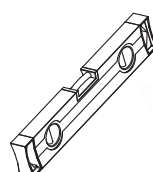

Φ6

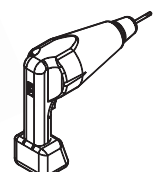

1

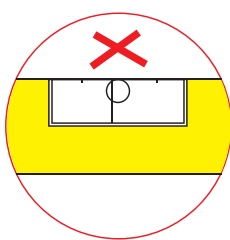
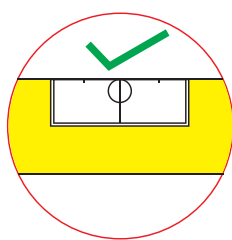

100%Level!

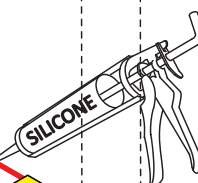

2

Size Taille Größe Maat	X
900	860-905
900+	905-950
1000	960-1005
1000+	1005-1050
1100	1060-1105
1100+	1105-1150
1200	1160-1205
1200+	1205-1250
1400	1360-1405
1400+	1405-1450
1600	1560-1605
1600+	1605-1650
1700	1660-1705
1700+	1705-1750

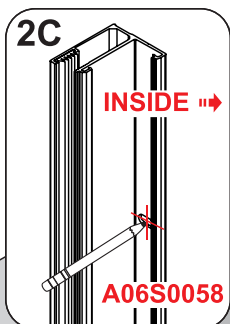
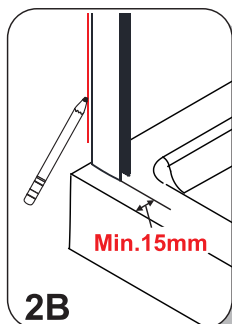
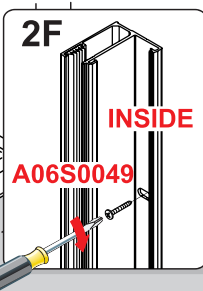
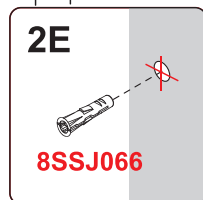
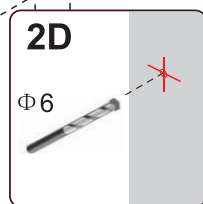
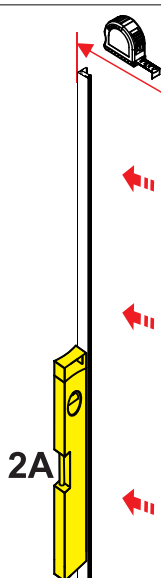

3

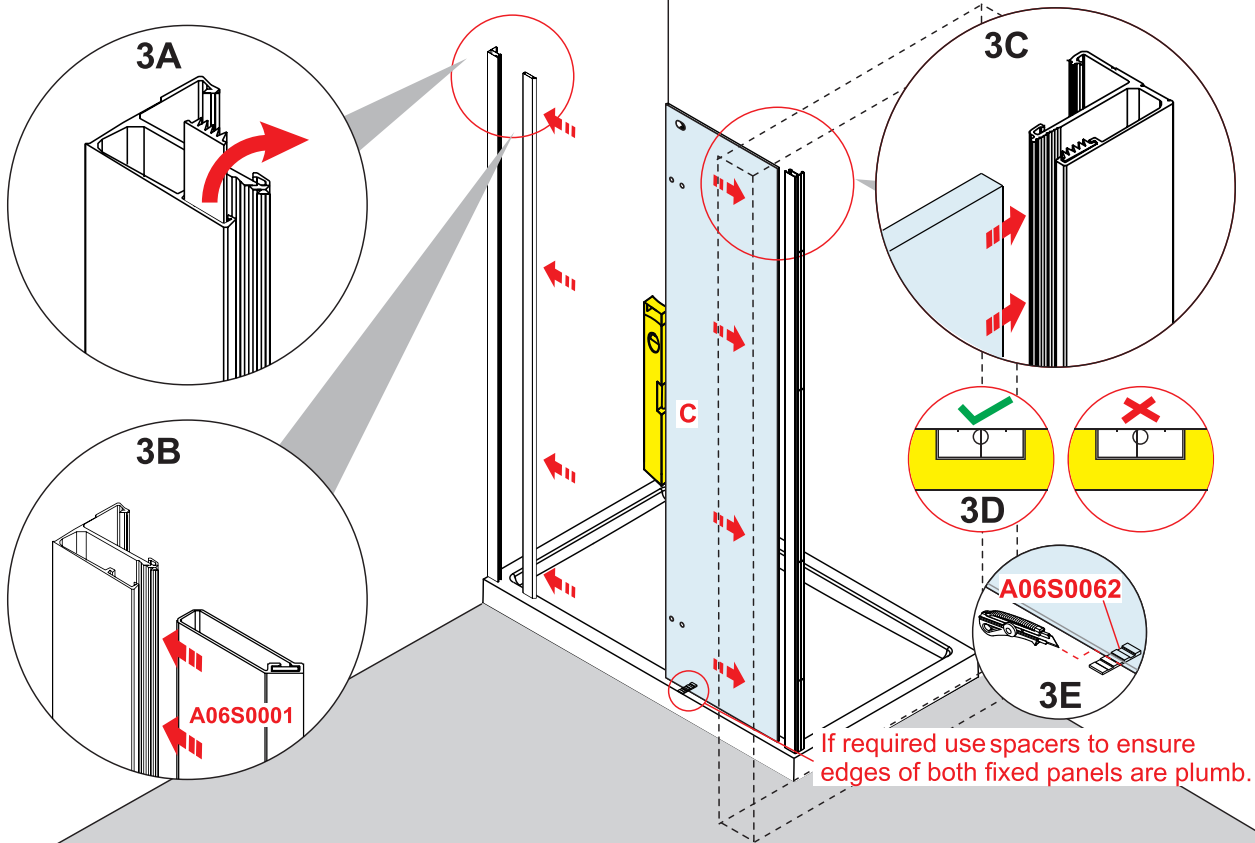

4

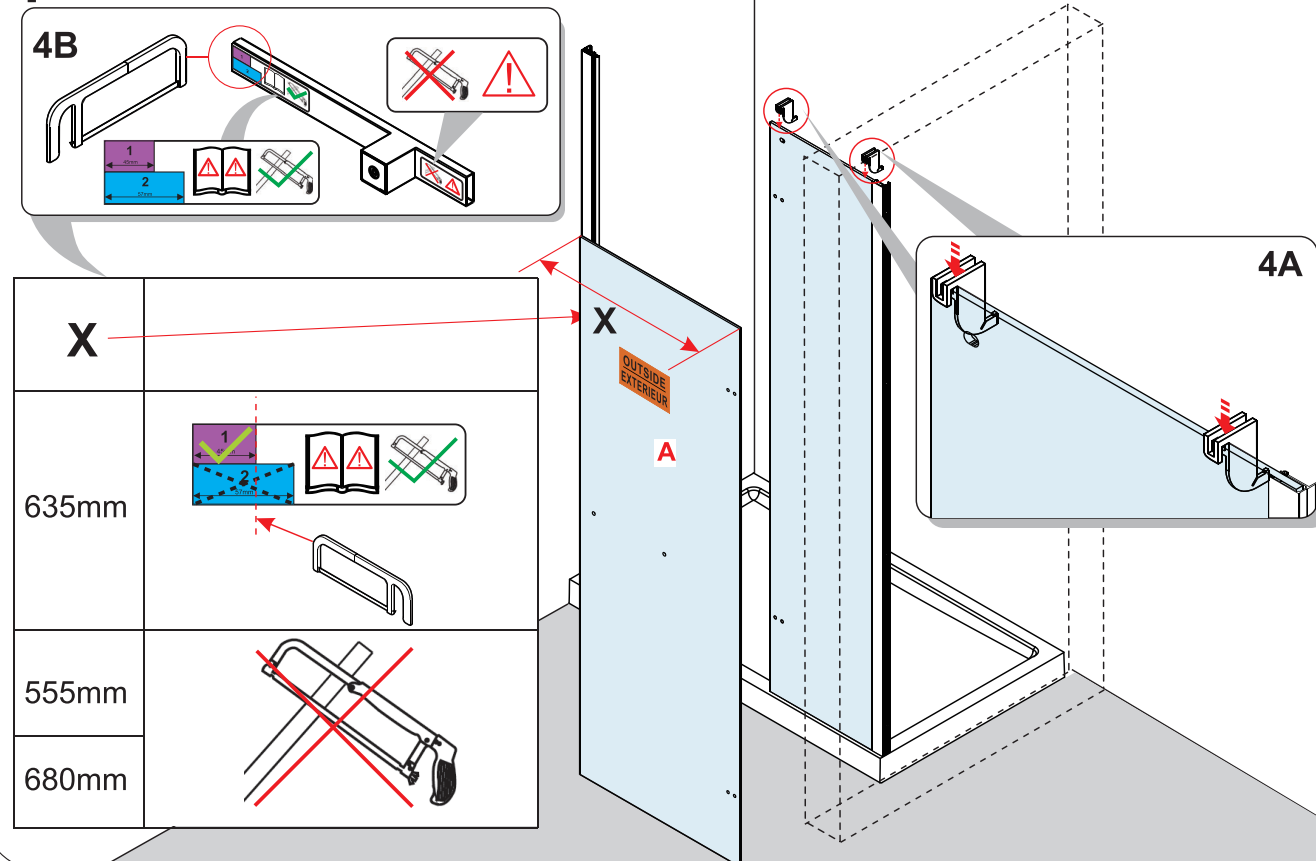

5

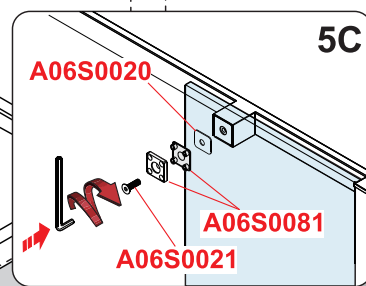
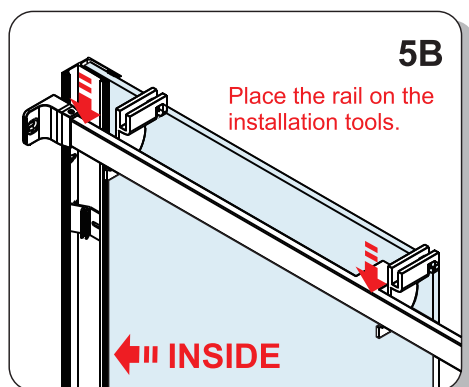
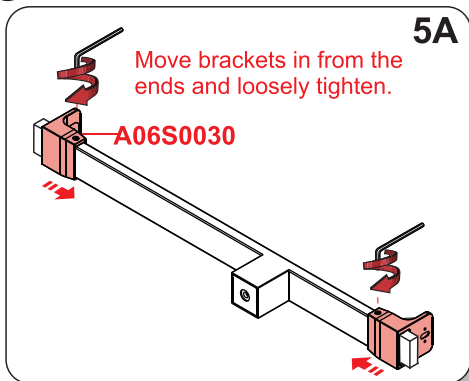

6

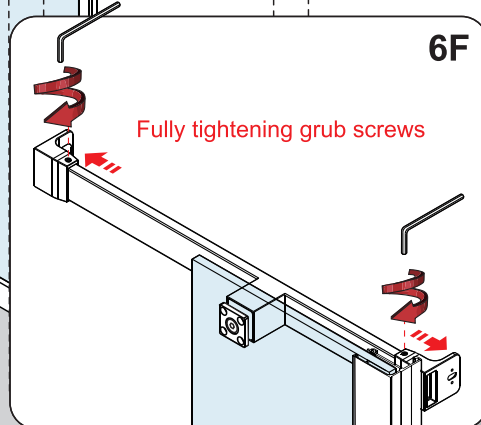
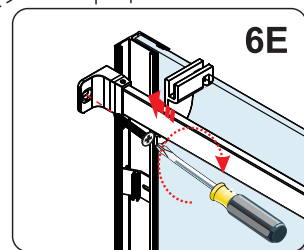
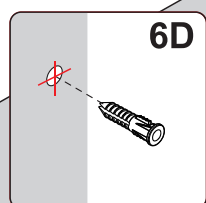
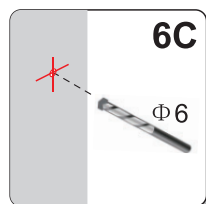
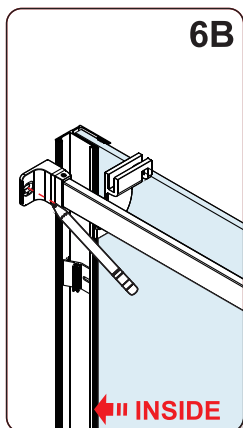
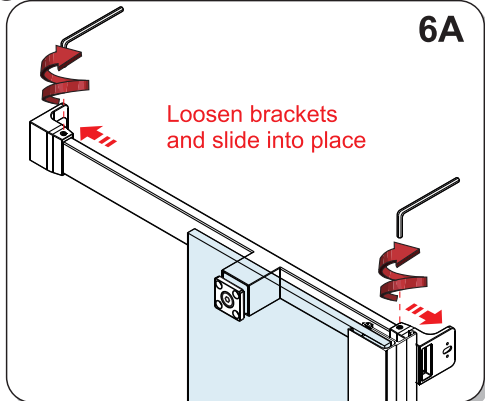

7

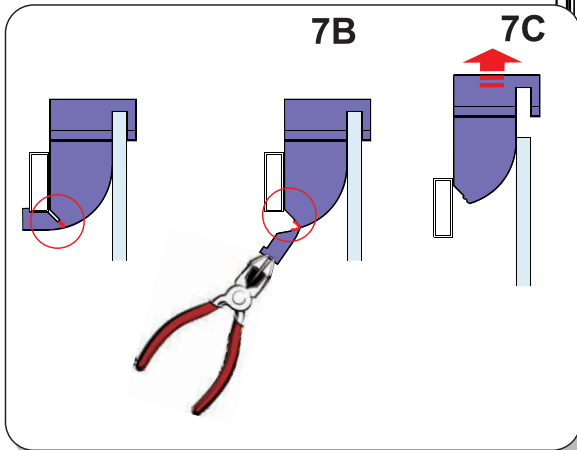
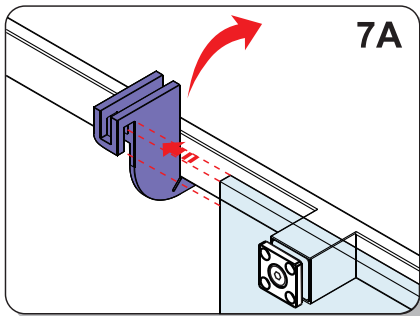

Insert wedge gasket 100mm  
on the bottom to hold the fixed  
panel in position

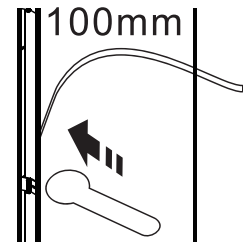

8

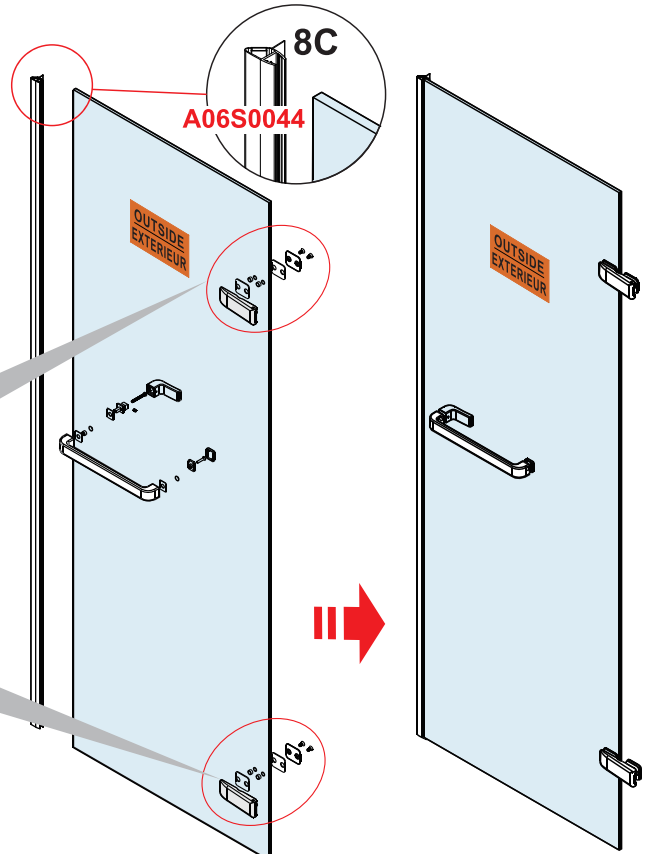
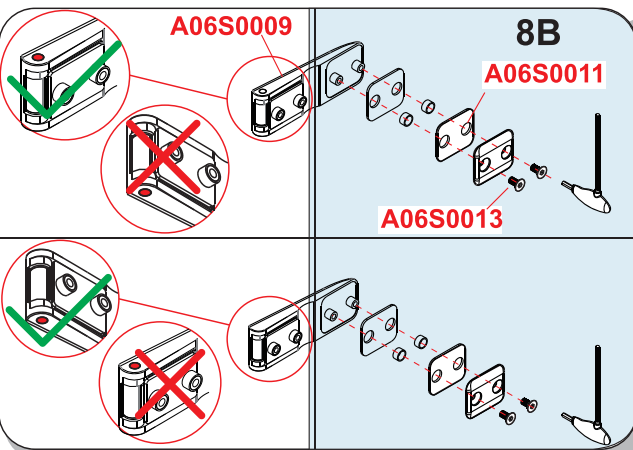
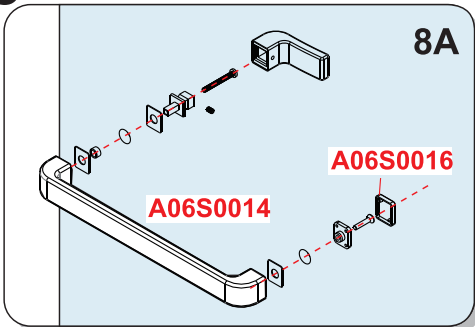



9

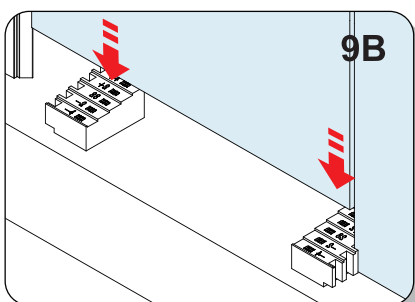
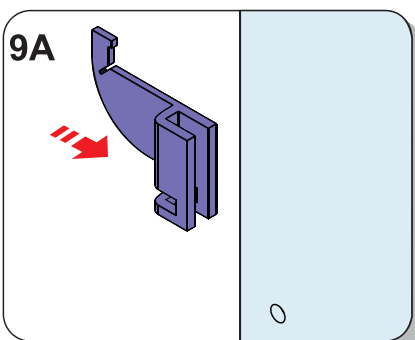

Place all parts and tools required for step 10 inside the enclosure before proceeding.

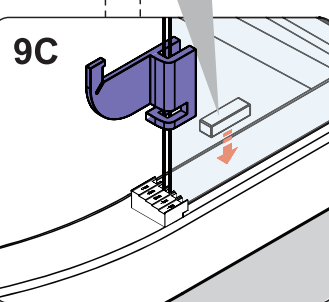
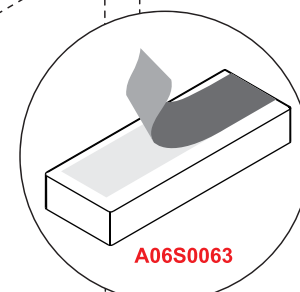

10

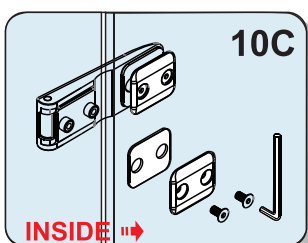
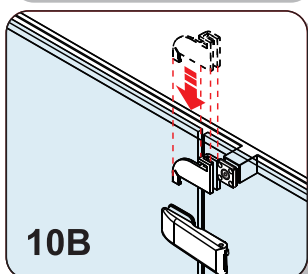
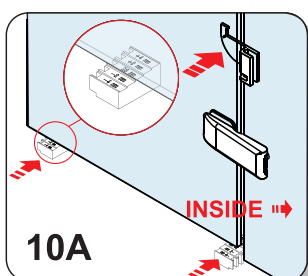

**10C:** Using only the Hex key provided fully tighten all hinge bolts to their absolute limit. Anything less than this could cause the door to drop over time.  
Note: Screws need to be tightened to the Max and it's normal to hear a 'clicking' noise.

Moving panel is fitted from the inside of the enclosure. Make sure to have all tools and parts required inside the enclosure

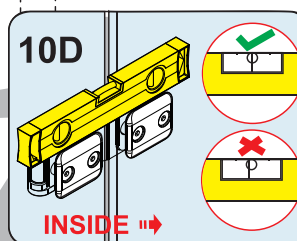

Wait 10 minutes then tighten all bolts a 2nd time. It is necessary to do this as the hinge gasket will compress slightly after the 1st tightening.

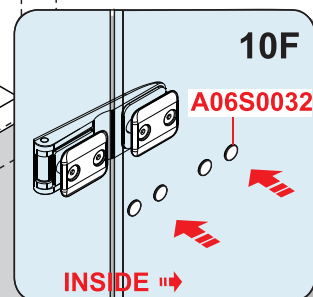

11

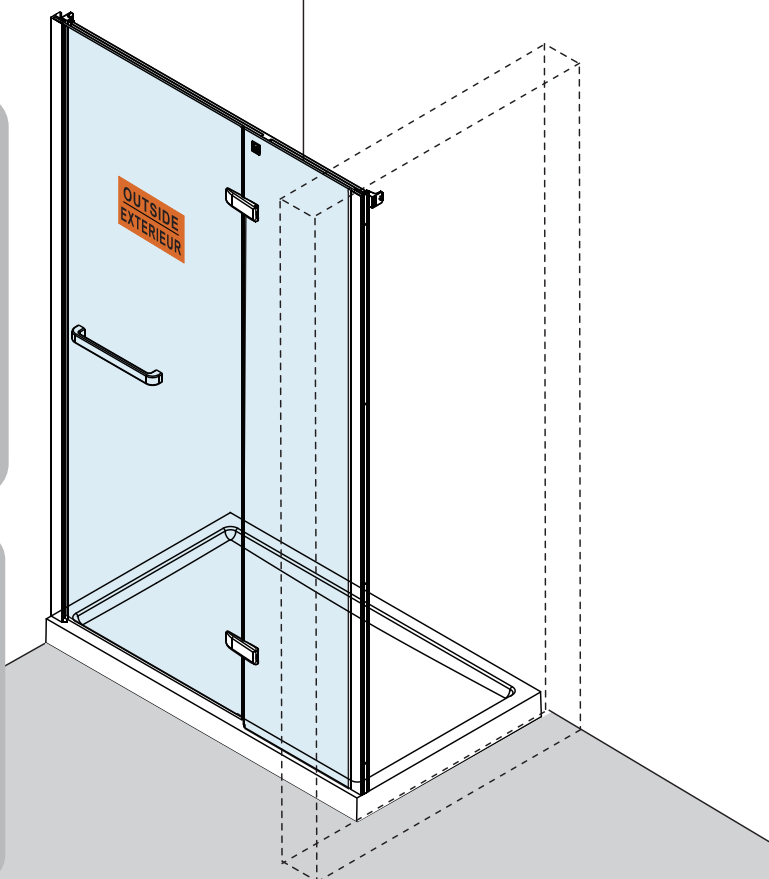
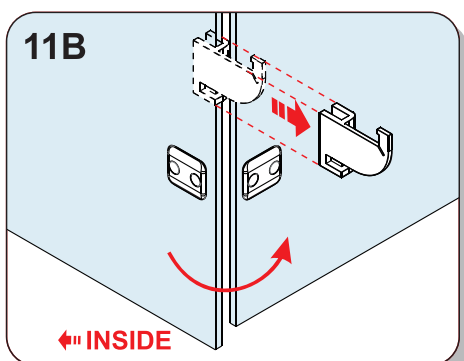
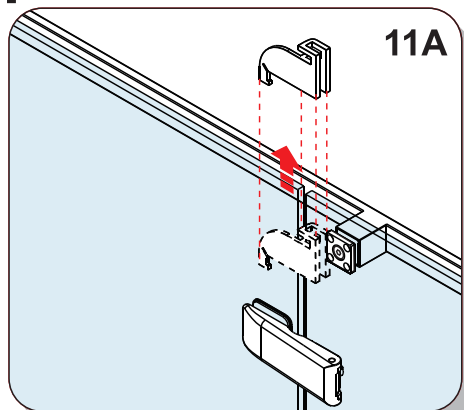

12

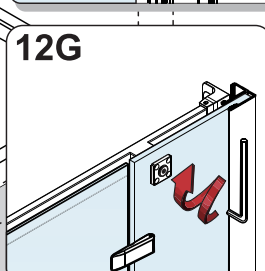
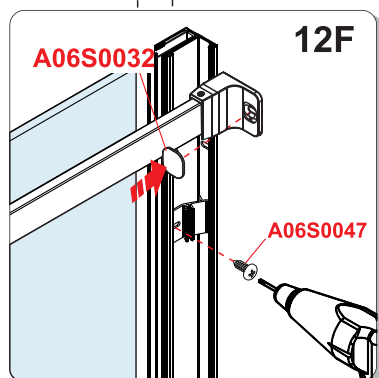
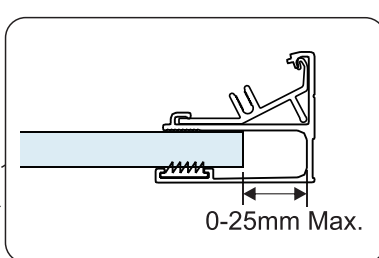
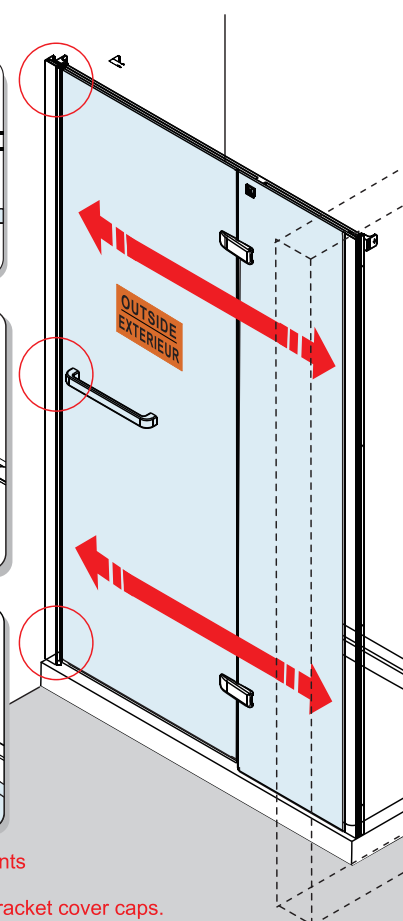
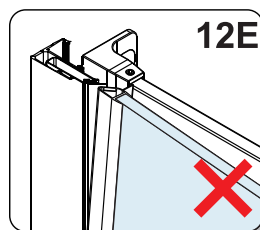
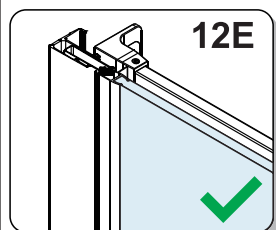
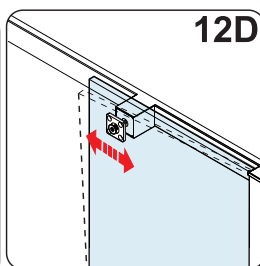
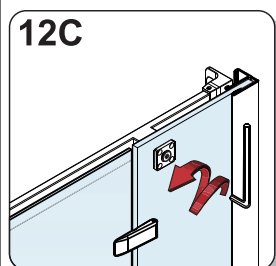
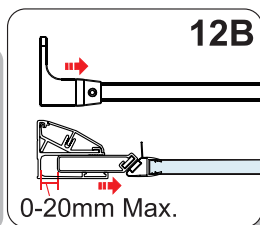
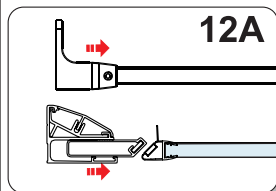

If necessary loosen all screws and make final adjustments to align the magnet seal with magnet profile.  
When seals are aligned fully tighten all screws and fit bracket cover caps.

## 13

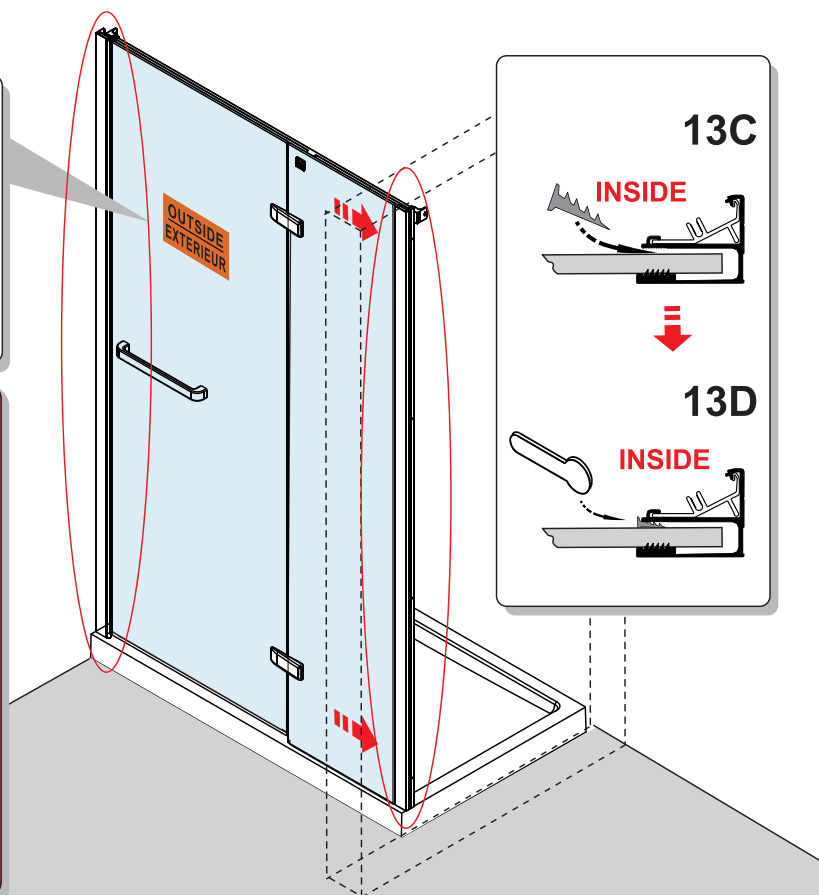
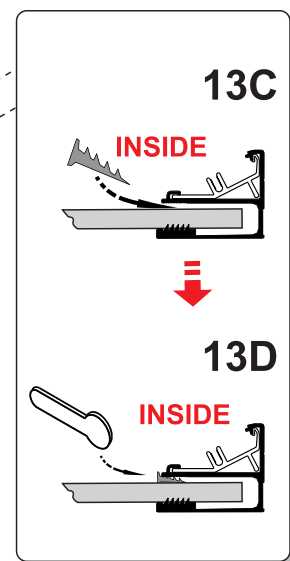
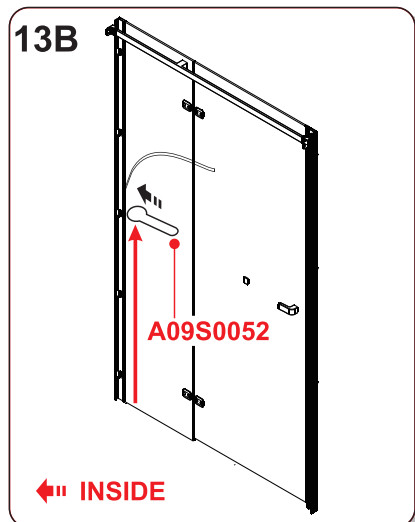
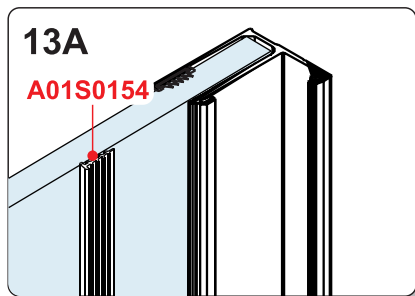

## 14

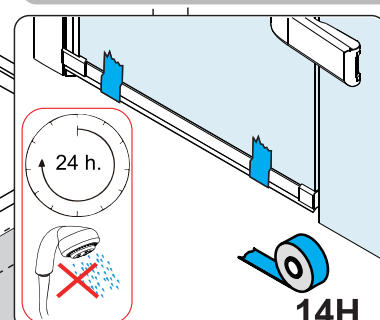
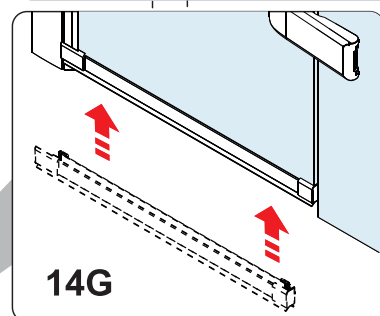
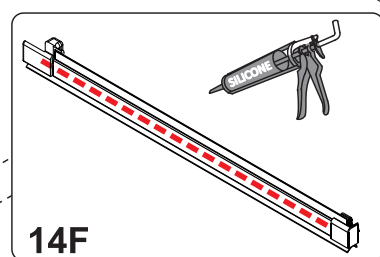
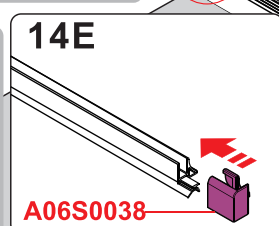
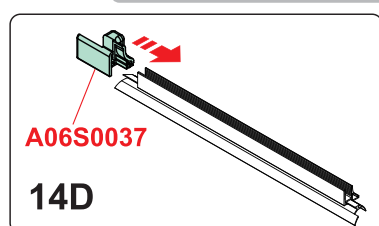
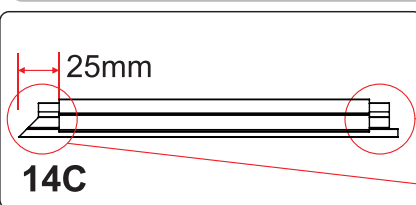
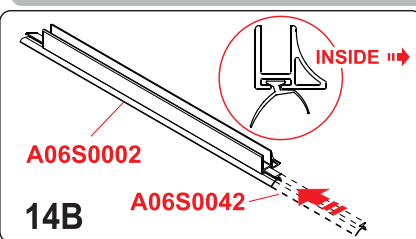
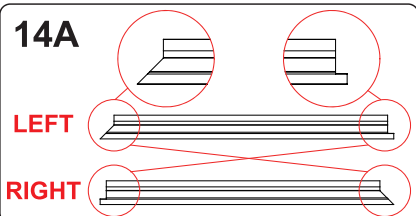

15

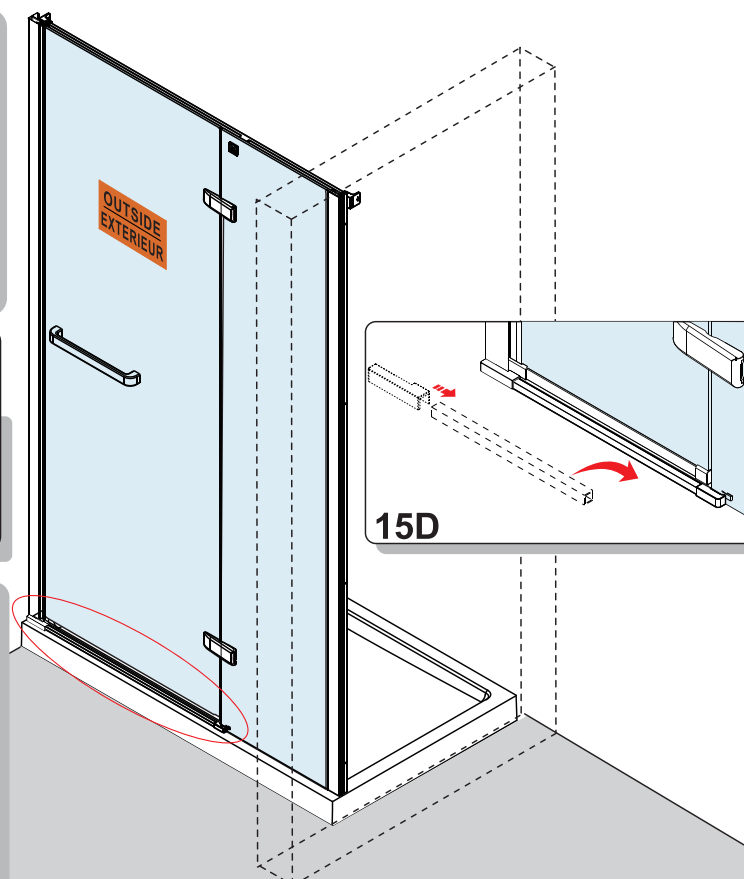
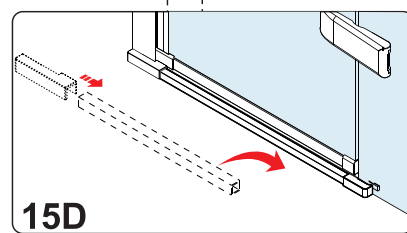
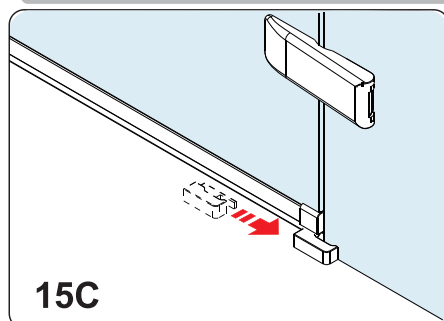
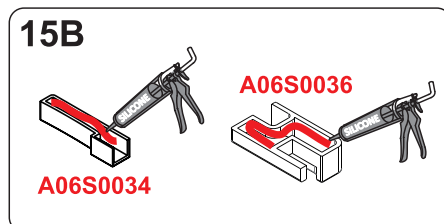
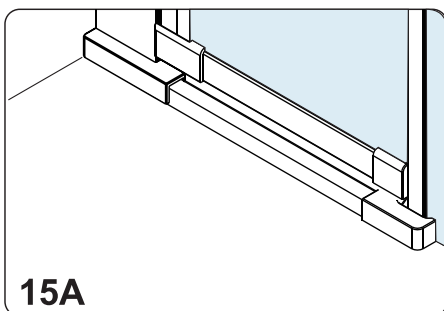

16

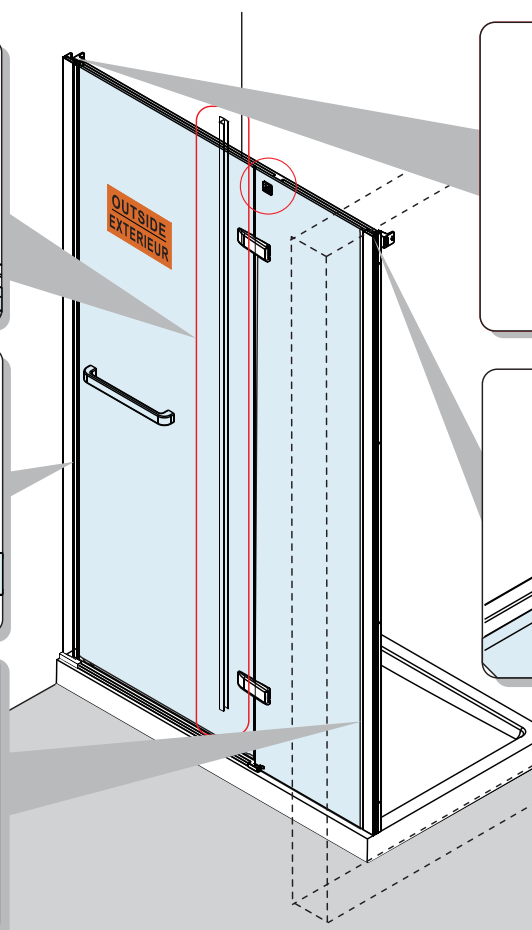
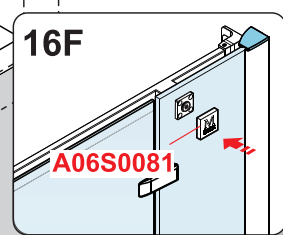
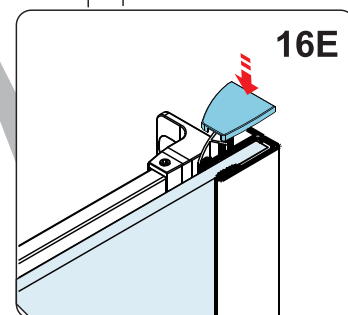
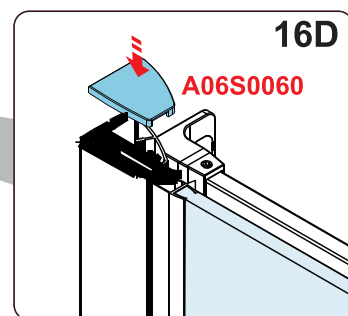
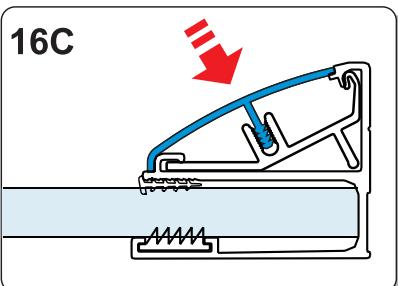
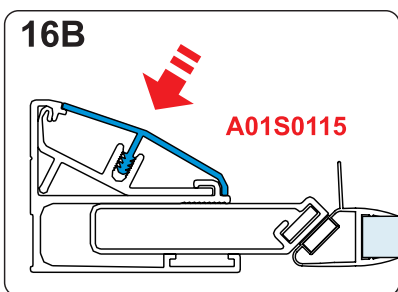
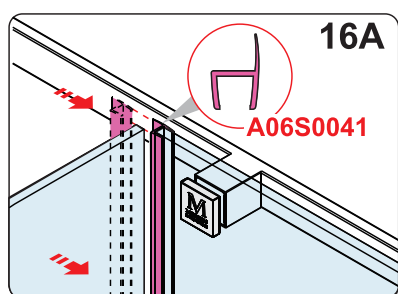

17

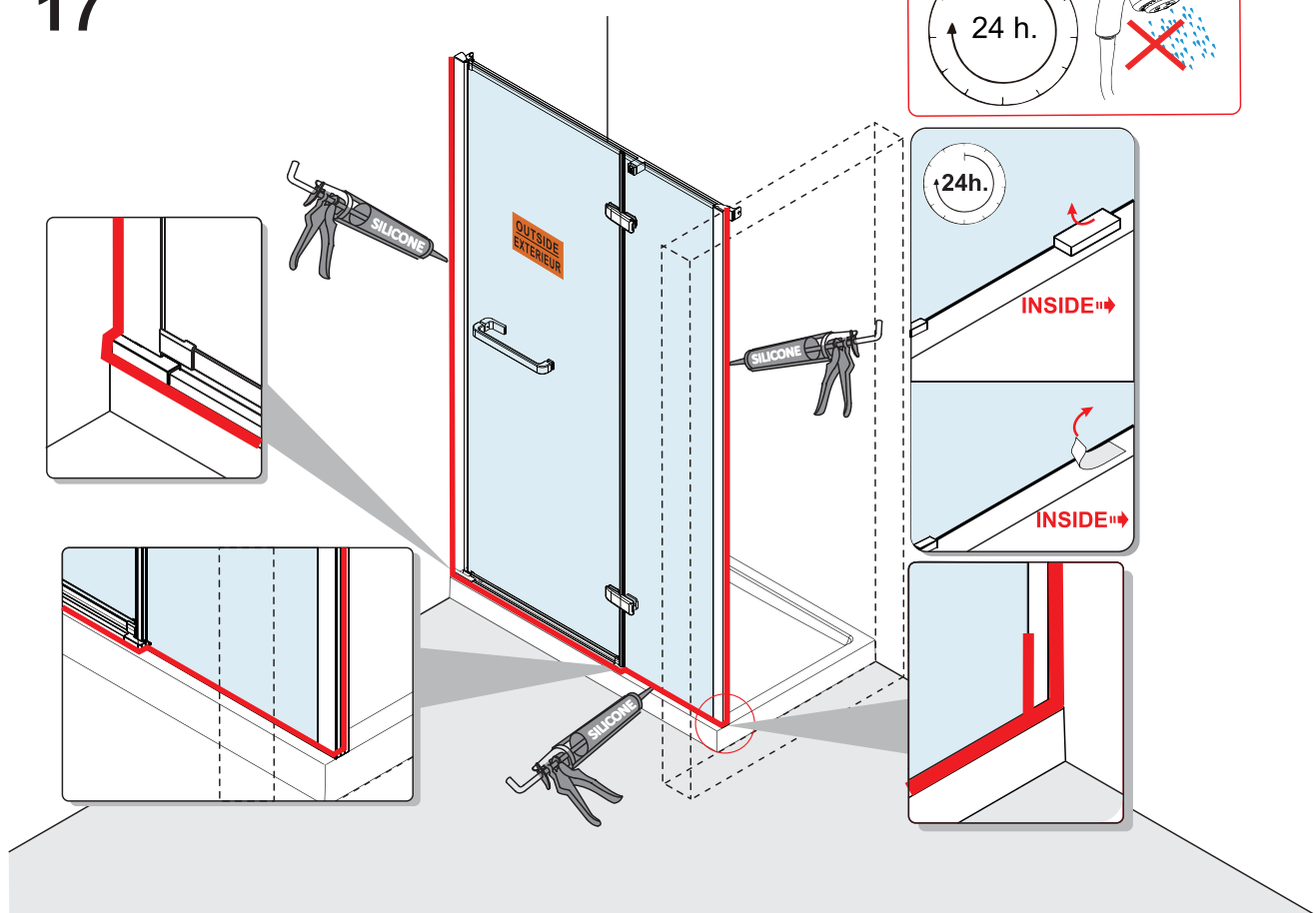

To download the Declaration of Performance (DOP) for this product please use the link below.

<https://merlynshowering.com/aftersales-support/dop-certs/>

For further information please contact IRL: 056 7791 555, UK: 08081011429